

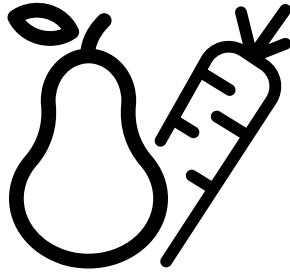

Refrigerator
User Manual
冰箱
冰箱用户手册



扫描二维码 **beko** 享品质服务



全国售后服务热线

400-828-5353



GN163121ZILX-GN163122IPS-GN163123IFX-GN163122ZIG-IM



EN/ZH

58 0053 0000/AL-EN/ZH

Description of the content of hazardous substances

After the service life of this product expires or this product is beyond repair, it shall not be discarded carelessly, but shall be submitted to the enterprise which has the qualification for disposal of discarded electric appliances. For the correct disposal methods, please refer to the national or local stipulations for the disposal of discarded electric appliances.

Attached: name and content of hazardous substance in the product

Name of component	Hazardous substance					
	Lead (Pb)	Mercury (Hg)	Cadmium (Cd)	Hexavalent chromium (CR(VI))	Polybrominated biphenyls (PBB)	Polybrominated diphenyl ethers (PBDE)
Lighting component	○	○	○	○	○	○
Box body	○	○	○	○	○	○
Condenser	○	○	○	○	○	○
Compressor	○	○	○	○	○	○
Power cord	○	○	○	○	○	○
Shelf	○	○	○	○	○	○
Door	○	○	○	○	○	○
Main Control Panel	×	○	○	○	○	○
Display component	×	○	○	○	○	○
Fan component	○	○	○	○	○	○
Harness component	○	○	○	○	○	○
Screw	○	○	○	○	○	○
<p>This table is prepared according to SJ/T-11364.</p> <p>○ means that the content of hazardous substance in all the homogeneous materials of this component is lower than the limit value required by GB/T 26572.</p> <p>× means that the content of hazardous substance in one kind of the homogeneous material of this component is higher than the limit value required by GB/T 26572.</p> <p>Due to technical reasons, the components marked with × cannot be replaced at present. With the progress of technology, they will be replaced or improved in the future.</p>						
 <p>In normal situation, the environment-friendly service life of this product is 15 years.</p>						

Please read this manual before using the product!

Dear Customer,

We'd like you to make the best use of our product, which has been manufactured in modern facilities with care and meticulous quality controls.

Thus, we advise you to read the entire user manual before you use the product. In case the product changes hands, do not forget to hand the guide to its new owner along with the product.

This guide will help you use the product quickly and safely.

- Please read the user guide carefully before installing and operating the product.
- Always observe the applicable safety instructions.
- Keep the user guide within easy reach for future use.
- Please read any other documents provided with the product.

Keep in mind that this user guide may apply to several product models. The guide clearly indicates any variations of different models.



	Important information and useful tips.
	Risk of life and property.
	Risk of electric shock.
	The product's packaging is made of recyclable materials, in accordance with the National Environment Legislation.

Table of Contents

1. Safety and environment instructions 3

- 1.1. General safety 3
- 1.1.1 HC warning 5
- 1.1.2 For models with water dispenser 5
- 1.2. Intended use 5
- 1.3. Child safety 6
- 1.4. Compliance with WEEE Directive and
Disposing of the Waste Product 6
- 1.5. Compliance with RoHS Directive 6
- 1.6. Package information 6

2 Refrigerator 7

2 Refrigerator 8

3 Installation 9

- 3.1. Right place for installation 9
- 3.2. Attaching the plastic wedges 9
- 3.3. Adjusting the stands 10
- 3.4. Power connection 10
- 3.5. Water connection 11
- 3.6. Connecting water hose to the product 12
- 3.7. Connecting to water mains 12
- 3.8. For products using water carboy 13
- 3.9 Water filter 13
- 3.9.1. Fixing external filter on the wall (Optional) 14
- 3.9.2. Internal filter 15

4 Preparation 17

- 4.1. What to do for energy saving 17
- 4.2. First Use 17

5 Using the product 18

- 5.1. Indicator panel 18
- 5.2. Activating water filter change warning . . . 29
- 5.3. Humidity controlled crisper 31
- 5.4. Deodorising Module 31
(FreshGuard) 31
- 5.5. Using the water fountain 32
- 5.6. Filling the fountain water tank 32
- 5.7. Cleaning the water tank 33
- 5.8. Taking ice / water 34
- 5.9. Drip tray 34
- 5.10. Zero degree compartment 35
- 5.11. Vegetable bin 35
- 5.12. Blue light 35
- 5.13. Ionizer 35
- 5.14. Minibar 35
- 5.15. Odour filter 35
- 5.16. Icematic and ice storage box 36
- 5.17. Ice-maker 36
- 5.18. Freezing fresh food 38
- 5.19. Recommendations for storing frozen foods 38
- 5.20. Deep freezer details 38
- 5.21. Placing the food 39
- 5.22. Door open alert 39
- 5.23. Interior light 39

6. Maintenance and cleaning 40





- 6.1 Avoiding bad odours 40
- 6.2 Protecting the plastic surfaces 40

7. Troubleshooting 41

1 Safety and environment instructions

This section provides the safety instructions necessary to prevent the risk of injury and material damage. Failure to observe these instructions will invalidate all types of product warranty.

Intended use

	WARNING: Keep ventilation openings, in the appliance enclosure or in the built-in structure, clear of obstruction.
	WARNING: Do not use mechanical devices or other means to accelerate the defrosting process, other than those recommended by the manufacturer.
	WARNING: Do not damage the refrigerant circuit.
	WARNING: Do not use electrical appliances inside the food storage compartments of the appliance, unless they are of the type recommended by the manufacturer.

This appliance is intended to be used in household and similar applications such as

- staff kitchen areas in shops, offices and other working environments;
- farm houses and by clients in hotels, motels and other residential type environments;
- bed and breakfast type environments;
- catering and similar non-retail applications.

1.1. General safety

- This product should not be used by persons with physical, sensory and mental disabilities, without sufficient knowledge and experience or by children. The device can only be used by such persons under supervision and instruction of a person responsible for their safety. Children should not be allowed to play with this device.
- In case of malfunction, unplug the device.
- After unplugging, wait at least 5 minutes before plugging in again.
- Unplug the product when not in use.
- Do not touch the plug with wet hands! Do not pull the cable to plug off, always hold the plug.
- Do not plug in the refrigerator if the socket is loose.

Safety and environment instructions

- Unplug the product during installation, maintenance, cleaning and repair.
- If the product will not be used for a while, unplug the product and remove any food inside.
- Do not use the product when the compartment with circuit cards located on the upper back part of the product (electrical card box cover) (1) is open.

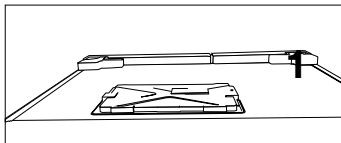
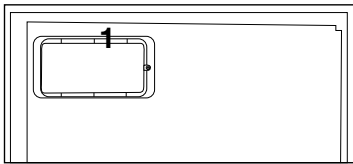

- Do not use steam or steamed cleaning materials for cleaning the refrigerator and melting the ice inside. Steam may contact the electrified areas and cause short circuit or electric shock!
 - Do not wash the product by spraying or pouring water on it! Danger of electric shock!
 - In case of malfunction, do not use the product, as it may cause electric shock. Contact the authorised service before doing anything.
- Plug the product into an earthed socket. Earthing must be done by a qualified electrician.
 - If the product has LED type lighting, contact the authorised service for replacing or in case of any problem.
 - Do not touch frozen food with wet hands! It may adhere to your hands!
 - Do not place liquids in bottles and cans into the freezer compartment. They may explode.
 - Place liquids in upright position after tightly closing the lid.
 - Do not spray flammable substances near the product, as it may burn or explode.
 - Do not keep flammable materials and products with flammable gas (sprays, etc.) in the refrigerator.
 - Do not place containers holding liquids on top of the product. Splashing water on an electrified part may cause electric shock and risk of fire.
 - Exposing the product to rain, snow, sunlight and wind will cause electrical danger. When relocating the product, do not pull by holding the door handle. The handle may come off.

Safety and environment instructions

- Take care to avoid trapping any part of your hands or body in any of the moving parts inside the product.
- Do not step or lean on the door, drawers and similar parts of the refrigerator. This will cause the product to fall down and cause damage to the parts.
- Take care not to trap the power cable.

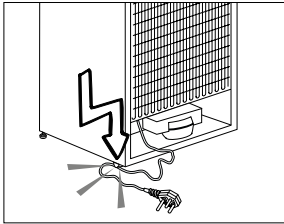

1.1.1 HC warning

If the product comprises a cooling system using R600a gas, take care to avoid damaging the cooling system and its pipe while using and moving the product. This gas is flammable. If the cooling system is damaged, keep the product away from sources of fire and ventilate the room immediately.



The label on the inner left side indicates the type of gas used in the product.

1.1.2 For models with water dispenser

- Pressure for cold water inlet shall be maximum 90 psi (6.2 bar). If your water pressure exceeds 80 psi (5.5 bar), use a pressure limiting valve in your mains system. If you do not know how to check your water pressure, ask for the help of a professional plumber.
- If there is risk of water hammer effect in your installation, always use a water hammer prevention equipment in your installation. Consult Professional plumbers if you are not sure that there is no water hammer effect in your installation.
- Do not install on the hot water inlet. Take precautions against of the risk of freezing of the hoses. Water temperature operating interval shall be 33°F (0.6°C) minimum and 100°F (38°C) maximum.
- Use drinking water only.

1.2. Intended use

- This product is designed for home use. It is not intended for commercial use.

Safety and environment instructions

- The product should be used to store food and beverages only.
- Do not keep sensitive products requiring controlled temperatures (vaccines, heat sensitive medication, medical supplies, etc.) in the refrigerator.
- The manufacturer assumes no responsibility for any damage due to misuse or mishandling.

1.3. Child safety

- Keep packaging materials out of children's reach.
- Do not allow the children to play with the product.
- If the product's door comprises a lock, keep the key out of children's reach.

1.4. Compliance with WEEE Directive and Disposing of the Waste Product

This product complies with EU WEEE Directive (2012/19/EU). This product bears a classification symbol for waste electrical and electronic equipment (WEEE).



This product has been manufactured with high quality parts and materials which can be reused and are suitable for recycling. Do not dispose of the waste product with normal domestic and other wastes at the end of its service life. Take it to the collection

center for the recycling of electrical and electronic equipment. Please consult your local authorities to learn about these collection centers.

1.5. Compliance with RoHS Directive

- This product complies with EU WEEE Directive (2011/65/EU). It does not contain harmful and prohibited materials specified in the Directive.

1.6. Package information

- Packaging materials of the product are manufactured from recyclable materials in accordance with our National Environment Regulations. Do not dispose of the packaging materials together with the domestic or other wastes. Take them to the packaging material collection points designated by the local authorities.

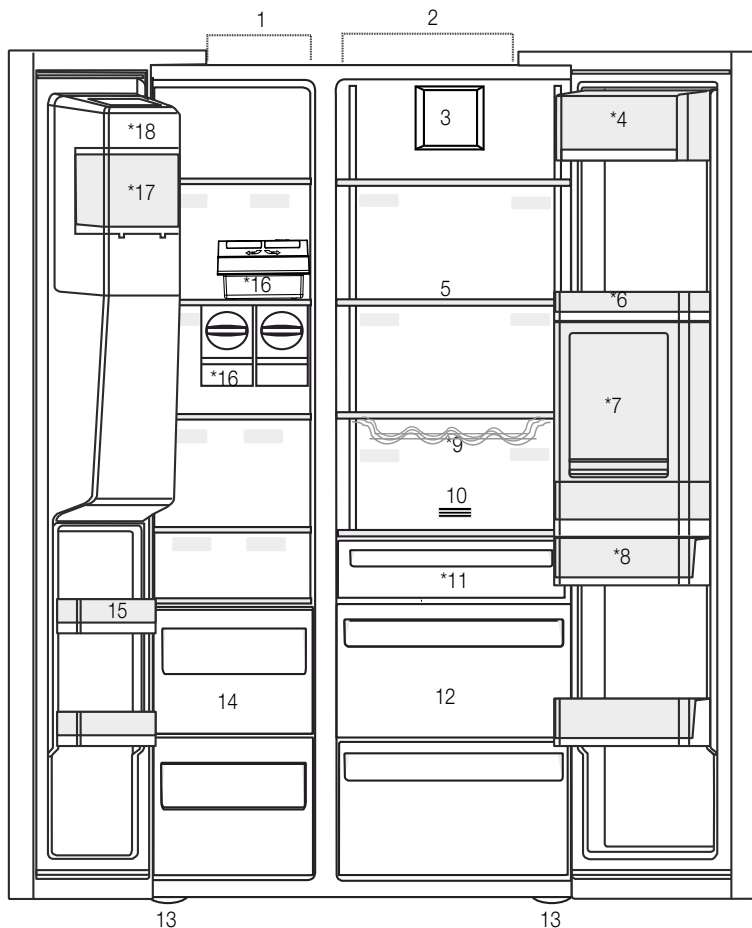

- | | |
|---|---|
| 1- Freezer compartment | 10- Odour filter |
| 2- Cooler compartment | 11- Zero degree compartment |
| 3- Fan | 12- Vegetable bins |
| 4- Butter-cheese compartment | 13- Adjustable stands |
| 5- Glass shelves | 14- Frozen food storing compartments |
| 6- Cooler compartment door shelves | 15- Freezer compartment door shelves |
| 7- Minibar accessory | 16- Icematics |
| 8- Water tank | 17- Ice storage box |
| 9- Bottle holder | 18- Ice-maker decorative lid |
| | *Optional |



*Optional: Figures in this user guide are schematic and may not be exactly match your product. If your product does not comprise the relevant parts, the information pertains to other models.

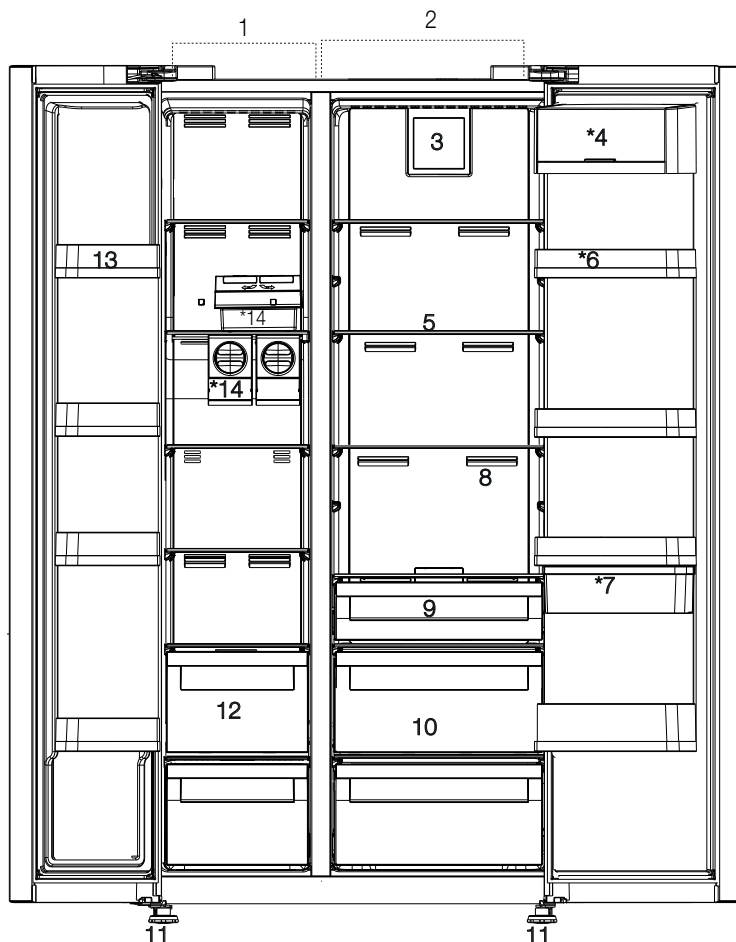

- 1- Freezer compartment
 - 2- Cooler compartment
 - 3- Fan
 - 4- Butter-cheese compartment
 - 5- Glass shelves
 - 6- Cooler compartment door shelves
 - 7- Bottle holder
 - 8- Odour filter
 - 9- Zero degree compartment
 - 10- Vegetable bins
 - 11- Adjustable stands
 - 12- Frozen food storing compartments
 - 13- Freezer compartment door shelves
 - 14- Icematics
- *Optional



*Optional: Figures in this user guide are schematic and may not be exactly match your product. If your product does not comprise the relevant parts, the information pertains to other models.

3.1. Right place for installation

Contact the Authorized Service for the product's installation. To ready the product for installation, see the information in the user guide and make sure the electric and water utilities are as required. If not, call an electrician and plumber to arrange the utilities as necessary.



WARNING: The manufacturer assumes no responsibility for any damage caused by the work carried out by unauthorized persons.



WARNING: The product's power cable must be unplugged during installation. Failure to do so may result in death or serious injuries!



WARNING: If the door span is too narrow for the product to pass, remove the door and turn the product sideways; if this does not work, contact the authorized service.

- Place the product on a flat surface to avoid vibration.
- Place the product at least 30 cm away from the heater, stove and similar sources of heat and at least 5 cm away from electric ovens.
- Do not expose the product to direct sunlight or keep in damp environments.
- The product requires adequate air circulation to function efficiently. If the product will be placed in an alcove, remember to leave at least 5 cm distance between the product and the ceiling and the walls.
- Do not install the product in environments with temperatures below -5°C .

3.2. Attaching the plastic wedges

Use the plastic wedges in the provided with the product to provide sufficient space for air circulation between the product and the wall.

1. To attach the wedges, remove the screws on the product and use the screws provided with the wedges.

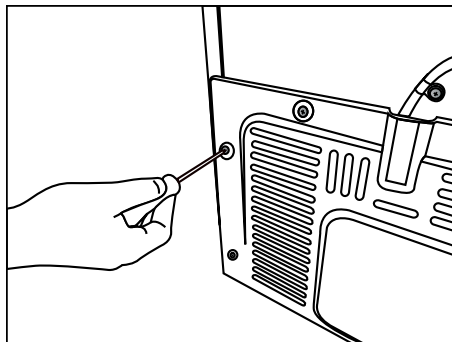

2. Attach 2 plastic wedges on the ventilation cover shown as j in the figure.

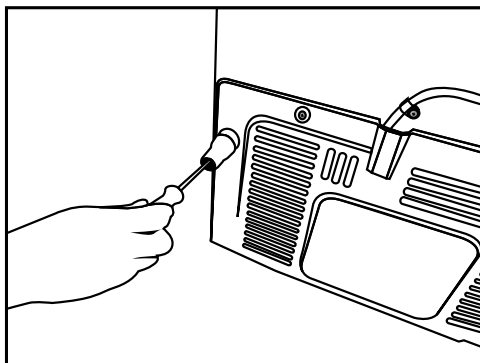

Installation

3.3. Adjusting the stands

If the product is not in balanced position, adjust the front adjustable stands by rotating right or left.

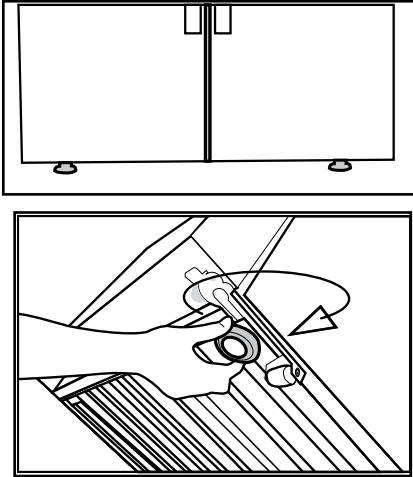

In order to adjust the doors vertically,

- Loosen the fixing nut at the bottom
- Screw adjusting nut (CW/CCW) according to the position of the door
- Tighten the fixing nut for the final position

In order to adjust the doors horizontally,

- Loosen the fixing bolt on the top
- Screw the adjusting bolt (CW/CCW) on the side according to the position of the door
- Tighten the fixing bolt on the top for the final position

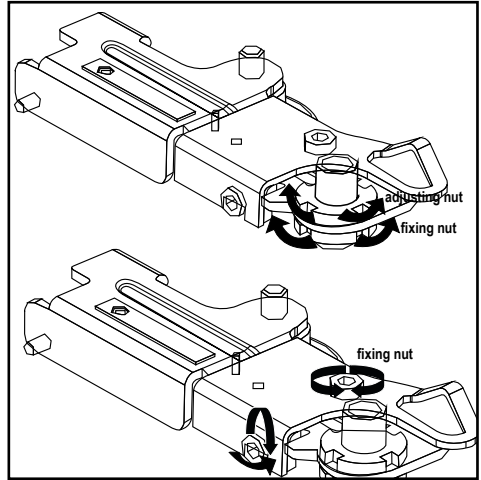

3.4. Power connection



WARNING: Do not use extension or multi sockets in power connection.



WARNING: Damaged power cable must be replaced by Authorized Service.



When placing two coolers in adjacent position, leave at least 4 cm distance between the two units.

- Our firm will not assume responsibility for any damages due to usage without earthing and power connection in compliance with national regulations.
- The power cable plug must be easily accessible after installation.
- Do not use multi-group plug with or without extension cable between the wall socket and the refrigerator.

Installation

3.5. Water connection

(Optional)



WARNING: Unplug the product and the water pump (if available) during connection.

The product's water mains, filter and carboy connections must be rendered by authorizer service. The product can be connected to a carboy or directly to the water mains, depending on the model. To establish the connection, the water hose must first be connected to the product.

Check to see the following parts are supplied with your product's model:

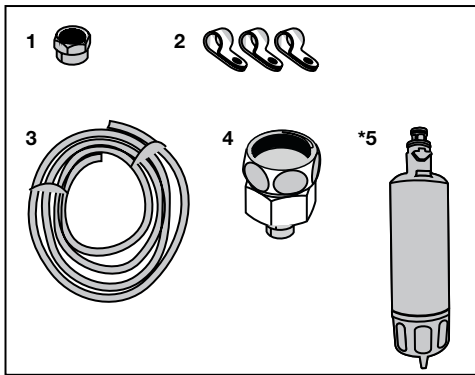

- 1.** Connector (1 piece): Used to attach the water hose to the rear of the product.
- 2.** Hose clip (3 pieces): Used to fix the water hose on the wall.
- 3.** Water hose (1 piece, 5 meter diameter 1/4 inches): Used for the water connection.
- 4.** Faucet adapter (1 piece): Comprises a porous filter, used for connection to the cold water mains.
- 5.** Water filter (1 piece *Optional): Used to connect the mains water to the product. Water filter is not required if carboy connection is available.

Installation

3.6. Connecting water hose to the product

To connect the water hose to the product, follow the instructions below.

1. Remove the connector on the hose nozzle adaptor in the back of the product and run the hose through the connector.

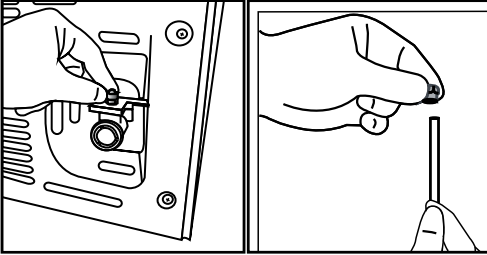

2. Push the water hose down tightly and connect to the hose nozzle adaptor.

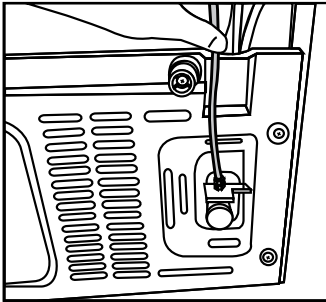

3. Tighten the connector manually to fix on the hose nozzle adaptor. You may also tighten the connector using a pipe wrench or pliers.

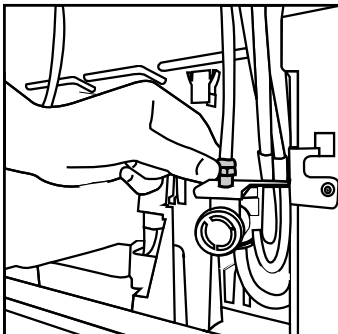

4. Connect the other end of the hose to the water mains (See Section 3.7) or, to use carboy, to the water pump (See Section 3.8).

3.7. Connecting to water mains (Optional)

To use the product by connecting to the cold water mains, a standard 1/2" valve connector must be installed to the cold water mains in your home. If the connector is not available or if you are unsure, consult a qualified plumber.

1. Detach the connector (1) from the faucet adaptor (2).

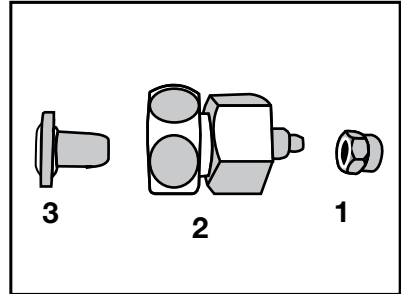

2. Connect the faucet adaptor to the water mains valve.

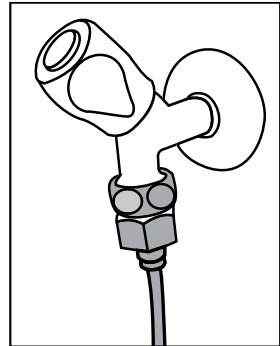

3. Attach the connector around the water hose.

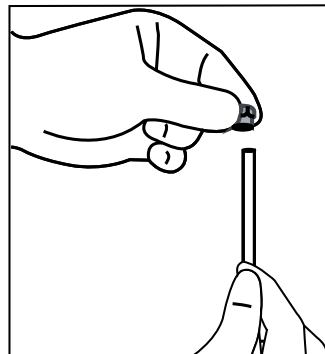

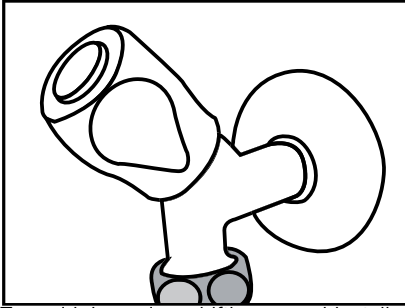

Installation

4. Attach the connector into the faucet adaptor and tighten by hand / tool.

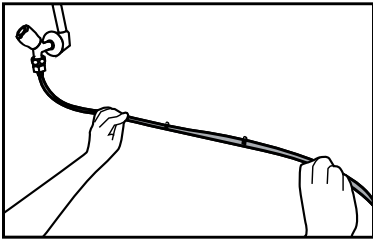

5. To avoid damaging, shifting or accidentally disconnecting the hose, use the clips provided to fix the water hose appropriately.



 **WARNING:** After turning the faucet on, make sure there is no water leak on either end of the water hose. In case of leakage, turn the valve off and tighten all connections using a pipe wrench or pliers.

3.8. For products using water carboy (Optional)

To use a carboy for the product's water connection, the water pump recommended by the authorized service must be used.

1. Connect one end of the water hose provided with the pump to the product (see 3.6) and follow the instructions below.

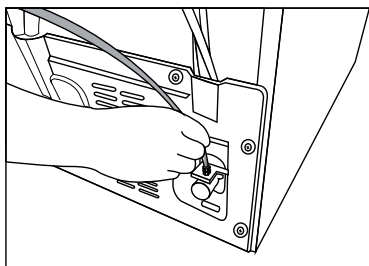

2. Connect the other end of the water hose to the water pump by pushing the hose into the pump's hose inlet.

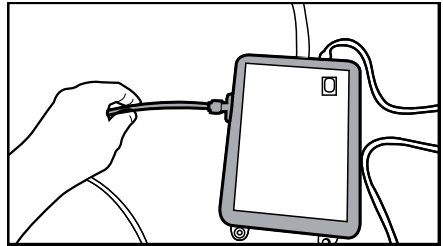

3. Place and fasten the pump hose inside the carboy.

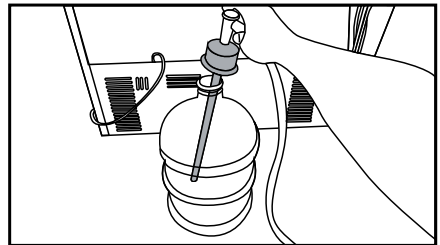

4. Once the connection is established, plug in and start the water pump.



Please wait 2-3 minutes after starting the pump to achieve the desired efficiency.



See also the pump's user guide for water connection.



When using carboy, water filter is not required.

3.9 Water filter (Optional)

The product may have internal or external filter, depending on the model. To attach the water filter, follow the instructions below.

Installation

3.9.1. Fixing external filter on the wall (Optional)



WARNING: Do not fix the filter on the product.

Check to see the following parts are supplied with your product's model:

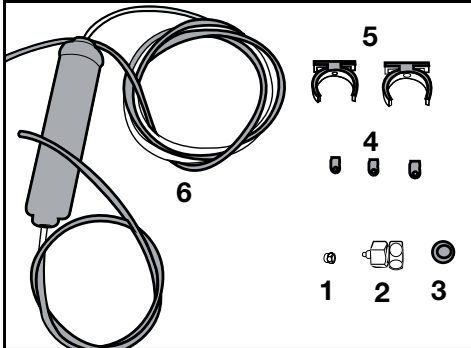

1. Connector (1 piece): Used to attach the water hose to the rear of the product.
 2. Faucet adaptor (1 piece): Used for connection to the cold water mains.
 3. Porous filter (1 piece)
 4. Hose clip (3 pieces): Used to fix the water hose on the wall.
 5. Filter connecting apparatus (2 pieces): Used to fix the filter on the wall.
 6. Water filter (1 piece): Used to connect the product to the water mains. Water filter is not necessary when using carboy connection.
1. Connect the faucet adaptor to the water mains valve.
 2. Determine the location to fix the external filter. Fix the filter's connecting apparatus (5) on the wall.
 3. Attach the filter in upright position on the filter connecting apparatus, as indicated on the label. (6)

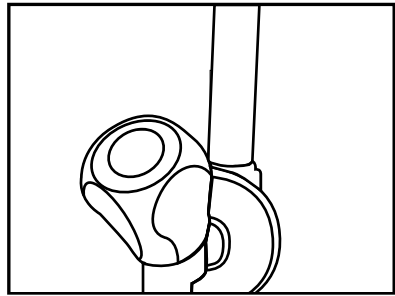

4. Attach the water hose extending from the top of the filter to the product's water connection adaptor, (see 3.6.)

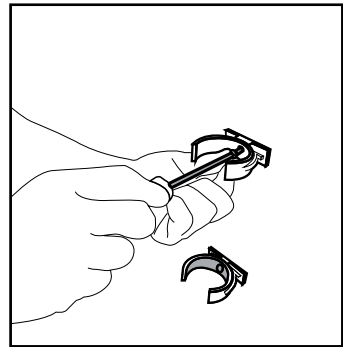

After the connection is established, it should look like the figure below.

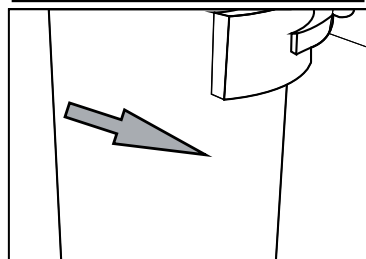
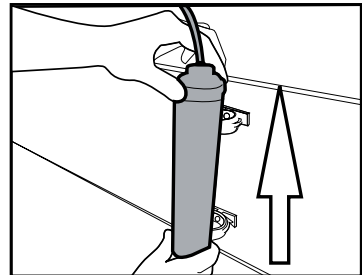

Installation

3.9.2. Internal filter

The internal filter provided with the product is not installed upon delivery; please follow the instructions below to install the filter.

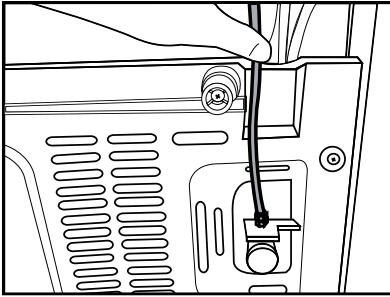

Water line:

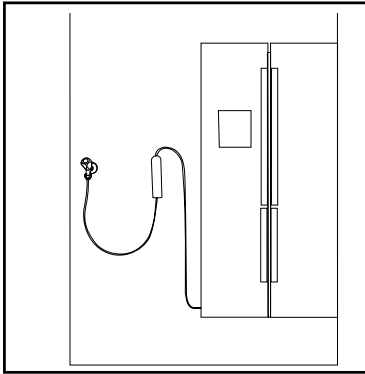

Carboy line:

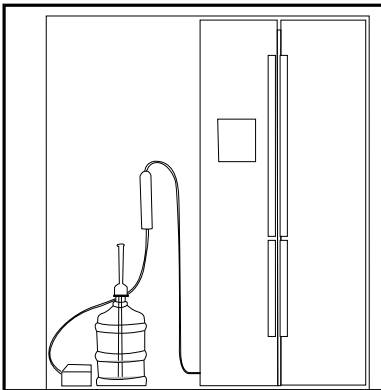

1. “Ice Off” indicator must be active while installing the filter. Switch the **ON-OFF** indicator using the “Ice” button on the screen.

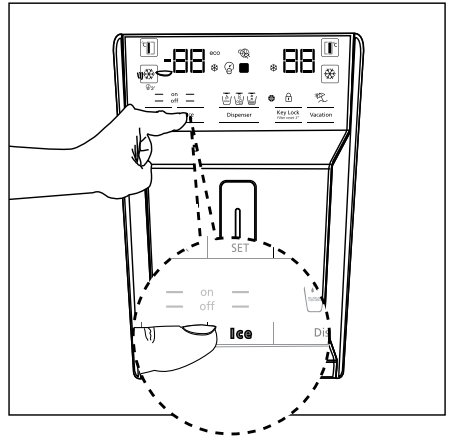

2. Remove the vegetable bin (a) to access the water filter.



Do not use the first 10 glasses of water after connecting the filter.

Installation

3. Remove the water filter by-pass cover by pulling.



A few drops of water may flow out after removing the cover; this is normal.

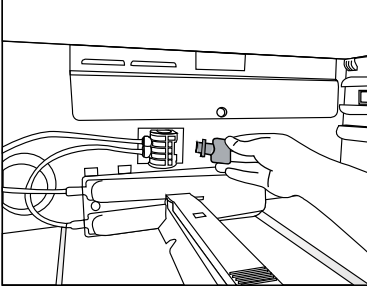

4. Place the water filter cover into the mechanism and push to lock in place.

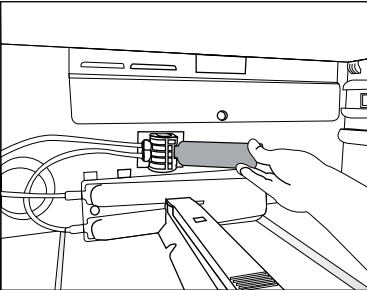

5. Push the **“Ice”** button on the screen again to cancel the **“Ice Off”** mode.



The water filter will clear certain foreign particles in the water. It will not clear the microorganisms in the water.



See section 5.2 for activating the filter replacing period.

4.1. What to do for energy saving



Connecting the product to electronic energy-saving systems is harmful, as it may damage the product.

- Do not keep the refrigerator doors open for long periods.
- Do not place hot food or beverages into the refrigerator.
- Do not overfill the refrigerator; blocking the internal air flow will reduce cooling capacity.
- The energy consumption value specified for the refrigerator was measured with the freezer compartment's upper shelf removed, other shelves and the lowest drawers in place and under maximum load. The top glass shelf can be used, depending on the shape and size of food to be frozen.
- Depending on the product's features; defrosting frozen foods in the cooler compartment will ensure energy saving and preserve food quality.
- The baskets/drawers that are provided with the chill compartment must always be in use for low energy consumption and for better storage conditions.
- Food contact with the temperature sensor in the freezer compartment may increase energy consumption of the appliance. Thus any contact with the sensor(s) must be avoided.

- Make sure the foods are not in contact with the cooler compartment temperature sensor described below.

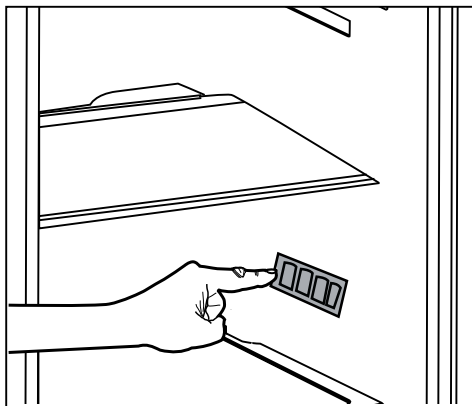

4.2. First Use

Before using your refrigerator, make sure the necessary preparations are made in line with the instructions in "Safety and environment instructions" and "Installation" sections.

- Keep the product running with no food inside for 6 hours and do not open the door, unless absolutely necessary.



A sound will be heard when the compressor is engaged. It is normal to hear sound even when the compressor is inactive, due to the compressed liquids and gasses in the cooling system.



It is normal for the front edges of the refrigerator to be warm. These areas are designed to warm up in order to prevent condensation.



In some models, the indicator panel automatically turns off 5 minutes after the door has closed. It will be reactivated when the door has opened or pressed on any key.

5.1. Indicator panel

Indicator panels may vary depending on the model of your product.

Audial and visual functions of the indicator panel will assist in using the refrigerator.

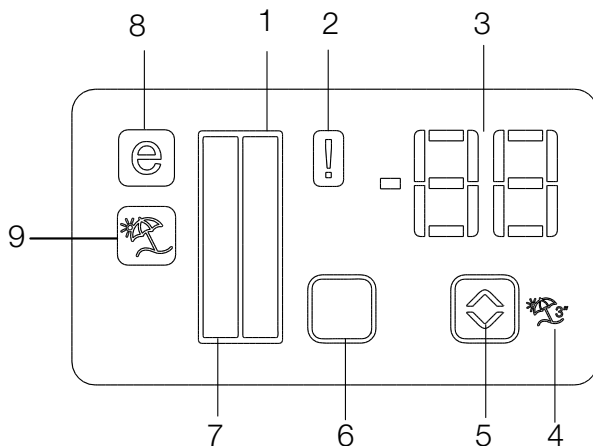

1. Cooler compartment indicator
2. Error status indicator
3. Temperature indicator
4. Vacation function button
5. Temperature adjustment button
6. Compartment selection button
7. Freezer Compartment indicator
8. Economy mode indicator
9. Vacation function indicator

***optional**



***Optional:** The figures in this user guide are intended as drafts and may not perfectly match your product. If your product does not comprise the relevant parts, the information pertains to other models.

Using the product

1. Cooler compartment indicator

The cooler compartment light will turn on when adjusting the cooler compartment temperature.

2. Error status indicator

This sensor will activate if the refrigerator is not cooling adequately or in case of sensor fault. When this indicator is active, the freezer compartment temperature indicator will display "E" and the cooler compartment temperature indicator will display "1, 2, 3..." etc. numbers. The numbers on the indicator serve to inform the service personnel about the fault.

3. Temperature indicator

Indicates the temperature of the freezer and cooler compartments.

4. Vacation function button

To activate this function, press and hold the Vacation button for 3 seconds. When the Vacation function is active, the cooler compartment temperature indicator displays the inscription "- -" and no cooling process will be active in the cooling compartment. This function is not suitable to keep food in the cooler compartment. Other compartments will remain cooled with the respective temperature set for each compartment.

Push the Vacation button () again to cancel this function.

5. Temperature adjustment button

Respective compartment's temperature varies in -24°C..... -18°C and 8°C...1°C ranges.

6. Compartment selection button

Use the refrigerator compartment selection button to toggle between the cooler and freezer compartments.

7. Freezer Compartment indicator

The freezer compartment light will turn on when adjusting the cooler compartment temperature.

8. Economy mode indicator





Indicates the refrigerator is running on energy-saving mode. This indicator will be active when the temperature in the freezer compartment is set to -18°C.

9. Vacation function indicator

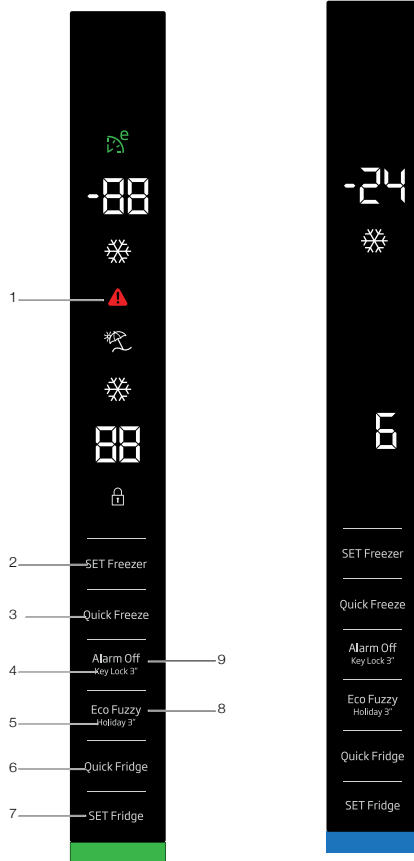
Indicates the vacation function is active.

Using the product



-  Green: Display Off / Eco Mode
-  Red: High Temperature / Door Open
-  Blue: Quick Freeze / Quick Fridge
-  White: interaction with product/
Display On after any interaction with buttons
-  Yellow: Vacation



***Optional:** The figures in this user guide are intended as drafts and may not perfectly match your product. If your product does not comprise the relevant parts, the information pertains to other models.

Using the product

- 1- Power failure/High temperature / error warning
- 2- Freezer compartment temperature setting
- 3- Quick freeze
- 4- Key lock
- 5- Vacation function
- 6- Quick Fridge
- 7- Fridge compartment temperature setting
- 8- Eco fuzzy
- 9- Alarm off warning

- High temperature alarm :RED (1 Hz flash)
 - Within 1 min. after the door is opened (when the door: open alarm is enabled) RED light becomes on.
 - When the door is opened : WHITE
 - Eco Mode : GREEN
 - Quick Freeze : BLUE
 - Quick Fridge : BLUE
 - Vacation : YELLOW
 - Display Off : GREEN
- After the door is closed, if one of the WHITE / Eco Mode, Quick Freeze, Quick Fridge, Vacation modes are active, the colour of these modes are displayed for 1 min. (The colour of the mode is more dominant than that of the display status).**

1. Power failure/High temperature / error warning

This indicator illuminates during power failure, high temperature failures and error warnings. During long-term power failures, the highest temperature value that the freezer compartment reaches will blink on the digital display. After checking the food located in the freezer compartment, press the alarm off button to clear the warning.

Please refer to "solutions recommended for troubleshooting" section on your manual if you observe that this indicator is illuminated.

2. Freezer compartment temperature setting

Temperature setting is made for freezer compartment. When this button is pressed, you can set the temperature of the freezer compartment to -18, -19, -20, -21, -22, -23 and -24.

3. Quick freeze

Press this button for quick freeze operation, the quick freeze indicator (❄️) will be activated.

Quick freeze indicator is lit when quick freeze function is on and fridge compartment temperature indicator displays -27. To cancel this function press the quick freeze button (❄️) again. Quick freeze indicator will turn off and refrigerator will reset to its normal settings. Quick freeze function is cancelled automatically in 24 hour if you do not cancel it. If you want to freeze large amounts of fresh food, press the quick freeze button before putting the food into the freezer compartment.

4. Key lock

Press and hold the alarm off button for 3 seconds. The key lock symbol will be on and key lock will be activated; When the Key Lock is on, the buttons are disabled. Press and hold the alarm off button for 3 seconds again. The key lock symbol will be off and the key lock mode will be disabled.

5. Vacation function

In order to activate the vacation function, press and hold the fuzzy button for 3 seconds; the vacation mode indicator (☂️) will be activated. When the vacation function is activated, "- -" is displayed on the fridge compartment temperature indicator and no active cooling operation will be performed on the fridge compartment. It is not suitable to keep the food in the fridge compartment in this function. Other compartments will continue to be cooled according to their set temperatures.

To cancel this function, press the **Vacation function** button again.

Using the product

6. Quick fridge

Quick fridge indicator is lit (❄️) and the fridge compartment temperature indicator value is displayed as 1 when the quick fridge function is activated. To cancel this function, press the Quick fridge button again. Quick fridge indicator will be off and the refrigerator will be reset to its normal settings. Quick fridge function is cancelled automatically in 1 hour if you do not cancel it. If you want to cool large amounts of fresh food, press the Quick fridge button before putting the food into the fridge compartment.

7. Fridge compartment temperature setting

When this button is pressed the fridge compartment temperature can be set to 8,7,6,5,4,3,2 and 1 values.

8. Eco fuzzy

Press and hold the eco fuzzy button for 1 seconds to activate the eco fuzzy function. Refrigerator will start operating in the most economic mode at least 6 hours later and the economic usage indicator will be on (🌿). Press and hold the eco fuzzy function button for 3 seconds to disable the eco fuzzy function.

This indicator will be on after 6 hours when eco fuzzy is activated.

9. Alarm off warning

In case of power failure/high temperature alarm, after checking the foods in the freezer compartment, press the alarm off button to clear the warning.

Using the product

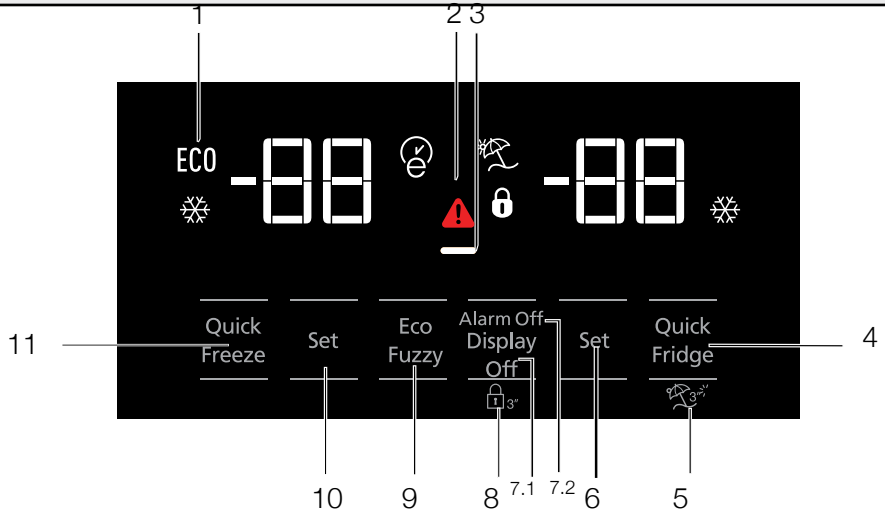

1. Economic use
- 2- High temperature / fault alert
3. Energy saving function (display off)
- 4- Rapid cooling
- 5- Vacation function
- 6- Cooler compartment temperature setting
7. Energy saving (display off) /Alarm off
- 8- Keypad lock
- 9- Eco-fuzzy
- 10- Freezer compartment temperature setting
- 11- Rapid freezing



***Optional:** The figures in this user guide are intended as drafts and may not perfectly match your product. If your product does not comprise the relevant parts, the information pertains to other models.

Using the product

1. Economic use

This sign will light up when the freezer compartment is set to -18°C , the most economical setting. (ECO) Economic use indicator will turn off when rapid cooling or rapid freezing function is selected.

2. Power failure/High temperature / error warning indicator

This indicator () will light up in case of temperature faults or fault alerts. This indicator illuminates during power failure, high temperature failures and error warnings. During sustained power failures, the highest temperature that the freezer compartment reaches will flash on the digital display. After checking the food located in the freezer compartment press the alarm off button to clear the warning.

3. Energy saving function (display off)



If the product doors are kept closed for a long time energy saving function is automatically activated and energy saving symbol is illuminated. When energy saving function is activated, all symbols on the display other than energy saving symbol will turn off. When the Energy Saving function is activated, if any button is pressed or the door is opened, energy saving function will be cancelled and the symbols on display will return to normal.

Energy saving function is activated during delivery from factory and cannot be cancelled.

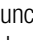

4. Rapid cooling

When the rapid cooling function is turned on, the rapid cool indicator will light up () and the cooler compartment temperature indicator will display the value 1. Push the Rapid cool button again to cancel this function. The Rapid cool indicator will turn off and return to normal setting. The rapid cooling function will be automatically cancelled after 1 hour, unless cancelled by the user. Too cool a large amount of fresh food, press the rapid cool button before placing the food in the cooler compartment.

5. Vacation function

To activate the Vacation function, , press the quick fridge button for 3 seconds; this will activate the vacation mode indicator (). When the Vacation function is active, the cooler compartment temperature indicator displays the inscription "- -" and no cooling process will be active in the cooling compartment. This function is not suitable to keep food in the cooler compartment. Other compartments will remain cooled with the respective temperature set for each compartment. Push the vacation function button again to cancel this function.

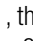
6. Cooler compartment temperature setting

After pressing the button , the cooler compartment temperature can be set to 8,7,6,5,4,3,2 and 1 respectively. ()

7. 1 Energy saving (display off)

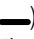
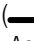
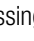
Pressing this button () will light up the energy-saving sign () and the Energy-saving function will activate. Activating the energy-saving function will turn off all other signs on the display. When the energy-saving function is active, pressing any button or opening the door will deactivate the energy-saving function and the display signals will return to normal. Pressing this button () again will turn off the energy-saving sign and deactivate the energy-saving function.

7.2 Alarm off

In case of power failure/high temperature alarm, after checking the food located in the freezer compartment press the alarm off button to clear the warning.

8. Keypad lock

Press the display off button, simultaneously for 3 seconds. The keypad lock sign will light up and the keypad lock will be activated; the buttons will be inactive when the Keypad lock is activated. Press the Display off button again simultaneously for 3 seconds. The keypad lock sign will turn off and the keypad lock mode will be disengaged. Press the Display off button to prevent changing the refrigerator's temperature settings.

Using the product

9. Eco-fuzzy

To activate the eco-fuzzy function, press and hold the eco-fuzzy button for 1 second. When this function is active, the freezer will switch to the economic mode after at least 6 hours and the economic use indicator will light up. To deactivate the (E) eco-fuzzy function, press and hold the eco-fuzzy function button for 3 seconds.

The indicator will light up after 6 hours when the eco-fuzzy function is active.

10. Freezer compartment temperature setting

The temperature in the freezer compartment is adjustable. Pressing the button will enable the freezer compartment temperature to be set at -18, -19, -20, -21, -22, -23 and -24.

11. Rapid freezing

For rapid freezing, press the button ; this will activate the rapid freezing indicator (❄).

When the rapid freezing function is turned on, the rapid freeze indicator will light up and the freezer compartment temperature indicator will display the value -27. Press the Rapid freeze button (❄) again to cancel this function. The Rapid freeze indicator will turn off and return to normal setting. The rapid freezing function will be automatically cancelled after 24 hours, unless cancelled by the user. To freeze a large amount of fresh food, press the rapid freeze button before placing the food in the freezer compartment.

Using the product

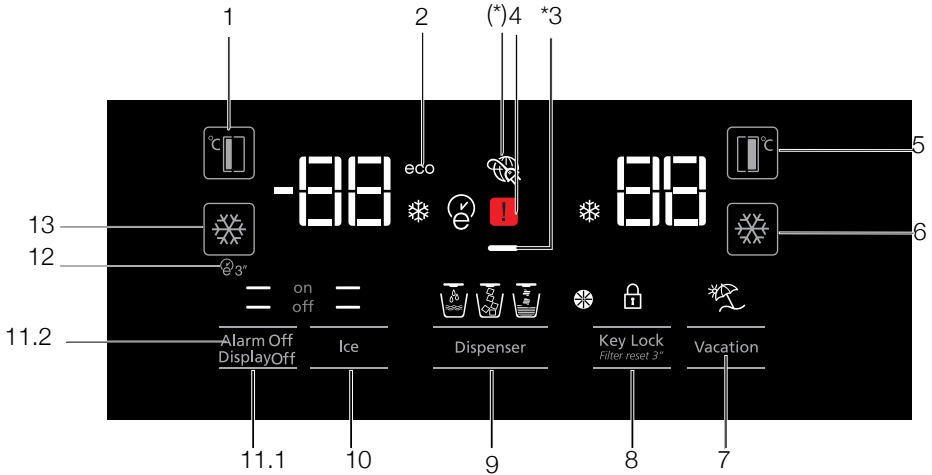

1. Freezer compartment temperature setting
2. Economy mode
3. Energy saving function (display off)
4. Power failure/High temperature / error warning indicator
5. Cooler compartment temperature setting
6. Rapid cooling
7. Vacation function
8. Keypad lock / filter replacing alert cancellation
9. Water, fragmented ice, ice cubes selection
10. Ice making on/off
11. Display on/off/Alarm off
12. Autoeco
13. Rapid freezing



***Optional:** The figures in this user guide are intended as drafts and may not perfectly match your product. If your product does not comprise the relevant parts, the information pertains to other models.

Using the product

1. Freezer compartment temperature setting

Pressing the button () will enable the freezer compartment temperature to be set at -18, -19, -20, -21, -22, -23, -24, -18...

2. Economy mode

Indicates the refrigerator is running on energy-saving mode. This indicator will be active when the freezer compartment temperature is set at -18 or the energy-saving cooling is engaged by eco-extra function. ()

3. Energy saving function (display off)

If the product doors are kept closed for a long time energy saving function is automatically activated and energy saving symbol is illuminated. When energy saving function is activated, all symbols on the display other than energy saving symbol will turn off. When the Energy Saving function is activated, if any button is pressed or the door is opened, energy saving function will be cancelled and the symbols on display will return to normal. Energy saving function is activated during delivery from factory and cannot be cancelled.

4. Power failure/High temperature / error warning indicator

This indicator () will light up in case of temperature faults or fault alerts. If you see this indicator is lit up, please see the "recommended solutions for problems" section in this guide.

This indicator illuminates during power failure, high temperature failures and error warnings. During sustained power failures, the highest temperature that the freezer compartment reaches will flash on the digital display. After checking the food located in the freezer compartment press the alarm off button to clear the warning.

5. Cooler compartment temperature setting

After pressing the button (), the cooler compartment temperature can be set to 8,7,6,5,4,3,2.. respectively.

6. Rapid cooling

For rapid cooling, press the button; this will activate the rapid cooling indicator ()



Press this button again to deactivate this function. Use this function when placing fresh foods into the cooler compartment or to rapidly cool the food items. When this function is activated, the refrigerator will be engaged for 1 hour.

7. Vacation function

When the Vacation function () is active, the cooler compartment temperature indicator displays the inscription "- -" and no cooling process will be active in the cooling compartment. This function is not suitable to keep food in the cooler compartment. Other compartments will remain cooled with the respective temperature set for each compartment.



Press the vacation function button again to cancel this function. ()

8. Keypad lock / Keypad lock / filter replacing alert cancellation



Press keypad lock button () to activate the keypad lock. You may also use this function to prevent changing the refrigerator's temperature settings. The refrigerator's filter must be replaced every 6 months. If you follow the instructions in the section 5.2, the refrigerator will automatically calculate the remaining period and the filter replacing alert indicator () will light up when filter expires.

Press and hold the button () for 3 seconds to turn off the filter alert light.

9. Water, fragmented ice, ice cubes selection



Navigate the water (), ice cube () and fragmented ice () selections using the button number 8. The active indicator will remain lit.

10. Ice making on/off

Press the button () to cancel (off ) or activate (on ) ice-making.

Using the product

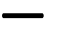
11.1 Display on/off

When you press the Display off button and when the ( off) function is lit, all the other icons of the display will go off and the display will enter the energy saving mode. When you press the Display off button again and when the ( on) function is lit, all the other icons of the display will be lit and the display will exit the energy saving mode.

11.2 Alarm off warning

In case of power failure/high temperature alarm, after checking the food located in the freezer compartment press the alarm off button to clear the warning.

12. Autoeco

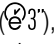
Press the auto eco button (), for 3 seconds to activate this function. If the door remains closed for a long time when this function is activated, the cooler section will switch to economic mode. Press the button again to deactivate this function.

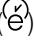
The indicator will light up after 6 hours when the auto eco function is active. ()

13. Rapid freezing

Press the button () for rapid freezing. Press the button again to deactivate the function.

Using the product

5.2. Activating water filter change warning

(For products connected to the mains water line and equipped with filter)

Water filter change warning is activated as follows:

Automatic filter usage time calculation is not enabled ex factory.

It must be enabled in products equipped with a filter.

The S4 display board we use in the refrigerator has a nine-key system.

Set values are shown in the display.

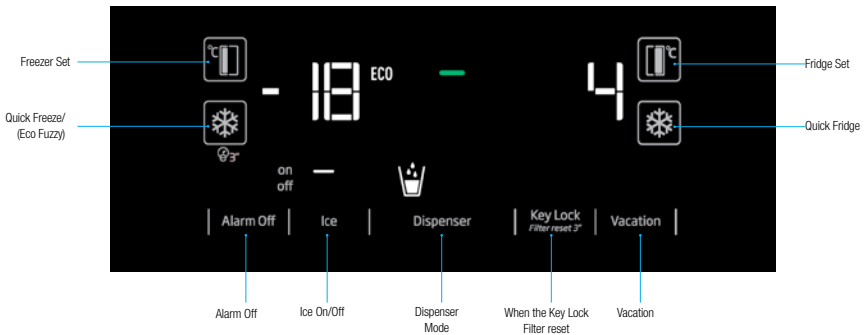

*(pressing 3 seconds)

After energising, press Alarm Off and Vacation buttons for 3 seconds to enter the password entry screen.

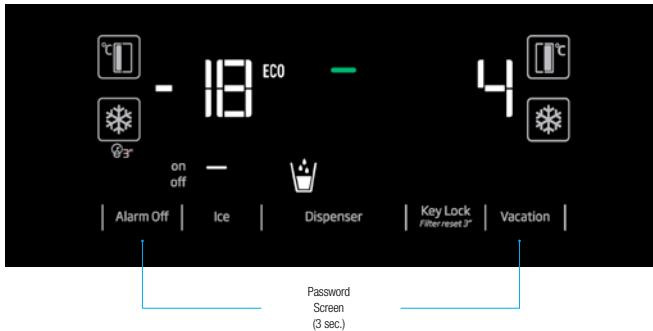

Using the product

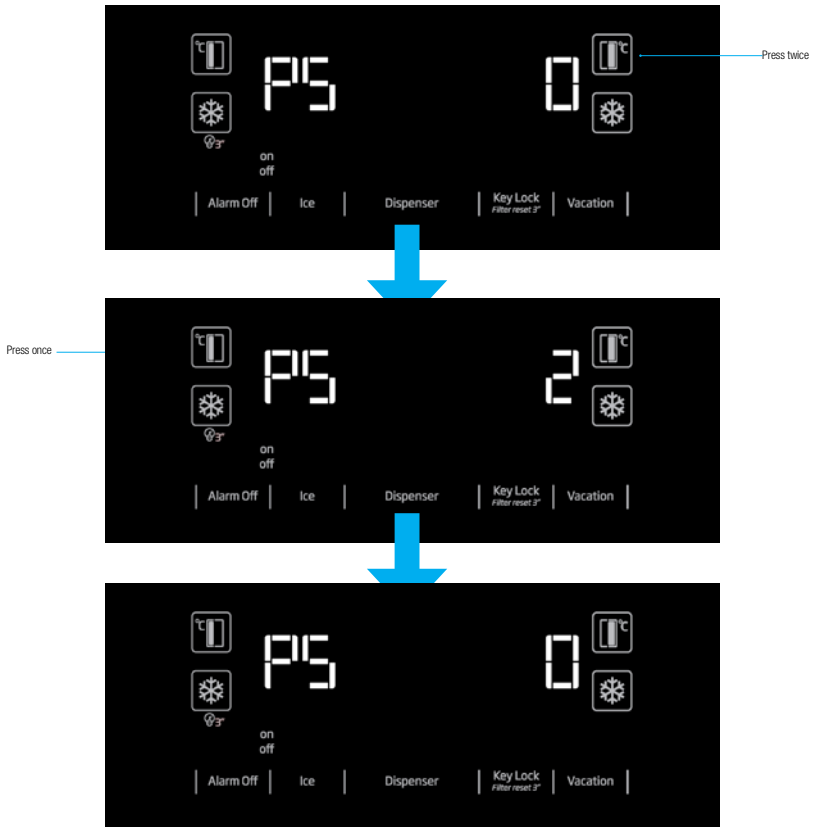

“Upon seeing PS 0 screen, de-energise the refrigerator and energise it again. This way, the filter counter will be activated. The filter warning LED will be active on the display in 130 days. After replacing the filter with a new one, press the Key Lock button for 3 seconds to make the filter counter to count down from 130 days.

Repeat the steps given above to cancel this function.”

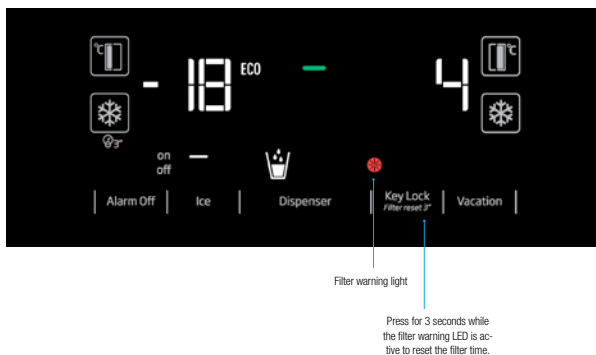

5.3. Humidity controlled crisper

(FreSHelf)

(This feature is optional)

Humidity rates of the vegetables and fruit are kept under control with the feature of humidity-controlled crisper and the food is ensured to stay fresh for longer.

We recommend you to place the leafy vegetables such as lettuce, spinach and the vegetables which are sensitive to humidity loss, in a horizontal manner as much as possible inside the crisper, not on their roots in a vertical position.

While the vegetables are being placed, specific gravity of the vegetables should be taken into consideration. Heavy and hard vegetables should be put at the bottom of the crisper and the lightweight and soft vegetables should be placed over.

Never leave the vegetables inside the crisper in their bags. If the vegetables are left inside their bags, this will cause them to decompose in a short period of time. In case contacting with other vegetables is not preferred for hygiene concerns, use a perforated paper and other similar packaging materials instead of a bag.

Do not place together the pear, apricot, peach, etc. and apple in particular which have a high level of generation of ethylene gas in the same crisper with the other vegetables and fruit. The ethylene gas which is emitted by these fruit may cause the other fruit to ripen faster and decompose in a shorter time.

5.4. Deodorising Module

(FreshGuard)

(This feature is optional)

The deodorising module eliminates the bad odours in your refrigerator in a short while before they pervade the surfaces. Thanks to this module located in the ceiling of the fresh food compartment, the air actively passes over the odour filter, meanwhile bad odour molecules decompose, and the air that has come out after being cleaned is given back into the fresh food compartment. This way, the unwanted odours that may form while foods are being stored in the refrigerator can be eliminated before they pervade the surfaces.

This is achieved via the fan, LED and the odour filter in the module. In daily use, the deodorising module will get automatically activated for 2 hours every 48 hours on a periodical basis.

The noise that will be heard during operation due to the fan incorporated into the fan is normal. If the door of the fresh food compartment is opened while the module is active, the fan will stop temporarily and it will continue to operate after the door has been closed. In case of power failure, the deodorising module will resume operating where it has left off in a manner that the total operation time is 2 hours.

Info: To prevent bad odours that may emerge from the mixing of smells of different foods, we recommend you to store aromatic foods such as cheese, olives and delicatessen products in their sealed packages. For the safety of other foods stored and to prevent odours, we recommend you to remove the foods you have realised are spoiled from the refrigerator as soon as possible.

Using the product

5.5. Using the water fountain (for certain models)



The first few glasses of water taken from the fountain will normally be warm.



If the water fountain is not used for a long time, dispose of the first few glasses of water to get clean water.

You must wait approximately 12 hours to get cold water after first operating.

Use the display to select the water option, then pull the trigger to get water. Remove the glass shortly after pulling the trigger.

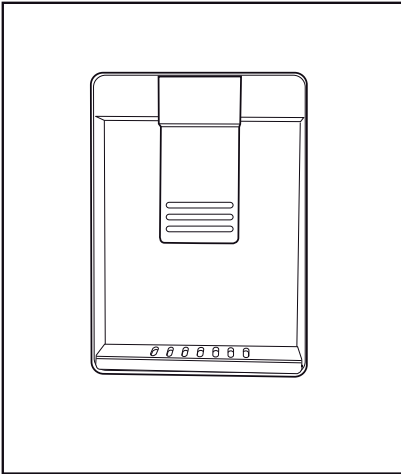

5.6. Filling the fountain water tank

Open the water tank's lid, as shown in the figure. Fill in pure and clean drinking water. Close the lid.

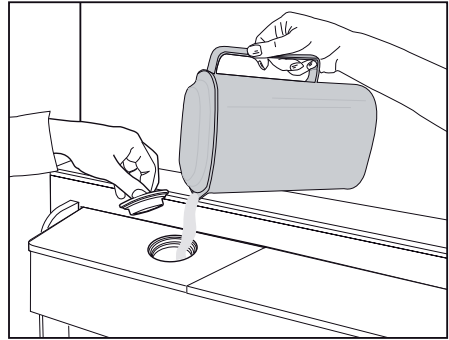

Using the product

5.7. Cleaning the water tank

Remove the water filling reservoir inside the door shelf.

Detach by holding both sides of the door shelf.

Hold both sides of the water tank and remove at 45° angle.

Remove and clean the water tank lid.

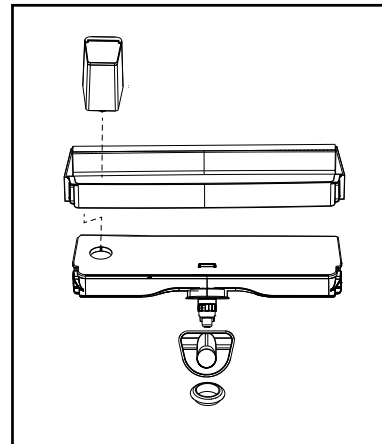
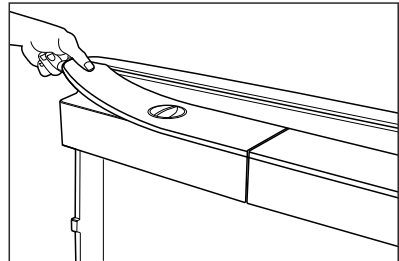
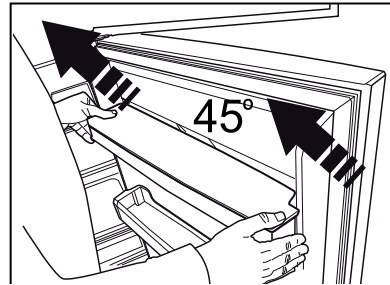
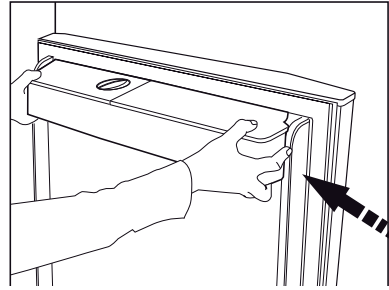

 Do not fill the water tank with fruit juice, fizzy beverages, alcoholic beverages or any other liquids incompatible for use in the water fountain. Using such liquids will cause malfunction and irreparable damage in the water fountain. Using the fountain in this way is not within the scope of warranty. Such certain chemicals and additives in the beverages / liquids may cause material damage to the water tank.

 The water tank and water fountain components cannot be washed with dishwashers.

Using the product

5.8. Taking ice / water

(Optional)

To take water (☰) / ice cube (☉) / fragmented ice (☂), use the display to select the respective option. Take water/ice by pushing the trigger on the water fountain forward. When switching between ice cube (☉) / fragmented ice (☂) options, the previous ice type may be discharged a few more times.

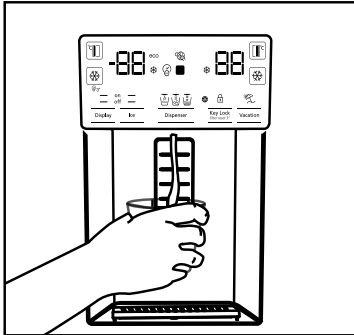

- You must wait approximately 12 hours before taking ice from the ice / water fountain for the first time. The fountain may not discharge ice if there is insufficient ice in the ice box.
- The 30 pieces of ice cubes (3-4 Litres) taken after first operating should not be used.
- In case of power blackout or temporary malfunction, the ice may partly melt and re-freeze. This will cause the ice pieces to merge with each other. In case of extended power blackouts or malfunction, the ice may melt and leak out. If you experience this problem, remove the ice in the ice box and clean the box.



WARNING: The product's water system should be connected to cold water line only. Do not connect to hot water line.

- The product may not discharge water during first operation. This is caused by the air in the system. The air in the system must be discharged. To do this, push the water fountain trigger for 1-2 minutes until the fountain discharges water. The initial water flow may be irregular. The water will flow normally once the air in the system is discharged.

- The water may be cloudy during first use of the filter; do not consume the first 10 glasses of water.
- You must wait approximately 12 hours to get cold water after first installation.
- The product's water system is designed for clean water only. Do not use any other beverages.
- It is recommended to disconnect the water supply if the product will not be used for long periods during vacation etc.
- If the water fountain is not used for a long time, the first 1-2 glasses of water received may be warm.

5.9. Drip tray

(optional)

The water dripping from the water fountain accumulates on the drip tray; no water drainage is available. Pull the drip tray out or push on the edges to remove the tray. You may then discharge the water inside the drip tray.

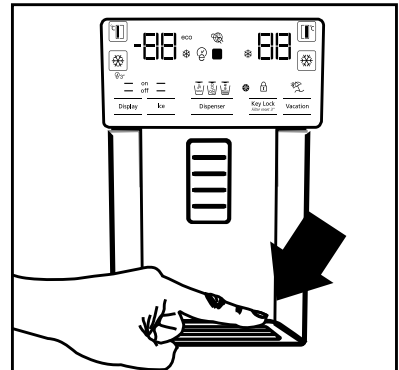

Using the product

5.10. Zero degree compartment (Optional)

Use this compartment to keep delicatessen at lower temperatures or meat products for immediate consumption. Do not place fruits and vegetables in this compartment. You can expand the product's internal volume by removing any of the zero degree compartments. To remove the compartment, simply pull forth, lift up and pull out.

5.11. Vegetable bin

The refrigerator's vegetable bin is designed to keep vegetables fresh by preserving humidity. For this purpose, the overall cold air circulation is intensified in the vegetable bin. Keep fruits and vegetables in this compartment. Keep the green-leaved vegetables and fruits separately to prolong their life.

5.12. Blue light (Optional)

The product's vegetable bins comprise blue light. The vegetables in the bin will continue photosynthesize under the blue light's wavelength effect and remain live and fresh.

5.13. Ionizer (Optional)

The ionizer system in the cooler compartment's air duct serves to ionize the air. The negative ion emissions will eliminate bacteria and other molecules causing odour in the air.

5.14. Minibar (Optional)

The refrigerator's minibar door shelf can be accessed without opening the door. This will allow you to easily take frequently consumed food and beverages from the refrigerator. To open the minibar cover, push with your hand and pull towards yourself.



WARNING: Do not sit, hang or place heavy objects on the minibar cover. This may damage the product or cause you to be injured.

To close this compartment, simply push forward from the upper section of the cover.

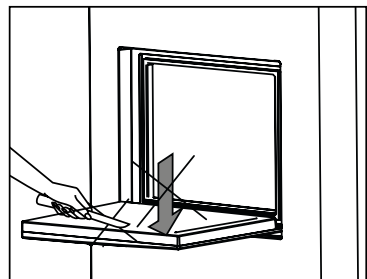
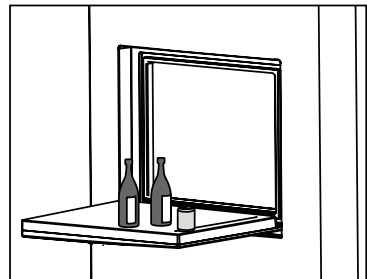
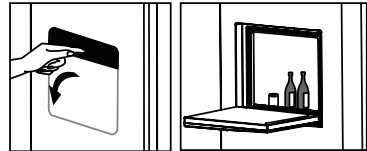
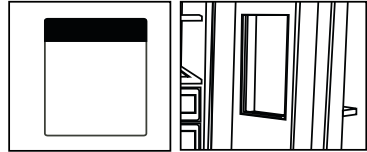

5.15. Odour filter (optional)

The odour filter in the cooler compartment's air duct will prevent undesirable odour formation.

Using the product

5.16. Icematic and ice storage box (Optional)

Fill the icematic with water and put in place. The ice will be ready after approximately two hours. Do not remove the icematic to take the ice.

Turn the buttons on the ice chambers right-hand side by 90°; the ice will fall to the ice storage box below. You may then remove the ice storage box and serve the ice.



The ice storage box is intended for storing ice only. Do not fill with water. Doing so will cause it to break.

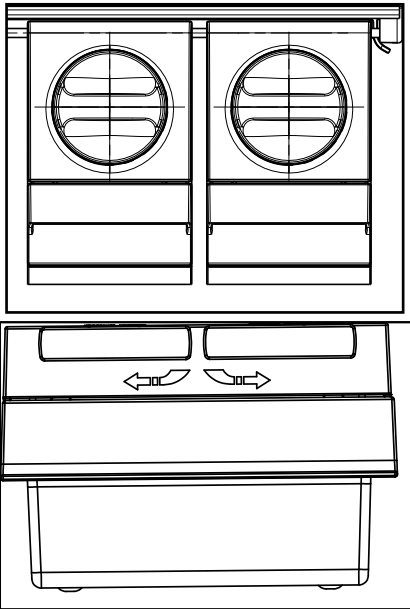

5.17. Ice-maker (Optional)

Ice maker is located on the upper section of the freezer cover.

Hold the handles on the sides of the ice stock reservoir and move up to remove.

Remove the ice-maker decorative lid by moving up.

OPERATION

To remove the ice reservoir

Hold the ice stock reservoir from the handles, then move up and pull the ice stock reservoir. (Figure 1)

To reinstall the ice reservoir

Hold the ice stock reservoir from the handles, move up with an angle to fit the sides of the reservoir to their slot and make sure that the ice selector pin is mounted properly. (Figure 2)

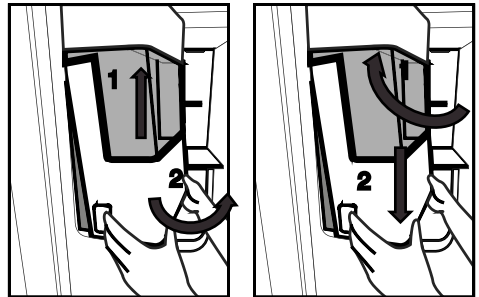

Using the product

Push downwards firmly, until there is no space left between the reservoir and the door plastic. (Figure 2)
If you have difficulty in refitting the reservoir, turn the rotary gear 90° and reinstall it as shown in the figure 3.
Any sound you hear when the ice drops into the reservoir is a part of normal operation.



When the ice dispenser does not work properly

If you do not remove ice cubes for a long time, they will cause formation of ice chunks. In this case, please remove the ice stock reservoir in accordance with the instructions given above, separate the ice chunks, discard the inseparable ice and put the ice cubes back into the ice stock reservoir. (Figure 4)



When ice does not come out, check for any ice stuck in the canal and remove it. Regularly check the ice canal to clear the obstacles as shown in the figure 5.



When using your refrigerator for the first time or when not using it for an extended period of time Ice cubes may be small due to air in the pipe after connection, any air will be purged during normal use. Discard the ice produced for approximately one day since the water pipe may contain the contaminants.

Caution!

Do not insert the hand or any other object into the ice canal and blade since it may damage the parts or hurt the hand.

Do not let the children hang on the ice dispenser or the ice maker since it may cause an injury

To prevent dropping the ice stock reservoir use both hands when removing it.

If you close the door hard, it may cause water spilling over the ice stock reservoir.

Do not dismantle the ice stock reservoir unless it is necessary.

If there is a lockout (ice does not come from the refrigerator) while taking broken ice, try to take cubed ice.

Using the product

Then it will be suitable for taking broken ice again.

While taking broken ice, cubed ice may come first. There is a case of coming cubed ice while taking broken ice.

Freezer door on front of the ice machine can create a light snow and film layer.

This is normal, it is recommended to clean without waiting for a long time.

The water is filled with water over time in the lower zone of the water dispenser. It is recommended to clean the water within this zone periodically.

While the ice falls from the ice storage reservoir, the sound is normal and does not indicate that the product is problematic.

The blade mechanism inside the ice bank is sharp and can cut your hand.

If the ice dispenser does not provide ice, the ice may be stuck together, remove the tank and clean it again.

Ice type cannot be changed on the display when the ice trigger is pressed to obtain ice. Release the trigger, change the ice type on the display and obtain ice again.

5.18. Freezing fresh food

- To preserve food quality, the food items placed in the freezer compartment must be frozen as quickly as possible, use the rapid freezing for this.
- Freezing the food items when fresh will extend the storage time in the freezer compartment.
- Pack the food items in air-tight packs and seal tightly.
- Make sure the food items are packed before putting in the freezer. Use freezer holders, tinfoil and damp-proof paper, plastic bag or similar packaging materials instead of traditional packaging paper.
- Mark each food pack by writing the date on the package before freezing. This will allow you to determine the freshness of each pack every time the freezer is opened. Keep the earlier food items in the front to ensure they are used first.
- Frozen food items must be used immediately after defrosting and should not be frozen again.
- Do not free large quantities of food at once.

Freezer Compartment Setting	Cooler Compartment Setting	Descriptions
-18°C	4°C	This is the default, recommended setting.
-20,-22 or -24°C	4°C	These settings are recommended for ambient temperatures exceeding 30°C.
Rapid Freeze	4°C	Use this to freeze food items in a short time, the product will reset to previous settings when the process is completed.
-18°C or colder	2°C	Use these settings if you believe the cooler compartment is not cold enough due to ambient temperature or frequently opening the door.

Using the product

5.19.Recommendations for storing frozen foods

The compartment must be set to at least -18°C.

1. Place the food items in the freezer as quickly as possible to avoid defrosting.
2. Before freezing, check the “Expiry Date” on the package to make sure it is not expired.
3. Make sure the food's packaging is not damaged.

5.20.Deep freezer details

As per the IEC 62552 standards, the freezer must have the capacity to freeze 4,5 kg of food items at -18°C or lower temperatures in 24 hours for each 100 litres of freezer compartment volume. Food items can only be preserved for extended periods at or below temperature of -18°C . You can keep the foods fresh for months (in deep freezer at or below temperatures of 18°C).

The food items to be frozen must not contact the already-frozen food inside to avoid partial defrosting.

Boil the vegetables and filter the water to extend the frozen storage time. Place the food in air-tight packages after filtering and place in the freezer. Bananas, tomatoes, lettuce, celery, boiled eggs, potatoes and similar food items should not be frozen. Freezing these food items will simply reduce the nutritional value and food quality, as well as possible spoiling which is harmful to health.

5.21.Placing the food

Freezer compartment shelves	Various frozen goods including meat, fish, ice cream, vegetables etc.
Cooler compartment shelves	Food items inside pots, capped plate and capped cases, eggs (in capped case)
Cooler compartment door shelves	Small and packed food or beverages
Vegetable bin	Fruits and vegetables
Fresh food compartment	Delicatessen (breakfast food, meat products to be consumed in short notice)

5.22.Door open alert (Optional)

An audible alert will be heard if the product's door remains open for 1 minute. The audible alert will stop when the door is closed or any button on the display (if available) is pressed.

5.23.Interior light

Interior light uses a LED type lamp. Contact the authorized service for any problems with this lamp. The lamp(s) used in this appliance is not suitable for household room illumination. The intended purpose of this lamp is to assist the user to place foodstuffs in the refrigerator/freezer in a safe and comfortable way.

Cleaning your fridge at regular intervals will extend the service life of the product.



WARNING:

- Unplug the product before cleaning it.
- Never use gasoline, benzene or similar substances for cleaning purposes.
- Never use any sharp and abrasive tools, soap, household cleaners, detergent and wax polish for cleaning.
- For non-No Frost products, water drops and frosting up to a fingerbreadth occur on the rear wall of the Fridge compartment. Do not clean it; never apply oil or similar agents on it.
- Only use slightly damp microfiber cloths to clean the outer surface of the product. Sponges and other types of cleaning cloths may scratch the surface
- Dissolve one teaspoon of bi-carbonate in half litre of water. Soak a cloth with the solution and wrung it thoroughly. Wipe the interior of the refrigerator with this cloth and the dry thoroughly.
- Make sure that no water enters the lamp housing and other electrical items.
- If you will not use the refrigerator for a long period of time, unplug it, remove all food inside, clean it and leave the door ajar.
- Check regularly that the door gaskets are clean. If not, clean them.

- To remove door and body shelves, remove all of its contents.
- Remove the door shelves by pulling them up. After cleaning, slide them from top to bottom to install.
- Never use cleaning agents or water that contain chlorine to clean the outer surfaces and chromium coated parts of the product. Chlorine causes corrosion on such metal surfaces.

6.1 Avoiding bad odours

- Materials that may cause odour are not used in the production of our refrigerators. However, due to inappropriate food preserving conditions and not cleaning the inner surface of the refrigerator as required can bring forth the problem of odour. Pay attention to following to avoid this problem:
- Keeping the refrigerator clean is important. Food residuals, stains, etc. can cause odour. Therefore, clean the refrigerator with bi-carbonate dissolved in water every few months. Never use detergents or soap.
- Keep the food in closed containers. Microorganisms spreading out from uncovered containers can cause unpleasant odours.
- Never keep the food that have passed best before dates and spoiled in the refrigerator.

6.2 Protecting the plastic surfaces

Do not put liquid oils or oil-cooked meals in your refrigerator in unsealed containers as they damage the plastic surfaces of the refrigerator. If oil is spilled or smeared onto the plastic surfaces, clean and rinse the relevant part of the surface at once with warm water.

Check this list before contacting the service. Doing so will save you time and money. This list includes frequent complaints that are not related to faulty workmanship or materials. Certain features mentioned herein may not apply to your product.

The refrigerator is not working.

- The power plug is not fully settled. >>> Plug it in to settle completely into the socket.
- The fuse connected to the socket powering the product or the main fuse is blown. >>> Check the fuses.

Condensation on the side wall of the cooler compartment (MULTI ZONE, COOL, CONTROL and FLEXI ZONE).

- The door is opened too frequently >>> Take care not to open the product's door too frequently.
- The environment is too humid. >>> Do not install the product in humid environments.
- Foods containing liquids are kept in unsealed holders. >>> Keep the foods containing liquids in sealed holders.
- The product's door is left open. >>> Do not keep the product's door open for long periods.
- The thermostat is set to too low temperature. >>> Set the thermostat to appropriate temperature.

Compressor is not working.

- In case of sudden power failure or pulling the power plug off and putting back on, the gas pressure in the product's cooling system is not balanced, which triggers the compressor thermic safeguard. The product will restart after approximately 6 minutes. If the product does not restart after this period, contact the service.

- Defrosting is active. >>> This is normal for a fully-automatic defrosting product. The defrosting is carried out periodically.
- The product is not plugged in. >>> Make sure the power cord is plugged in.
- The temperature setting is incorrect. >>> Select the appropriate temperature setting.
- The power is out. >>> The product will continue to operate normally once the power is restored.

The refrigerator's operating noise is increasing while in use.

- The product's operating performance may vary depending on the ambient temperature variations. This is normal and not a malfunction.

The refrigerator runs too often or for too long.

- The new product may be larger than the previous one. Larger products will run for longer periods.
- The room temperature may be high. >>> The product will normally run for long periods in higher room temperature.
- The product may have been recently plugged in or a new food item is placed inside. >>> The product will take longer to reach the set temperature when recently plugged in or a new food item is placed inside. This is normal.
- Large quantities of hot food may have been recently placed into the product. >>> Do not place hot food into the product.
- The doors were opened frequently or kept open for long periods. >>> The warm air moving inside will

Troubleshooting

cause the product to run longer. Do not open the doors too frequently.

- The freezer or cooler door may be ajar. >>> Check that the doors are fully closed.
- The product may be set to temperature too low. >>> Set the temperature to a higher degree and wait for the product to reach the adjusted temperature.
- The cooler or freezer door washer may be dirty, worn out, broken or not properly settled. >>> Clean or replace the washer. Damaged / torn door washer will cause the product to run for longer periods to preserve the current temperature.

The freezer temperature is very low, but the cooler temperature is adequate.

- The freezer compartment temperature is set to a very low degree. >>> Set the freezer compartment temperature to a higher degree and check again.

The cooler temperature is very low, but the freezer temperature is adequate.

- The cooler compartment temperature is set to a very low degree. >>> Set the freezer compartment temperature to a higher degree and check again.

The food items kept in cooler compartment drawers are frozen.

- The cooler compartment temperature is set to a very low degree. >>> Set the freezer compartment temperature to a higher degree and check again.

The temperature in the cooler or the freezer is too high.

- The cooler compartment temperature is set to a very high degree. >>> Temperature setting of the cooler compartment has an

effect on the temperature in the freezer compartment. Wait until the temperature of relevant parts reach the sufficient level by changing the temperature of cooler or freezer compartments.

- The doors were opened frequently or kept open for long periods. >>> Do not open the doors too frequently.
- The door may be ajar. >>> Fully close the door.
- The product may have been recently plugged in or a new food item is placed inside. >>> This is normal. The product will take longer to reach the set temperature when recently plugged in or a new food item is placed inside.
- Large quantities of hot food may have been recently placed into the product. >>> Do not place hot food into the product.

Shaking or noise.

- The ground is not level or durable. >>> If the product is shaking when moved slowly, adjust the stands to balance the product. Also make sure the ground is sufficiently durable to bear the product.
- Any items placed on the product may cause noise. >>> Remove any items placed on the product.

The product is making noise of liquid flowing, spraying etc.

- The product's operating principles involve liquid and gas flows. >>> This is normal and not a malfunction.

There is sound of wind blowing coming from the product.

- The product uses a fan for the cooling process. This is normal and not a malfunction.

Troubleshooting

There is condensation on the product's internal walls.

- Hot or humid weather will increase icing and condensation. This is normal and not a malfunction.
- The doors were opened frequently or kept open for long periods. >>> Do not open the doors too frequently; if open, close the door.
- The door may be ajar. >>> Fully close the door.

There is condensation on the product's exterior or between the doors.

- The ambient weather may be humid, this is quite normal in humid weather. >>> The condensation will dissipate when the humidity is reduced.

The interior smells bad.

- The product is not cleaned regularly. >>> Clean the interior regularly using sponge, warm water and carbonated water.
- Certain holders and packaging materials may cause odour. >>> Use holders and packaging materials without free of odour.
- The foods were placed in unsealed holders. >>> Keep the foods in sealed holders. Micro-organisms may spread out of unsealed food items and cause malodour. Remove any expired or spoilt foods from the product.

The door is not closing.

- Food packages may be blocking the door. >>> Relocate any items blocking the doors.
- The product is not standing in full upright position on the ground. >>> Adjust the stands to balance the product.
- The ground is not level or durable. >>> Make sure the ground is level and sufficiently durable to bear the product.

The vegetable bin is jammed.

- The food items may be in contact with the upper section of the drawer. >>> Reorganize the food items in the drawer.

If The Surface Of The Product Is Hot.

- High temperatures may be observed between the two doors, on the side panels and at the rear grill while the product is operating. This is normal and does not require service maintenance! Be careful when touching these areas.



WARNING:

If the problem persists after following the instructions in this section, contact your vendor or an Authorised Service. Do not try to repair the product.

危险物质含量说明

本产品超过使用期限或经过维修无法正常工作后，不应随意丢弃，请交由有废弃电器电子产品处理资格的企业处理，正确的处理方法请查阅国家或当地有关旧电器电子产品处理的规定。

附：产品中有害物质的名称和含量

部件名称	Hazardous substance					
	铅 (Pb)	汞 (Hg)	镉 (Cd)	六价铬 (CR(VI))	多溴联苯 (PBB)	多溴联苯醚 (PBDE)
照明组件	○	○	○	○	○	○
箱体	○	○	○	○	○	○
冷凝器	○	○	○	○	○	○
压缩机	○	○	○	○	○	○
电源线	○	○	○	○	○	○
搁架	○	○	○	○	○	○
门	○	○	○	○	○	○
主控板	×	○	○	○	○	○
显示屏组件	×	○	○	○	○	○
风扇组件	○	○	○	○	○	○
利用组件	○	○	○	○	○	○
螺钉	○	○	○	○	○	○
<p>本表格按照 SJ/T-11364 的规定编制。</p> <p>○：表示该有害物质在该部件所有均质材料中的含量均在 GB/T 26572 规定的限量要求以下。</p> <p>×：表示该有害物质至少在该部件的某一均质材料中的含量超出 GB/T 26572 规定的限量要求。</p> <p>上表中打 × 的部件，由于技术原因目前无法实现替代，今后随着技术进步，将实现替代或改进。</p>						
	<p>本产品在使用正常情况下，环保使用期限为 15 年。</p>					

尊敬的客户：

我们希望您能够从我们的产品中获得最佳的功效，我们的产品使用现代化的设备经过严格的质量控制生产而成。

为此，请在使用该产品之前仔细阅读用户指南，并保存好该指南以备参考之用。如果您将该产品移交给其他用户，请随同产品一起提供本指南。

用户指南可以确保对产品的快速和安全的使用。

- 安装和操作产品之前，请阅读用户指南。
- 应始终遵守适用的安全指示。
- 将用户指南保存在易获取的地方以供将来使用。
- 请阅读随产品一起提供的其他任何文档。

请注意，此用户指南可能应用于多种产品型号。本指南清除标明了不同型号之间的所有差异。

标志和备注

用户指南中使用了以下标志：

	重要信息和有用提示。
	生命和财产危险。
	电击危险。
	产品的包装由可再生材料制成，符合国家环境法规的相关规定。

目录

1 安全和环境说明	3	5 使用产品	17
1.1.一般安全性	3	5.1.指示灯面板	17
1.1.1 HC 警告	4	5.2.除臭模块	23
1.1.2 针对配有饮水机的型号	4	(FreshGuard)	23
1.2.既定用途	4	5.3.激活更换滤水器警告	26
1.3.儿童安全	4	5.4.使用饮水机	28
1.4.符合 WEEE 指令和报废产品处置	4	5.5.加注饮水机水箱	28
1.5.符合 RoHS 指令	5	5.6.湿度控制蔬菜盒	28
1.6.包装信息	5	5.7.清洁水箱	29
2 冰箱	6	5.8.饮用冰/水	30
2 冰箱	7	5.9.承水盘	30
3 安装	8	5.10.零度冷藏室	31
3.1.安装的正确位置	8	5.11.蔬菜盒	31
3.2.连接塑料楔子	8	5.12.蓝光	31
3.3.调整支腿	9	5.13.离子发生器	31
3.4.电源连接	9	5.14.迷你吧	31
3.5.水源连接	10	5.15.除味器	31
3.6.将水管连接到产品	11	5.16.制冰盒和冰储藏柜	32
3.7.连接到总水管	11	5.17.制冰器	32
3.8.对于使用桶装水的产品	12	5.18.冷冻新鲜食品	34
3.9.净水器	12	5.19.保存冷冻食品的建议	34
3.9.1.在墙壁上安装外部净水器(可选)	13	5.20.深度冷冻详细信息	34
3.9.2.内部净水器	14	5.21.放置食品	35
4 准备	16	5.22.门打开提示	35
4.1.节能措施	16	5.23.内灯	35
4.2.首次使用	16	6 维护和清洁	36
		6.1.防止异味	36
		6.2.保护塑料表面	36
		7 故障排除	37

1 安全和环境说明

本节提供必要的安全指南，以防受伤和材料损坏。未遵守这些指南将使冰箱的各种保修失效。

既定用途

	警告： 确保该电器外壳或者内置结构中的通风开口不受任何阻碍。
	警告： 请勿使用机械装置或者其它手段，加速除霜过程，除非制造商建议这样做。
	警告： 请勿损坏制冷剂回路。
	警告： 请勿在该电器的食物储藏室使用电气装置，除非是制造商建议的类型。

本装置拟用于家庭和类似场合，例如

- 商店、办公室和其它环境中的员工厨房区域；
- 农房和在宾馆、汽车旅馆及其它居住型环境中由客户使用；
- 住宿和早餐型环境中；
- 给养和类似的非零售场合。

1.1. 一般安全性

- **存在身体、感官或精神障碍的人员、缺乏经验和相关使用信息的人士以及儿童不得操作、进入或摆弄本产品。**
- **如果不遵循此类指示，或者对产品的使用不受控，则可能导致严重后果！**
- 若发生故障，拔下插头。
- 拔下插头后，等待至少5分钟，再重新连接插头。

- 不使用时，请拔下插头。
- 请勿用湿手接触插头！拔插头时请勿拉扯电线，而应始终握住插头。
- 如果插座松脱，请勿连接冰箱插头。
- 安装、维护、清洁和修理过程中，应拔下产品插头。
- 若长时间不使用本产品，拔下插头，并取出内部所有食物。
- 电路卡位于产品上方后部（电卡盒盖）（1）的隔室打开时，请勿使用本产品。

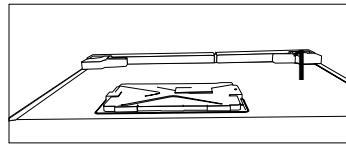
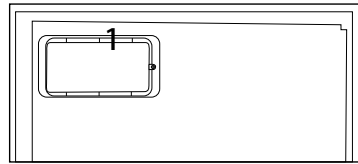

- 切勿使用蒸汽或蒸汽清洁材料清洁冰箱及融化内部冰块。蒸汽可能接触带电区域，并造成短路或触电！
- 清洁本产品时，请勿在上面洒水或倒水！有触电的危险！
- 若发生故障，请勿使用冰箱，否则，可能造成触电。采取任何措施前，请联系授权服务中心。
- 将产品插头插入接地的插座。接地工作必须由具备资格的电工完成。
- 如果产品配置有 LED 类型的灯，如需更换或有任何问题，请与授权服务中心联系。

安全和环境指示

- 请勿用湿手接触冷冻食物！食物可能粘到您的手上！
- 请勿将瓶装或罐装液体放入冷冻室。其可能爆裂！
- 拧紧液体瓶盖后，直立放置。
- 请勿在产品附近喷洒易燃物质，可能着火或爆炸。
- 请勿将易燃材料或装有易燃气体（喷雾等）的物品放入冰箱内。
- 请勿在本产品顶部放置装有液体的容器。水飞溅到电气元件上可能导致发生触电或者火灾危险。
- 本产品淋雨、落雪、受到阳光照射和风吹均会影响到电气安全。重新摆放本产品时，请勿抓握门把手拉拽。把手可能会脱落。
- 小心您的双手或身体的任何部位不要被冰箱内的移动零件卡住。
- 请勿踩踏或倚靠在冰箱的门、抽屉或类似部位。这可能会造成本产品倾倒，并损坏部件。
- 小心不要缠住电线。

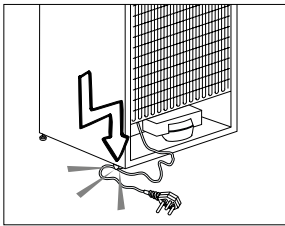

- 安置设备时，请确保电源线未打结或损坏。
- 请勿将多个便携式插座或便携式电源放置在设备后面。
- 允许3到8岁的儿童向冰箱内放入东西或从中取出东西。
- 为避免污染食物，请遵守以下说明：

- - 将冰箱门长时间保持打开将会造成
- 冰箱舱室内温度显著上升。
- - 定期清洁会与食物接触的表面以及可以触及的外排系统。
- - 如果已有48小时未使用水箱，应对其进行清洁；如果已有5天未排水，应连接水源对水系统进行冲洗。
- - 应将生肉和鱼以适用容器存放在冰箱内，防止其
- 接触到或滴落到其他食物。
- - 两星冷冻食物舱适用于存放已预先冻好的食物、适用于存放或冻制冰激凌和制作冰块。
- - 一星、两星和三星舱室不适用于冷冻处理新鲜食物。
- - 如果需将冰箱长时间空置，请断电、解冻、清洁、干燥，并保持
- 冰箱门打开，防止冰箱内发霉。

1.1.1 HC 警告

如果冰箱包含使用 R600a 气体的制冷系统，使用和移动冰箱时，小心避免损坏制冷系统及其管道。此气体易燃。如果制冷系统损坏，本产品应远离火源，并立即对房间通风。



本产品使用的气体类型在位于冰箱内部左壁上的标签上注明。

1.1.2 针对配有饮水机的型号

- 冷水入口压力最高为 90 psi (620 kPa)。如果水压超过 80 psi (550 kPa)，在主系统中，使用压力限制阀。如果不了解如何检查水压，可以寻求专业水管工的帮助。
- 如果安装环境有水击的风险，请务必使用水击防止设备。如果不确定安装环境是否有水击

安全和环境指示

效应，请咨询专业的水管工。

- 请勿在热水入口安装。采取措施，防止软管冻结。水温操作间隔最低33°F (0.6°C)，最高100°F (38°C)。
- 只能使用饮用水。

1.2. 既定用途

- 本产品设计供家庭使用。不用于商业用途。
- 本产品应用来存放食物和饮料。
- 请勿将需要控制温度的敏感产品（疫苗、对温度变化敏感的药物、医用材料等）放入冰箱内。
- 制造商对使用不当或处理不当造成的损坏不承担任何责任。

1.3. 儿童安全

- 包装材料经置于儿童不可及之处。
- 儿童不得摆弄本产品。
- 如果冰箱门上有锁，钥匙应置于儿童不可及之处。

1.4. 符合 WEEE 指令和报废产品处置

本产品符合 EU WEEE 指令(2012/19/EU)。本产品带有报废电子电器设备(WEEE)的分类符号。

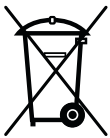

本产品采用可以重复利用和适合回收的优质零件和材料制成。在本产品使用寿命结束时，请勿将其作为日常的生活垃圾和其他废物进行处置。应将其送至回收电器电子设备的收集中心。有关这些收集中心的信息，请咨询当地的权力机构。

1.5. 符合 RoHS 指令

- 本产品符合 EU WEEE 指令(2011/65/EU)。其不含有该指令中指定的有害和禁用材料。

1.6. 包装信息

- 本产品的包装材料根据国家环境规定，采用可回收材料制成。包装材料不得与生活垃圾或其他废物一起处置。应将其送至当地机构指定的包装材料回收点。

2 冰箱

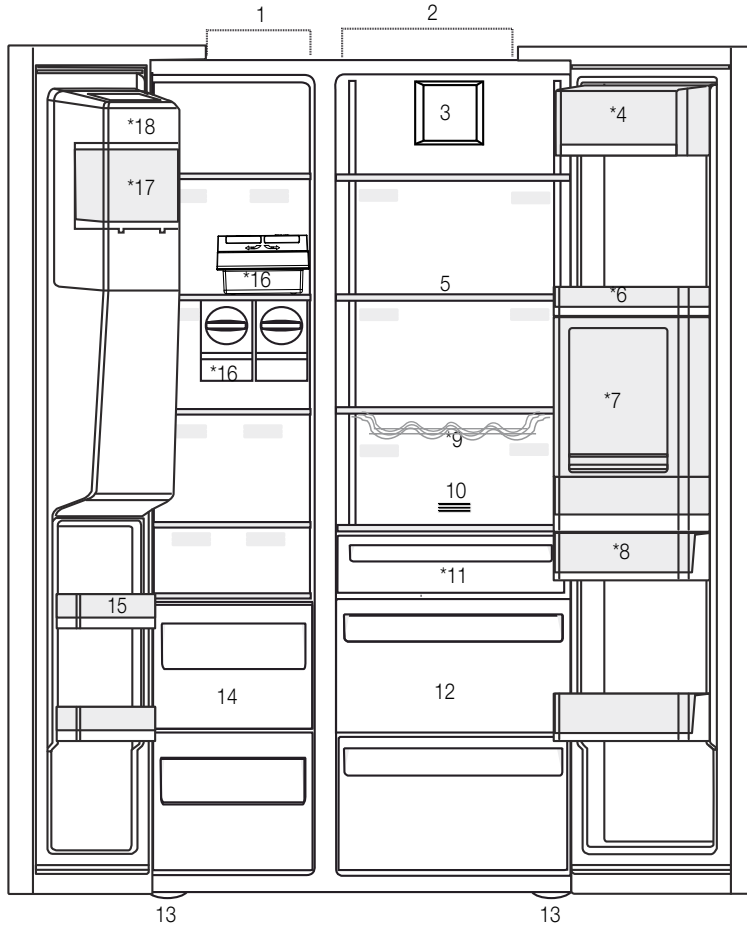

- | | |
|-----------|-------------|
| 1- 冷冻室 | 10- 抗菌过滤器 |
| 2- 冷藏室 | 11- 零度冷藏室 |
| 3- 风扇 | 12- 果菜盒 |
| 4- 黄油奶酪室 | 13- 可调底脚 |
| 5- 玻璃搁架 | 14- 冷冻食品储藏室 |
| 6- 冷藏室门搁架 | 15- 冷冻室门搁架 |
| 7- 迷你吧附件 | 16- 制冰盒 |
| 8- 水箱 | 17- 储冰盒 |
| 9- 酒架 | 18- 储冰盒装饰盖 |
| | * 可选 |



* 可选：本用户指南中的各图为示意图，可能与您的产品并不完全一致。如果您的产品不包含相关的部件，则该信息适用于其他型号。

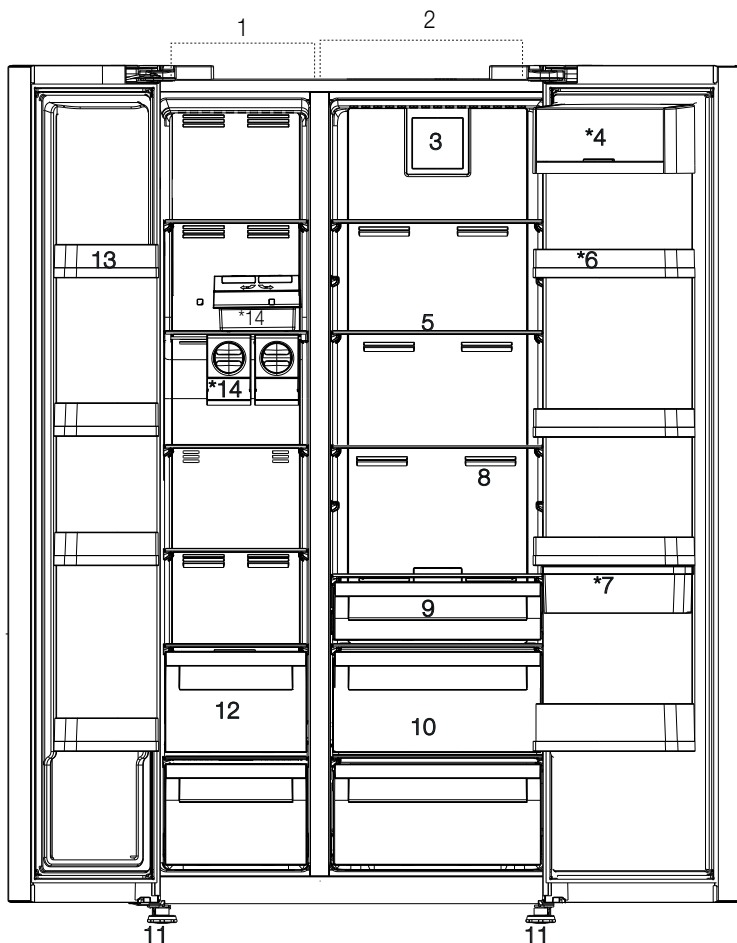

- | | |
|-----------|-------------|
| 1- 冷冻室 | 9- 零度冷藏室 |
| 2- 冷藏室 | 10- 果菜盒 |
| 3- 风扇 | 11- 可调底脚 |
| 4- 黄油奶酪室 | 12- 冷冻食品储藏室 |
| 5- 玻璃搁架 | 13- 冷冻室门搁架 |
| 6- 冷藏室门搁架 | 14- 制冰盒 |
| 7- 水箱 | * 可选 |
| 8- 抗菌过滤器 | |



* 可选：本用户指南中的各图为示意图，可能与您的产品并不完全一致。如果您的产品不包含相关的部件，则该信息适用于其他型号。

3 安装

3.1. 安装的正确位置

请联系经过授权的服务人员以获取产品安装信息。要做好产品安装准备，请参阅用户指南中的信息，并确保水电设施符合所要求。如果不符合，请致电电工和水管工来根据需要安排水电设施。



警告: 厂商对未经授权人员进行的工作而造成的损坏不承担任何责任。



警告: 安装过程中，必须拔掉产品的电源线。如果不这样做，可能会造成死亡或重大伤害！



警告: 如果房门太窄，产品无法通过，请拆下冰箱门并将产品侧过来；如果这样仍然不行，请联系经过授权的服务人员。

- 将产品放置在平坦的地面上，以防止晃动。
- 将产品放置在距离加热器、火炉、类似热源至少 30 厘米和距离电磁炉至少 5 厘米的地方。
- 请勿将产品暴露在阳光直射的地方或放在潮湿的环境中。
- 产品要求有充足的空气流动，以便能够有效地工作。如果将产品放置在墙壁的凹口，则产品与天花板和墙壁之间的距离至少保留有 5 厘米。
- 请勿将产品安装在温度低于 5°C 的环境中。

3.2. 连接塑料楔子

请使用随产品一起提供的塑料楔子来保证产品和墙壁之间具有充足的空间用于空气流通。

1. 要安装楔子，请卸下产品上的螺丝，并使用随楔子一起提供的螺丝。

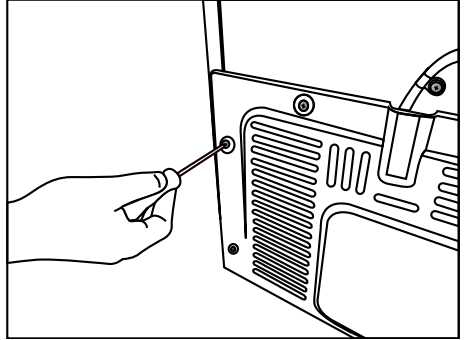

2. 在通风盖上安装上 2 塑料楔子，如图中 J 所示。

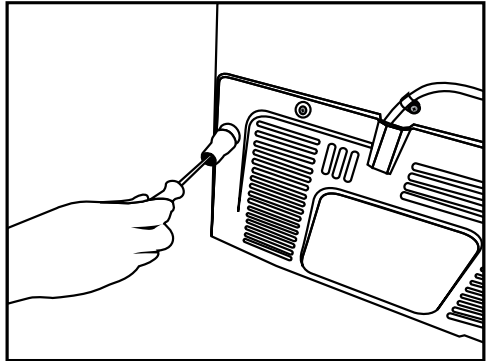

3.3. 调整支腿

如果产品没有处在平衡位置，请向左或向右旋转，调整前面可调整的支腿。

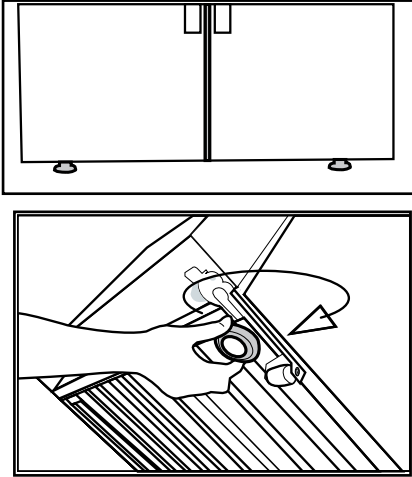

若要垂直调整门的位置：

- 松开底部的固定螺母
- 根据门的位置，转动调整螺母（顺时针/逆时针）
- 在最终位置，上紧固定螺母

若要水平调整门的位置：

- 松开顶部的固定螺栓
- 根据门的位置，转动侧面的调整螺栓（顺时针/逆时针）
- 在最终位置，上紧顶部固定螺栓

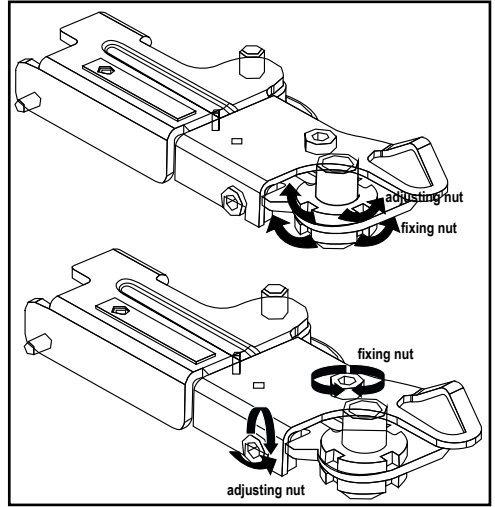

3.4. 电源连接



警告：电源连接中不要使用延长线或多个插座。



警告：损坏的电源线必须由经过授权的服务人员进行更换。



当将两个冷藏室放置在相邻位置时，两个装置之间的距离至少保留4厘米。

- 由于没有接地和电源连接不符合国家规定造成的任何损坏，我们的公司不承担责任。
- 安装后，电源线插头必须位于容易触及的地方。
- 在墙壁插座和冰箱之间不要使用带或不带延长线的多组插头。

3.5. 水源连接

(可选)



警告：连接过程中请拔产品插头和水泵（如果有）。

产品的总水管、净水器和桶装水的连接必须由经过授权的服务人员进行。根据不同的型号，可以将产品连接到桶装水或直接连接到总水管。要建立该连接，必须先

将水管连接到产品。
检查确认以下部件已随您的产品型号一起提供：

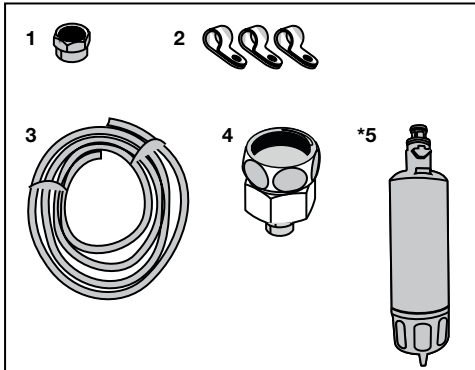

1. 接头（1个）：用于将水管连接到产品的后部。
2. 软管卡夹（3个）：用于将水管固定到墙壁上。
3. 水管（1根，5米长，直径为1/4英寸）：用于连接水源。
4. 龙头接头（1个）：包括多孔净水器，用于连接到冷水总水管。
5. 净水器（1个，*可选）：用于将总水管连接到产品。如果使用桶装水，则不需要净水器。

3.6. 将水管连接到产品

要将水管连接到产品，请遵循以下指示。

1. 拆下产品背面软管喷嘴适配器上的接头，然后将软管穿过接头。

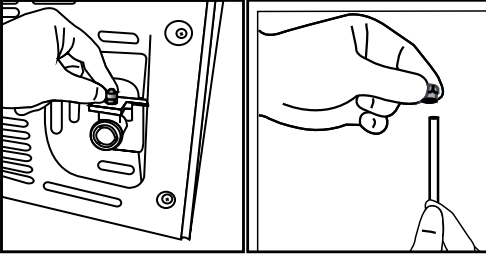

2. 向下压紧水管，然后连接到软管喷嘴适配器上。

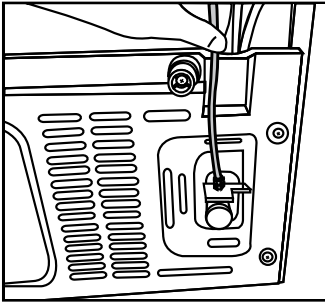

3. 手动扭紧接头，以安装到软管喷嘴适配器上。您也可以使用管钳或老虎钳来扭紧接头。

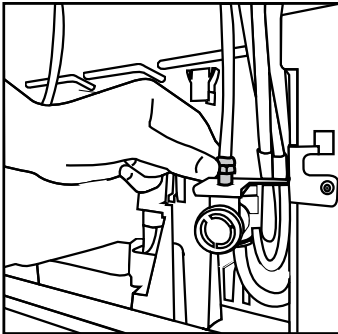

4. 将软管的另一端连接到总水管（参见第 3.7 节），或如果要使用桶装水，则连接到水泵（参见第 3.8 节）。

3.7. 连接到总水管

(可选)

要通过连接到冷水总水管来使用该产品，必须在您的家里的冷水总水管上安装一个标准的 1/2" 阀门接头。如果无法获得该接头或您不太确定，请联系有资质的水管工。

1. 从龙头接头 (2) 上断开该接头 (1)。

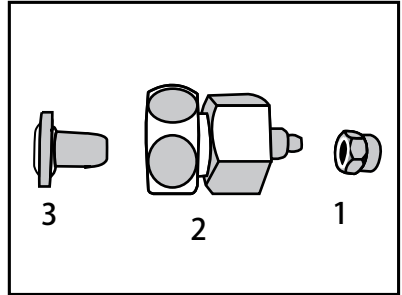

2. 将龙头接头连接到总水管阀门上。

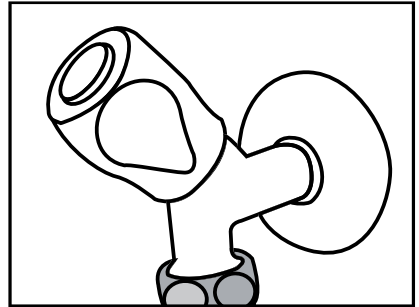

3. 连接水管周围的接头。

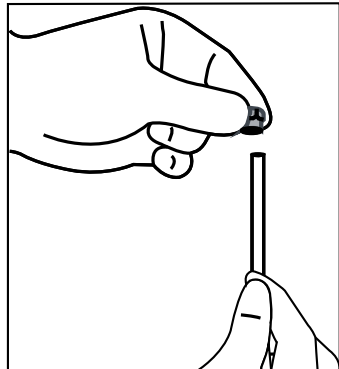

安装

4. 将该接头连接到龙头接头中，然后用手/工具扭紧。

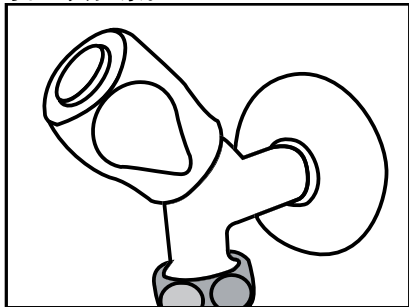

5. 为了避免软管损坏、移位或意外脱落，请使用所提供的卡夹来适当地固定水管。

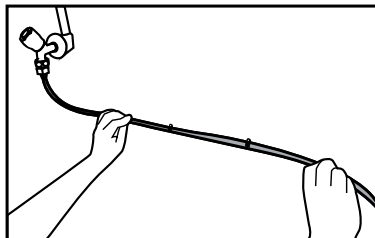

警告：打开龙头后，确保水管的两端都没有漏水。万一漏水，请关闭阀门，然后使用管钳或老虎钳来扭紧所有连接。

2. 将水管的另一端连接到水泵，方法是将软管按压到水泵的软管入口。

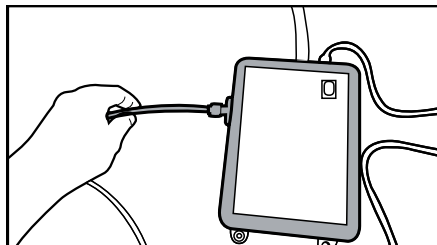

3. 将水泵软管放置并固定到桶装水的水桶内。

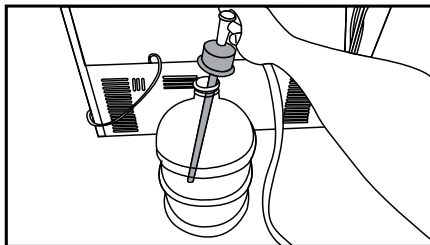

4. 连接好后，插上插头并启动水泵。



启动水泵后，请等待 2-3 分钟以获得所需的功效。



有关水源连接的信息，也可以参阅水泵的用户指南。



使用桶装水时，不需要净水器。

3.8. 对于使用桶装水的产品

(可选)

要将桶装水用于产品的水源连接，必须使用经过授权的服务人员推荐的水泵。

1. 将随水泵一起提供的水管的一端连接到产品（参见第 3.6 节），然后遵循以下指示进行。

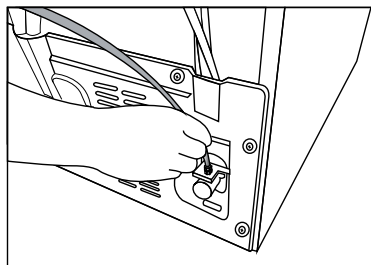

3.9 净水器

(可选)

根据不同型号，产品可能配备有内部或外部净水器。要连接净水器，请遵循以下指示。

安装

3.9.1.在墙壁上安装外部净水器(可选)



警告: 请勿将净水器安装在产品上。

检查确认以下部件已随您的产品型号一起提供:

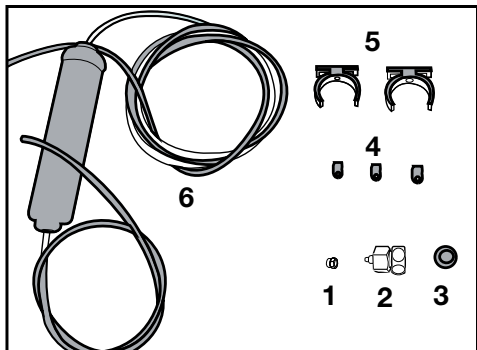

1. 接头 (1 个) : 用于将水管连接到产品的后部。
2. 龙头接头 (1 个) : 用于连接到冷水总水管。
3. 多孔净水器 (1 个)
4. 软管卡夹 (3 个) : 用于将水管固定到墙壁上。
5. 净水器连接设备 (2 个) : 用于将净水器安装到墙壁上。
6. 净水器 (1 个) : 用于将产品连接到总水管。使用桶装水连接时不需要净水器。

1. 将龙头接头连接到总水管阀门上。
2. 决定要安装外部净水器的位置。在墙壁上固定好净水器的连接设备 (5)。

3. 在净水器连接设备上垂直向上安装好净水器, 如标签上所示。(6)

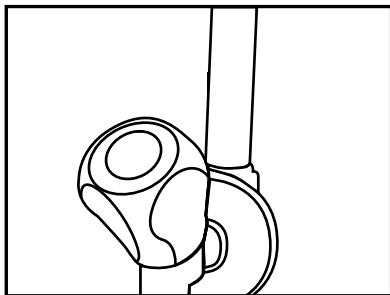

4. 将从净水器顶部伸出的水管连接到产品的水源连接适配器上 (参见第 3.6 节)。

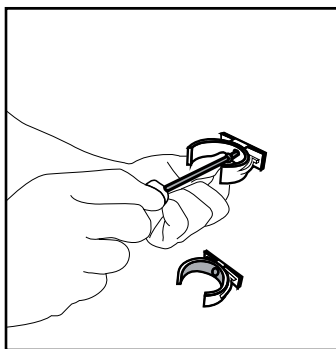

连接好后, 看起来应该如下图所示。

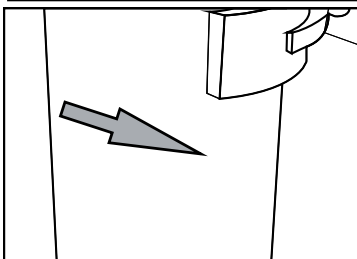
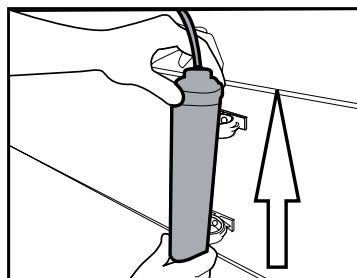

安装

3.9.2.内部净水器

随产品一起提供的内部净水器发货时并未安装好；请遵循以下指示来安装该净水器。

1. 安装净水器时，“冰水关闭”指示灯必须点亮。使用屏幕上的“冰水”按钮可以开关该指示灯。

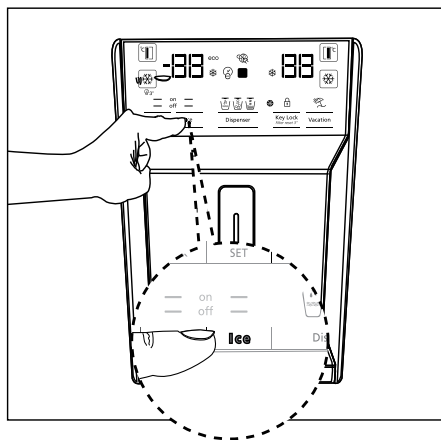
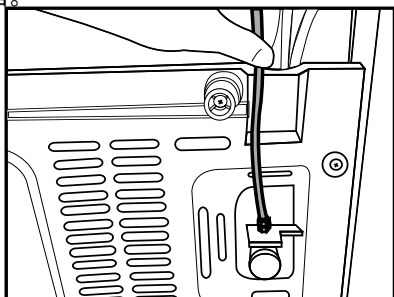

水源路线：

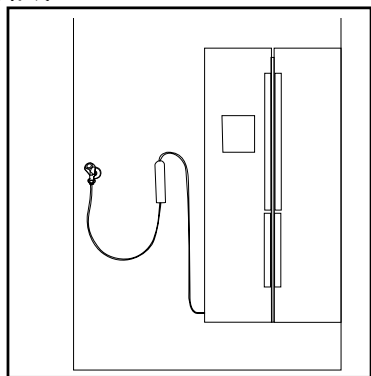

2. 拆下蔬菜盒 (a) 以便能够触及净水器。

桶装水路线：

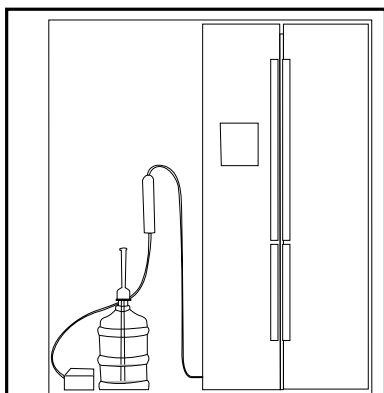

连接好净水器后，不要饮用前面的 10 杯水。

3. 通过拉动拆下净水器的旁通盖板。



拆下盖板后，可能会有几滴水流出来；这是正常的。

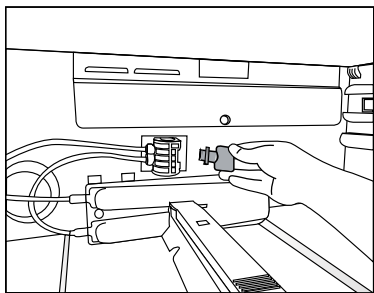

4. 将净水器盖板放置到机械装置中，然后推动锁定到位。

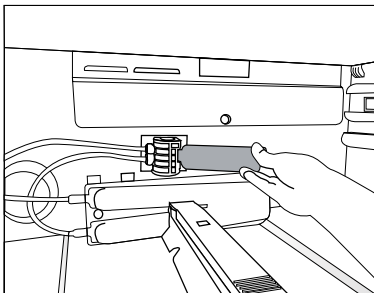

5. 再次按下屏幕上的“冰水”按钮可以取消“冰水关闭”模式。



净水器将过滤掉水中的外来颗粒物。它不会过滤掉水中的微生物。



有关激活净水器更换期的信息，请参阅第 5.2 节。

4 准备

4.1. 节能措施



将产品连接到电子节能系统是有害的，因为这样会损坏该产品。

- 请勿长时间敞开冰箱门。
- 请勿在冰箱内放置热食品或饮料。
- 请勿过量填满冰箱；阻碍内部空气流动会降低制冷能力。
- 冰箱指定的能耗值是在移除冷冻室上部搁架、其他搁架和最下部抽屉保持在位且未达最大装载量的情况下测量而得的。根据要冷冻的食品的形状和大小，可以使用顶部的玻璃搁架。
- 根据产品的功能，在冷藏室内解冻冷冻食品可以确保节能并能够保持食品的质量。
- 请务必使用冷藏室附带的篮子/抽屉，以降低能耗并确保更好的储藏条件。
- 食物与冷冻室中的温度传感器接触可能增加设备的能耗。因此，请避免与传感器的任何接触。
- 请确保食品不会接触如下所述的冷藏室温度传感器。

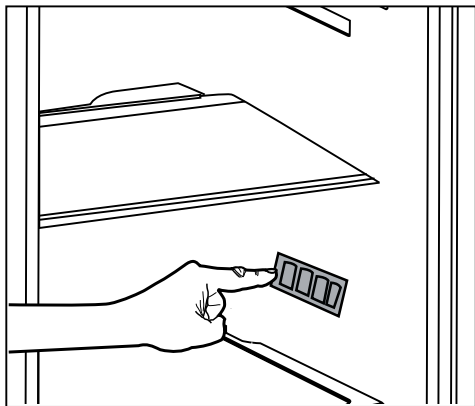

4.2. 首次使用

使用冰箱之前，请确保已根据“安全和环境指示”和“安装”两节中的指示做好必要的准备。

- 在不放入任何食品的情况下，让冰箱运行6个小时，除非完全必要，不要打开冰箱门。



压缩机启动时会听到声音。即使压缩机没有运行，听到声音也是正常的，这是由于冷却系统内的压缩液体和气体造成的。



冰箱的前沿发热是正常的。



在一些机型中，显示屏在门关上后5分钟自动关闭。显示屏将在门打开或按下任何键时被重新激活。

5.1. 指示灯面板

根据您产品型号的不同，指示灯面板可能存在差异。
指示灯面板的声音和视觉功能将有助于冰箱的使用。

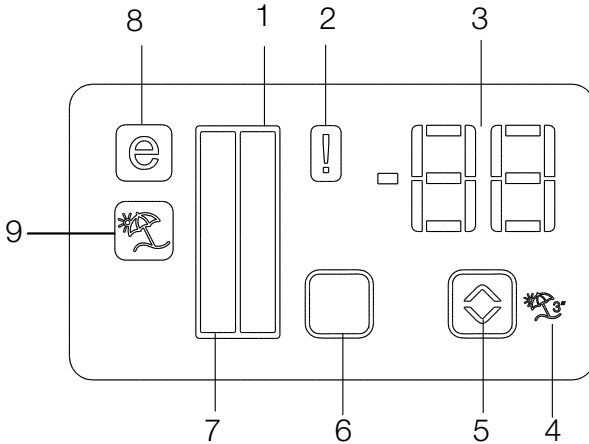

1. 冷藏室指示灯
2. 错误状态指示灯
3. 温度指示灯
4. 假日功能按钮
5. 温度调整按钮
6. 冷却室切换按钮
7. 冷冻室指示灯
8. 经济模式指示灯
9. 假日功能指示灯

* 可选



* 可选：本用户指南中的图仅作参考，可能与您的产品并不完全一致。如果您的产品不包含相关的部件，则该信息适用于其他型号。

1. 冷藏室指示灯

当调节冷藏室温度时，冷藏室的灯将点亮。

2. 错误状态指示灯

如果冰箱冷却不充分或万一传感器出现故障，则此传感器将激活。当此指示灯点亮时，冷冻室温度指示灯将显示“E”，冷藏室温度指示灯将显示“1, 2, 3...”数字。指示灯上的数字用于告知服务人员相关故障。

3. 温度指示灯

指示冷冻室和冷藏室的温度。

4. 假日功能按钮

要激活此功能，请按住“假日”按钮3秒钟。当假日功能被激活时，冷藏室温度指示灯将显示字符“- -”，且此时冷藏室内无制冷。此功能不适合于将食品保存在冷藏室中。其他各室将保持制冷，其中的温度就是为各室所设置的各自的温度。

冷冻室仍然保持制冷状态，面板上的温度为冷冻室的制冷温度能。再次按下假日按钮可以取消此功能。

5. 温度调节按钮

各室的温度不同，在 -24°C -18°C 和 8°C ... 1°C 范围内。

6. 冷却室选择按钮

使用冰箱的冷却室选择按钮可以在冷藏室和冷冻室之间进行切换。

7. 冷冻室指示灯

当调节冷藏室温度时，冷冻室的灯将点亮。

8. 经济模式指示灯

指示冰箱正在节能模式下运行。当冷冻室内的温度设置为 -18°C 时，此指示灯将点亮。

9. 假日功能指示灯

指示假日模式被激活。

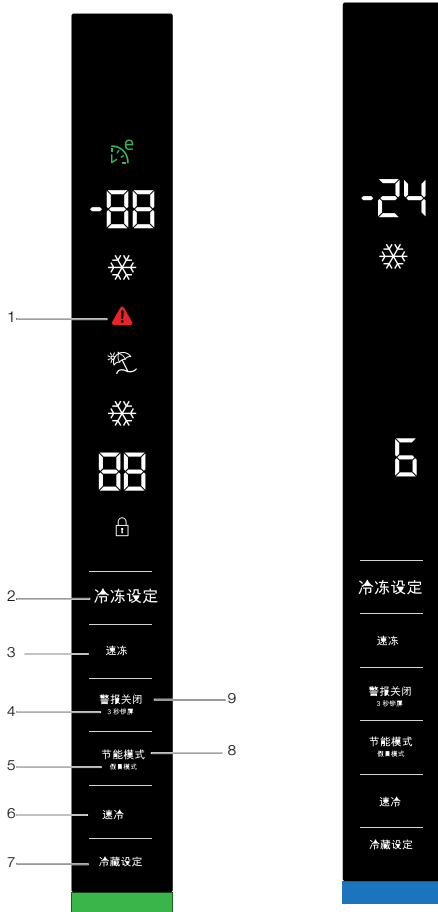

 绿色：显示屏关闭/节能模式

 红色：高温/冰箱门开启

 蓝色：迅速冷冻/迅速冷藏

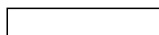
 白色：与产品互动/
按下任何按键后显示屏开启

 黄色：假期



* 可选：本用户指南中的图仅用作草稿，可能与您的产品并不完全一致。如果您的产品不包含相关的部件，则该信息适用于其他型号。

使用产品

- 1- 电源故障/高温/错误警告
- 2- 冷冻室温度设置
- 3- 快速冷冻
- 4- 按键锁
- 5- 假日功能
- 6- 快速冷藏
- 7- 冷藏室温度设置
- 8- Eco fuzzy
- 9- 报警器关闭警告

- 高温警告：红色（每秒闪烁一次）
- 在1分钟内。在冰箱门开启后（当冰箱门开启后，警报启动），红灯亮起。
- 当冰箱门开启后：白色
- Eco模式绿色
- 快速冷冻：蓝色
- 快速冷藏：蓝色
- 假日：黄色
- 关闭显示：绿色
- 冰箱门关闭后，若启动白色/Eco模式、快速冷冻、快速冷藏、假日模式中的一项，则该模式的颜色将显示1分钟。（模式的颜色比该显示状态更突出）。

1.电源故障/高温/错误警告

在电源故障、高温故障和错误警告期间，此指示灯亮起。电源长期故障期间，冷冻室达到的最高温度将在数字显示屏上闪烁。检查冷冻室中的食物后，按下报警器关闭按钮，清除警报。

如果您注意到指示灯亮起，请参阅手册中“故障检修建议措施”一节。

2.冷冻室温度设置

温度设置适用于冷冻室。按下该按钮，将冷冻室的温度分别设置为-18度、-19度、-20度、-21度、-22度和-24度。

3.快速冷冻

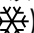
按下该按钮进行快速冷冻，快速冷冻指示灯()将亮起。

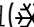
快速冷冻功能启动后，且冷藏室温度指示灯显示为-27度时，快速冷冻指示灯亮起。若要取消该功能，再次按下快速冷冻按钮()。快速冷冻指示灯将熄灭，且

冰箱恢复正常设置。如果没有取消，快速冷冻功能将在24小时后自动取消。如果您想冷冻大量的新鲜食物，将食物放入冷冻室前，请按下“快速冷冻”按钮。

4.按键锁

将关闭警报按钮按住3秒钟。按键锁符号将亮起，并且按键锁将启动；按键锁启动后，按钮将不工作。将关闭警报按钮按住3秒钟。按键锁符号将熄灭，按键锁模式将不工作。

5.假日功能

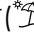
若要激活假日功能，按下该按钮3秒钟；假日模式指示灯()将亮起。假日功能启动后，冷藏室的温度指示灯上显示“- -”，冷藏室不会进行制冷。在该功能启动时，不适宜在冷藏室存放食物。其它隔间将根据设置的温度继续制冷。

若要取消该功能，再次按下假日功能按钮。

6.快速冷藏

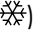
启动快速冷藏功能后，快速冷藏指示灯将亮起()并且冷藏室温度指示灯显示为1。若要取消该功能，再次按下快速冷藏按钮。快速冷藏指示灯将熄灭，且冰箱将恢复正常设置。如果没有取消，快速冷冻功能将在1小时后自动取消。如果您想冷藏大量的新鲜食物，将食物放入冷藏室前，请按下快速冷藏按钮。

7.冷藏室温度设置

按下该按钮后，冷藏室温度可以分别设定为8度、7度、6度、5度、4度、3度、2度和1度。

8.Eco fuzzy

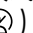
按住eco fuzzy按钮1秒钟，启动eco fuzzy功能。冰箱稍后将至少以最节能的模式运行6小时，节能模式指示灯将亮起()。按住eco fuzzy按钮3秒钟，取消eco fuzzy功能。

在eco fuzzy功能启动6小时后，指示灯将亮起。

9.报警器关闭警告

如果出现断电/高温警报，在检查放置在冷冻室的食物后，按下报警器关闭按钮，清除警告。

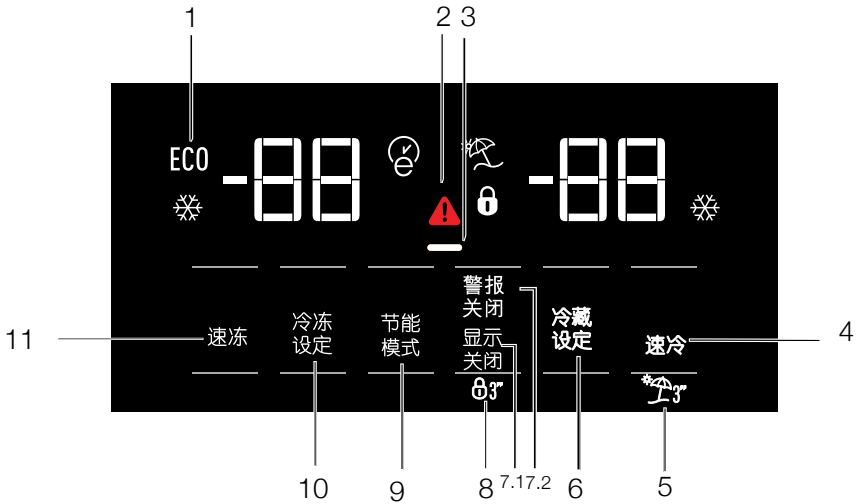

1. 节能模式指示灯
2. 高温/故障指示灯
3. 显示屏开/关指示灯
4. 快速冷藏
5. 假日功能
6. 冷藏室温度设置
7. 显示关闭/警报关闭
8. 童锁3秒
9. 节能模式
10. 冷冻室温度设置
11. 快速冷冻



* 可选：本用户指南中的图仅用作草稿，可能与您的产品并不完全一致。如果您的产品不包含相关的部件，则该信息适用于其他型号。

使用产品

1. 节能模式指示灯

冷冻室设置为-18° C时，此符号将会亮起，这是最节能的设定值。(ECO)选择快速制冷或快速冷冻功能时，节能使用指示灯将会熄灭。

2. 显示屏开/关指示灯

如果出现温度故障或故障警示，此指示灯(▲)将亮起。

在电源故障、高温故障和错误警告期间，此指示灯亮起。电源持续故障期间，冷冻室达到的最高温度将在数字显示屏上闪烁。检查冷冻室中的食物后，按下报警器关闭按钮，清除警报。

3. 显示屏开/关指示灯

如果长时间关闭冰箱门，节能功能将自动启动，且节能符号将亮起。节能功能启动后，显示屏上除节能符号以外的所有符号均将熄灭。节能功能启动后，如果按下任何按钮，或打开冰箱门，将取消节能功能，且显示屏上的符号将恢复正常。节能功能在出厂时已经激活，且无法取消。

4. 快速冷藏

快速制冷功能启动后，快速制冷指示灯将会亮起(❄️)而且冷藏室温度指示灯会显示数值1。再次按下迅速冷却按钮取消此功能。迅速冷却指示灯将熄灭并恢复正常设置。除非由用户取消，迅速冷却功能将会在1小时候自动取消。若要冷却大量新鲜食物，在将食物放进冷藏室前按下快速冷却按钮。

5. 假日功能

按住快速冷藏按钮3秒钟启动功能；这将点亮闲置模式指示灯(⏸️)。启动闲置功能后，冷藏室温度指示灯会显示“- -”字样，冷藏室内的冷藏过程不会起效。启动该功能时不适宜在冷藏室存放食物。其他隔间将会依据各个隔间分别设定的温度保持冷藏。再次按下闲置功能按钮取消此功能。

6. 冷藏室温度设置

按下按钮后，冷藏室温度可以分别设定为8度、7度、6度、5度、4度、3度、2度和1度。(🌡️)

7.1 显示关闭

按下该按钮(⏸️)后，将点亮节能符号(—)并且将启动节能功能。启动节能功能将会关闭显示屏上的所有其它标志。启动节能功能时，按下任何按钮或打开冰箱门将取消节能功能，并且显示屏标志将会恢复正常。再次按下此按钮(⏸️)将会关闭节能标志并且取消节能功能。

7.2 警报关闭

如果出现断电/高温警报，在检查放置在冷冻室的食物后，按下报警器关闭按钮，清除警告。

8. 童锁3秒

按住“显示关闭按钮3秒钟。按键锁符号将会亮起，并启动按键锁；按键锁启动后，按钮将不工作。再次按住显示关闭按钮3秒钟。按键板锁定图标将熄灭，并将退出按键板锁定模式。按下显示屏关闭按钮，防止修改冰箱的温度设置。

9. ECO节能模式

按住Eco-Fuzzy按钮1秒钟，启动Eco-Fuzzy功能。启动此功能时，冰箱将在至少6小时候后切换到节能模式，而且节能使用指示灯将会亮起。按住Eco-Fuzzy功能按钮3秒钟，取消(ⓧ)Eco-Fuzzy功能。

启动Eco-Fuzzy功能6小时后，指示灯将会亮起。

10. 冷冻室温度设置

冷冻室的温度是可以调节的。按下按钮数字可将冷冻室温度设置为-18度、-19度、-20度、-21度、-22度和-23度和-24度。

11. 快速冷冻

若要快速制冷，按下按钮；这将点亮快速制冷指示灯 (❄️)。

当启动迅速冷冻功能时，迅速冷冻指示灯会亮起，而且冷冻室温度指示灯将会显示数值-27。再次按下快速冷冻按钮(❄️) 取消该功能。迅速冷冻指示灯将熄灭并恢复正常设置。除非由用户取消，否则迅速冷冻功能将会在24小时候自动取消。若要冷冻大量新鲜食物，在将食物放进冰箱隔间前按下迅速冷冻按钮。

5.2. 除臭模块

(FreshGuard)

(该功能可选)

该模块可迅速地消除冰箱中的难闻气味，以免它们渗入食物表面。该模块位于冷藏室顶部，冷藏室内部的异味空气在该模块作用下，循环分解过滤成为清新空气。这样，存储食物期间可能在冰箱中产生的异味将在渗入食物表面之前即被消除。

在日常使用中，除异味模块将定期每 48 小时自动激活 2 小时。

由于该模块中含有风扇，在操作过程中听到噪音属于正常现象。如果在此模块处于激活状态的情况下打开新鲜食物隔间的门，风扇将暂时停止工作，并且将在门再次关闭时继续操作。如发生断电，除异味模块将在通电恢复时从断电状态恢复操作，直至总运行时间达到 2 小时。

提示信息：建议将带有香气的食物（例如乳酪、橄榄和熟食）存储在其包装中并密封，以免当不同食品的气味混合在一起时可能产生异味。为了保证其他食物的安全和异味的产生，我们建议您尽快将可能已经变坏的食物从冰箱中取出。

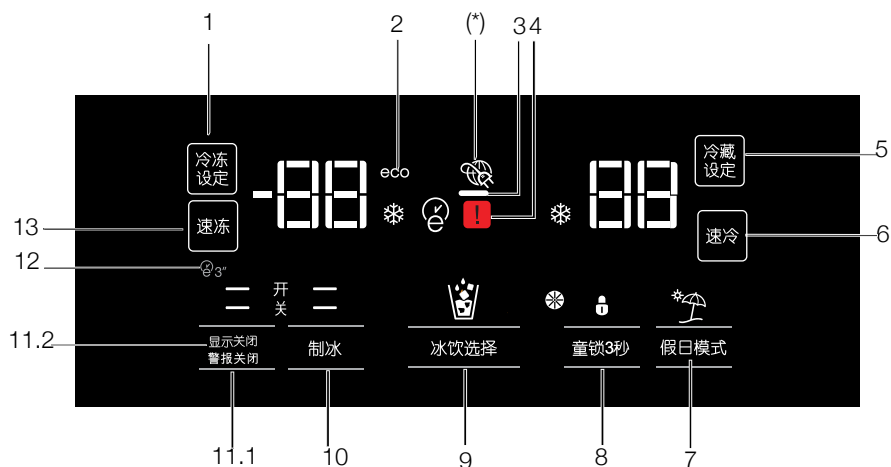

1. 冷冻室温度设置
2. 节能模式指示灯
3. 显示屏开/关指示灯
4. 高温/故障指示灯
5. 冷藏室温度设置
6. 快速冷藏
7. 假日模式
8. 童锁3秒/滤芯更换提醒
9. 冰饮选择
10. 制冰开/关
11. 显示关闭/警报关闭
12. 节能模式
13. 快速冷冻



* 可选：本用户指南中的图仅用作草稿，可能与您的产品并不完全一致。如果您的产品没有包含相关的部件，则该信息使用于其他型号。

使用产品

1. 冷冻室温度设置

按下按钮(❄️) will enable 冷冻室温度将设置为-18度、-19度、-20度、-21度、-22度、-23度、-24度、-18度

2. 节能模式指示灯

显示冰箱正在节能模式下运作。冷冻室温度设置为-18度时，或通过额外节能功能执行节能制冷时，该指示灯将亮起。(ECO)

3. 显示屏开/关指示灯

如果长时间关闭冰箱门，节能功能将自动启动，且节能符号将亮起。节能功能启动后，显示屏上除节能符号以外的所有符号均将熄灭。节能功能启动后，如果按下任何按钮，或打开冰箱门，将取消节能功能，且显示屏上的符号将恢复正常。节能功能在出厂时已经激活，且无法取消。

4. 电源故障/高温/错误警告指示灯

如果出现温度故障或故障警示，此指示灯(⚠️)将亮起。

在电源故障、高温故障和错误警告期间，此指示灯亮起。电源持续故障期间，冷冻室达到的最高温度将在数字显示屏上闪烁。检查冷冻室中的食物后，按下报警器关闭按钮，清除警报。

5. 冷藏室温度设置

按下按钮(🌡️)后，冷藏室温度可分别设定为8度、7度、6度、5度、4度、3度、2度。

6. 快速冷藏

若要快速制冷，按下按钮；这将点亮快速制冷指示灯(❄️)。

再次按下此按钮，解除此功能。

将新鲜食物放入冷藏室或迅速冷却食物时使用此功能。启动此功能时，冰箱将共作1小时。

7. 假日模式

启动功能(🏠)后，冷藏室温度指示灯会显示“-”字样，冷藏室内的冷藏过程不会起效。启动该功能时不适宜在冷藏室存放食物。其他隔间将会依据各个隔间分别

设定的温度保持冷藏。

再次按下功能取消该功能。(🏠)

8. 童锁3秒/滤芯更换提醒

按下按键板锁定按钮(🔒)启动按键板锁定。您也可以使用该功能以防更改冰箱的温度设置。冰箱的过滤器须每6个月更换一次。若您遵循第5.2节的说明，冰箱将自动计算剩余时间，过滤器过期后，过滤器更换提醒指示灯(🌀)将亮起。

按住按钮(🌀)3秒钟关闭过滤器提醒灯。

9. 冰饮选择

按下按钮8浏览水(💧)、冰块(🧊)以及碎冰(🧊/💧)选择。启动指示灯将会保持亮起。

10. 制冰开/关

按下按钮(❄️)取消(off —)或启动(on —)制冰。

11.1 显示屏“开/关

按下“显示屏”关闭按钮且(— off)功能灯点亮时，显示屏的所有其他图标均熄灭，显示屏进入能量节省模式。再次按下“显示屏”关闭按钮且(— on)功能灯点亮时，显示屏的所有其他图标均亮起，显示屏退出能量节省模式。

11.2 警报关闭

如果出现断电/高温警报，在检查放置在冷冻室的食物后，按下报警器关闭按钮，清除警告。

12. 节能模式

按住自动eco按钮(🌿)3秒钟便可启动该功能。启动此功能时如果冷藏室门长时间保持关闭，冷藏室将自动切换到节能模式。再次按下按钮取消此功能。

自动节能功能启动6小时后，指示灯将会亮起。(🌿)

13. 快速冷冻

按下按钮(❄️)进行快速冷冻。再次按下按钮取消此功能。

5.3. 激活更换滤水器警告

(适用于连接主水管和配备有滤水器的产品)

激活更换滤水器警告步骤如下：

自動計算篩選器使用時間不會在工廠出貨時啟用。
它必須在配備有篩選器的產品中啟用。

我們在冰箱中使用的 S4 顯示板含有九鍵系統。
在顯示畫面中顯示設定值。

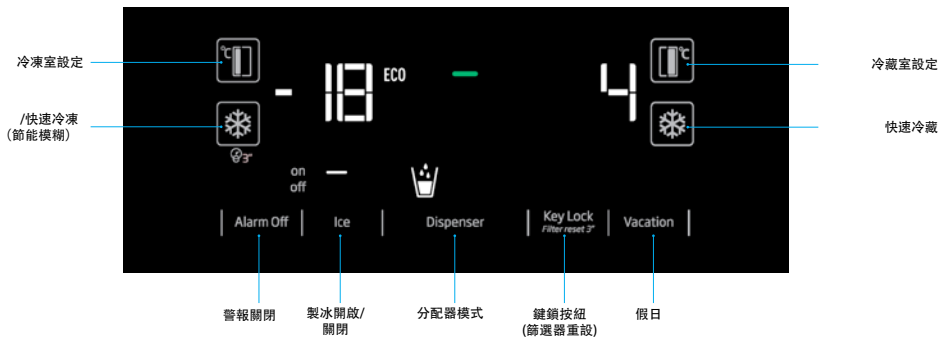

* (按下 3 秒)

接上電源之後，按下「警報關閉」和「假日」按鈕 3 秒即可進入密碼登錄畫面。



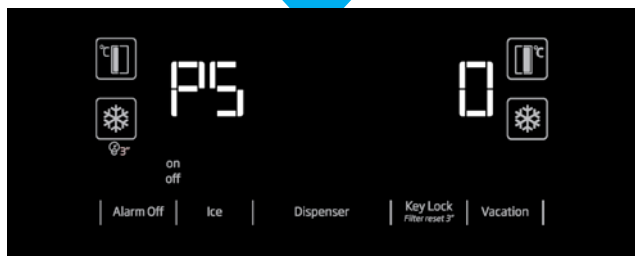
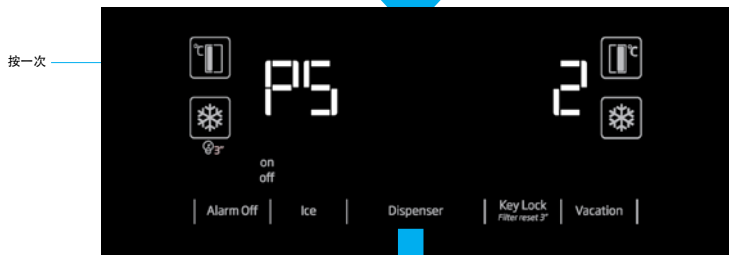

“看到 PS 0 界面后，给冰箱断电并再次通电。以此方式将启动滤水器计数器。滤水器警告 LED 灯在显示屏上将亮起 130 天。在更换新滤水器后，按下按键锁定按钮 3 秒钟，使滤水器计数器从 130 天起开始倒读数。要取消此功能，请重复上述步骤。”



当滤水器警告灯亮起时，按下 3 秒钟即可重置过滤时间。

5.4. 使用饮水机

(对于某些型号)



从饮水机中接出的前面几杯水正常情况下是温的。



如果长时间不使用饮水机，请倒掉前面的几杯水后才能得到干净的水。

首次运行时，您必须等待大约 12 个小时才能得到冷水。
使用显示器来选择水的选项，然后拉动取水开关即可取水。拉动取水开关后立即移开水杯。

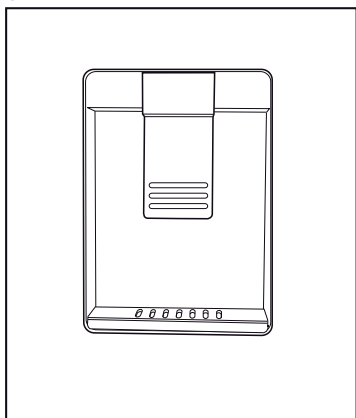

5.5. 加注饮水机水箱

打开水箱盖，如图所示。加入纯净和干净的饮用水。关上水箱盖。

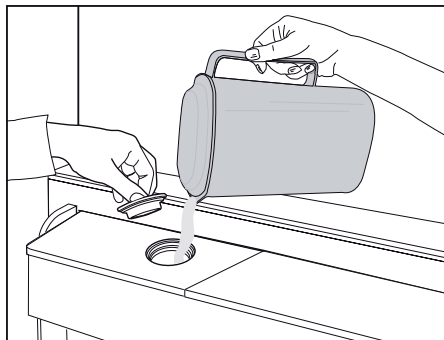

5.6. 湿度控制蔬菜盒

*可选

使用湿度控制功能，蔬菜和水果的湿度水平保持在控制水平，确保更长的保鲜期。

建议存放容易丧失水分的带叶蔬菜，例如，莴苣和菠菜和类似蔬菜，但应尽量呈水平位置放置在蔬菜盒中。

放置蔬菜时，鉴于蔬菜的比重，较重和较硬的蔬菜放在底部，较轻和较软的蔬菜放置在顶部。

放在蔬菜盒中的蔬菜应从塑料袋中取出。留在塑料袋中将导致蔬菜短时间腐烂。考虑到卫生问题，不希望某种蔬菜与其他蔬菜接触时，可以使用透气的纸质包装材料。

请勿将乙烯气体产生量高的水果与其他蔬菜和水果放入相同的果蔬盒中，例如，梨、杏、桃子，尤其是苹果。这些水果释放出的乙烯气体将导致其他蔬菜和水果加速成熟和在更短时间内腐烂。

5.7. 清洁水箱

拆下冰箱门搁架内的注水容器。

通过握住冰箱门搁架的两侧来拆卸。

握住水箱的两侧，然后在 45° 角处拆下。

拆下并清洗水箱盖。

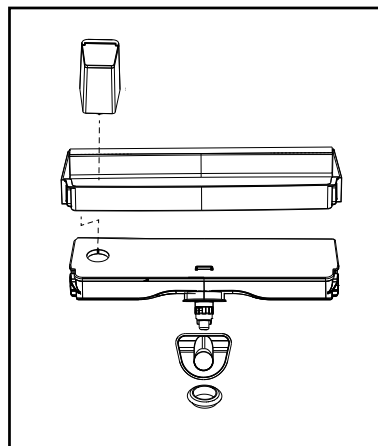
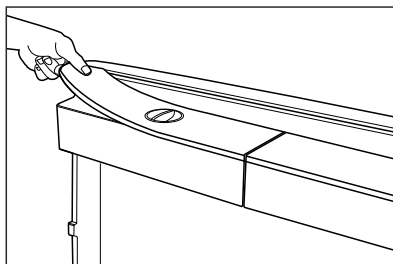
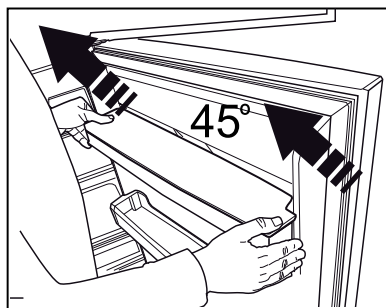
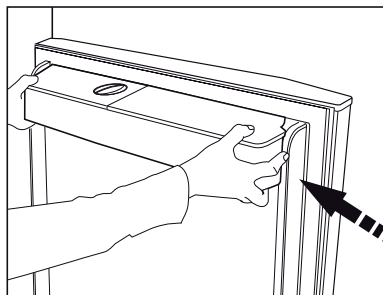

请勿将果汁、泡沫饮料、酒精饮料或其他任何与饮水机的使用不兼容的液体注入到水箱中。使用这些液体会导致故障或造成饮水机不可修复的损坏。如果这样使用饮水机，将不属于保修范围。此类饮料/液体中的某些化学品和添加剂可能会导致水箱材料的损坏。



水箱和饮水机的部件不能使用洗碗机来进行清洗。

使用产品

5.8. 饮用冰/水

(可选)

要饮用水 (🍵) / 冰块 (🧊) / 碎冰 (🧊🍵)
请使用显示屏来选择相关的选项。通过向前按压饮水机上的取水开关可以获得水/冰。在冰块 (🧊) / 碎冰 (🧊🍵) 选项之间进行切换时，先前的冰类型可能还会流出几次。

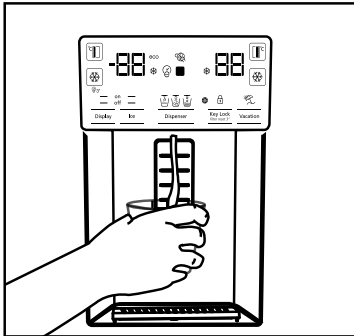

- 首次使用时，您必须等待大约 12 小时后才能从冰/水饮水机中获得冰。如果冰盒内没有足够的冰，则饮水机可能无法排放出冰来。
- 首次运行时，不能使用获取 30 块冰块 (3-4 升) 的功能。
- 万一出现断电或临时故障，可能会部分融化并再次结冰。这样会导致冰块融合到一起。万一出现较长时间的断电或故障，并可能会融化并漏出。如果碰到此类问题，请清除冰盒内的冰并清洗冰盒。



警告: 产品的供水系统只能连接到冷水管路。请勿连接到热水管路。

- 首次运行时，产品可能不会排放出水来。这是由于系统中存在空气而造成的。必须排干系统中的空气。要完成此任务，请按下饮水机的取水开关 1-2 分钟，直到饮水机排出水为止。最初的水流可能是不规则的。一旦系统中的空气排干后，水流将会变得正常。
- 首次使用净水器时水可能是浑浊的，请勿饮用前 10 杯水。

- 首次安装后，您必须等待大约 12 个小时才能得到冷水。
- 产品的水系统的设计目的仅用于干净水。请勿使用其他任何饮料。
- 假期等期间，如果长时间不使用该产品，建议断开水源。
- 如果长期不使用饮水机，则接到的第 1-2 杯水可能是温的。

5.9. 承水盘

(可选)

从饮水机滴出的水聚集在承水盘中；没有提供排水装置。向外拉动承水盘或按住其边缘可以取下承水盘。然后即可倒掉承水盘内的水。

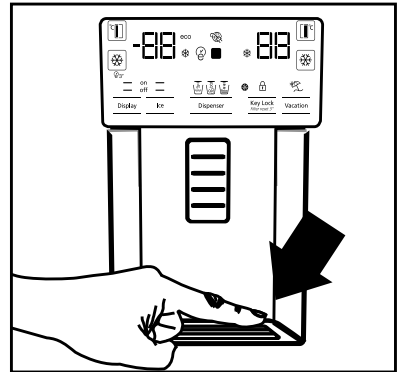

5.10. 零度冷藏室

(可选)

使用此冷藏室可以低温保存熟食或即将食用的肉制品。请勿将水果和蔬菜放入此冷藏室中。可以通过取下零度冷藏室来扩大冰箱的内部容量。要取下该冷藏室，只需向外拉动，向上抬起并取出。

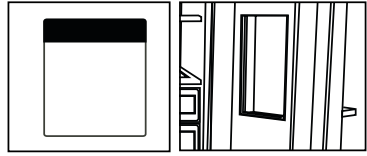

5.11. 蔬菜盒

冰箱的蔬菜盒设计用于通过保持湿度来保证蔬菜的新鲜。为此，蔬菜盒内冷空气的流动性比较强。请将水果和蔬菜保存在此室内。分开保存绿叶蔬菜和水果可以延长它们的寿命。

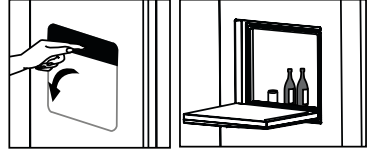

5.12. 蓝光

(可选)

产品的蔬菜盒内含有蓝光。蔬菜盒内的蔬菜在蓝光波长的作用下将继续进行光合作用，从而可以保持活力和新鲜。

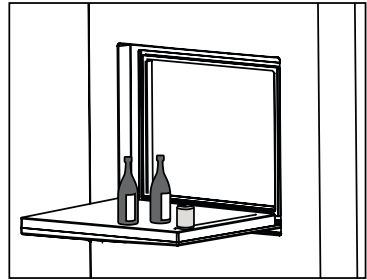

5.13. 离子发生器

(可选)

冷藏室空气管内的离子发生器系统用于对空气进行离子化。释放出的负离子将清除造成空气发臭的细菌和其他微生物。

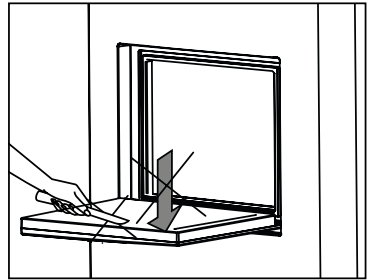

5.14. 迷你吧

(可选)

冰箱的迷你吧的门搁架在不打开冰箱门的情况下也可以存取。这样可以方便地从冰箱中存取经常消费的食品和饮料。要打开迷你吧盖板，请用手按住盖板，然后朝您自己的方向推出。

5.15. 除味器

(可选)

冷藏室空气管内的除味器可以防止形成不需要的异味。



警告: 请勿在迷你吧盖板上悬挂或放置重物。这样可能会损坏产品或导致您受伤。

要关闭此室，只需向前推动盖板的上部。

5.16. 制冰盒和冰储藏柜

(可选)

给制冰盒加入水并放置到位。两个小时后即可形成冰。请勿拆下制冰盒来取冰。

向右旋转冰盒上的按钮 90° ；冰就会掉入下面的冰储藏柜中。然后可以取出冰储藏柜并取用冰。



冰储藏柜只能用于保存冰。请勿注入水。这样做可能会导致它破裂。

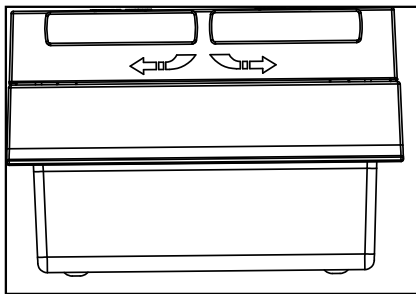
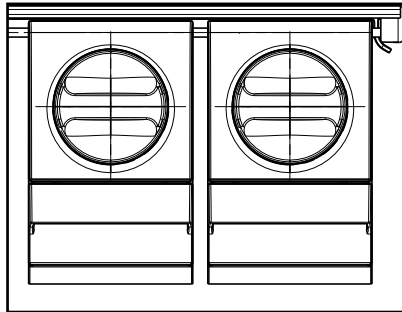

5.17. 制冰器

(可选)

制冰器位于冷冻室盖的上部。

握住冰储藏容器两侧的把手，然后向上移动即可拆下。

向上移动拆下制冰器的装饰盖。

操作

拆卸冰盒

通过把手握住储冰盒，而后向上移动和拉动储冰盒。（图1）

重新安装冰盒

通过把手握住储冰盒，倾斜向上移动，将储冰盒的侧边安装到

窄槽，确保适当安装冰选择器销。（图2）

用力向下按，直至储冰盒与塑料门之间没有空间。（图2）

如果难以重新安装储冰盒，将旋转转子转动 90° ，并重新安装，如图3所示。

冰块掉落到冰盒时，您如果听到任何声音，都是正常操作的一部分。



使用产品

冰分配器没有适当工作时
如果您长时间没有取出冰块，将导致形成大冰块。这种情况下，请根据上面给出的说明，取出储冰盒，分离大冰块，



废弃不可分离的冰块，将冰块放回储冰盒。
(图4)



初次使用冰箱或长时间未使用时
由于连接后管道中会有空气，所以，冰块可能很小，而在正常使用中，将冲洗掉所有空气。
由于水管可能含有污垢，所以，废弃大约一天内制作的冰块。

小心!

请勿在冰槽中插入手指或任何其它物体，否则，可能损坏零件或

冰块无法取出时，检查是否有任何冰块卡在槽中，并清除之。定期检查制冰槽，并清除障碍物，如图5所示。



伤害手指。

儿童不得吊挂在冰分配器或制冰器上，否则，可能导致受伤。

为了防止储冰盒掉落，拆卸时，应使用双手。如果用力关闭冰箱门，可能导致水溅在储冰盒上。

除非必要，否则，请勿拆卸储冰盒。

如果取碎冰时被锁定（即冷藏室不出冰），请尝试取冰块。

然后可再次取碎冰。

在取碎冰时，可能先出冰块。在取碎冰时，可能伴有碎冰。

位于制冰机正面的冷冻室门上可能会结一层薄霜。

这是正常的，建议缩短清洁周期。

饮水机下方区域的格栅中会及时注水。应定期对其进行清洁。建议定期清洁此区域内的水。当冰从储冰盒中落下时，发出声音是正常的，这并不表示产品存在问题。

储冰盒内的搅拌叶片装置很锋利，可能割伤手。

如果配冰器不出冰，则可能是因为冰粘连在一起，取下冰盒重新清洁。

当您按下制冰触发器以获取冰块时，无法在显示屏上更改制冰类型。松开触发器，在显示屏上更改制冰类型，然后再次获取冰块。

5.18. 冷冻新鲜食品

- 为了保持食品质量，必须尽快冷冻放置在冷冻室中的食品，请使用快速冷冻来实现这一目的。
- 冷冻食品可以延长冷冻室中食品的保存时间。
- 将食品包装在空气稀少的包装袋中并密封好。
- 确保食品包装好后在放入冷冻室。请使用冷冻室容器、锡纸和防潮纸、塑料袋或类似的包装材料，而不是传统的包装纸。
- 确保在每种食品包装袋上写上日期，然后再进行冷冻。这样可以确保您每次打开冷冻室时能够了解每种食品的新鲜程度。将时间较长的食品放在前面，以确保首先食用它们。
- 冷冻食品在解冻后必须马上食用，不能再次冷冻。
- 请勿一次取出大量的食品。

5.19. 保存冷冻食品的建议

- 冷冻室的温度必须设置为至少 -18°C 。
1. 尽快将食品放入冷冻室中，以防止解冻。
 2. 冷冻之前，请检查包装袋上的“过期日期”，以确保食品尚未过期。
 3. 确保食品的包装没有损坏。

5.20. 深度冷冻详细信息

根据 IEC 62552 标准，对于每个 100 升容量的冷冻室，必须具有 24 小时以内在 -18°C 或更低温度下冷冻 4.5 千克食品的能力。只有在 -18°C 及其以下的温度，食品才能延长保存。您可以保持食品新鲜数个月（在 18°C 及其以下温度的深度冷冻下）。

要冷冻的食品不能接触冷冻室内已经的食品，以避免造成其部分解冻。

冷冻室设置	冷藏室设置	说明
-18°C	4°C	这是默认的推荐设置。
-20°C 、 -22°C 或 -24°C	4°C	这些设置是针对周围温度超过 30°C 时的推荐值。
快速冷冻	4°C	请使用这些设置在短时间内冷冻食品，该过程完成后，冰箱将恢复到以前的设置。
-18°C 或更冷	2°C	如果由于周围温度或经常打开冰箱门的原因，您认为冷藏室内的温度并不够冷，也可使用这些设置。冰箱 / 用户指南

使用产品

煮熟蔬菜和净化水可以延长冷冻食品的保存时间。净化后将食品放置到空气稀薄的包装袋中，然后放到冷冻室内。香蕉、西红柿、莴苣、芹菜、煮熟的鸡蛋、土豆和类似食品不能冷冻。冷冻这些食品会降低营养价值和食品质量，还可能会变质，对健康造成损害。

5.21. 放置食品

冷冻室搁架	各种冷冻食品，包括肉类、鱼类、冰激淋、蔬菜等
冷藏室搁架	放在锅中、盖上盖的盘子和盒子中的食品、鸡蛋（在盖上盖的箱子中）
冷藏室门搁架	体积小且包装好的食品或饮料
蔬菜盒	水果和蔬菜
新鲜食品室	熟食（早餐食品、短期内将使用的肉制品）

5.22. 门打开提示

(可选)

如果产品的门保持打开 1 分钟，则会发出提示音。关上门或按下显示屏（如果有）上的任何按钮后，提示音将停止。

5.23. 内灯

内灯使用的是 LED 型灯。如果此灯出现任何问题，请联系经过授权的服务人员。

此电器中使用的灯不适合家庭房间照明。这种灯的预期用途是帮助使用者安全舒适地将食物放入冰箱/冰柜。

6 维护和清洁

定期清洁冰箱将会延长其服务寿命。



警告: 清洁冰箱之前, 请断开电源。。

- 清洁时, 请勿使用锋利的研磨器具、肥皂、家用清洁剂、洗涤剂、气体、汽油、蜡光剂和类似物质。
- 在水中化入一茶匙苏打。在水中浸湿一块抹布并将其拧出。使用这块抹布来擦洗冰箱, 然后彻底擦干。
- 小心不要让水进入灯罩和其它电气部件。
- 对于非无霜型产品, 冷藏室的后壁会出现水滴和最大可达一指宽度的霜花。请勿对后壁进行清洁; 切勿向后壁涂抹油类或类似制剂。
- 只能使用略微润湿的超细纤维布清洁产品的外表面。海绵和其他类型的清洁布可能会刮伤该表面。
- 使用湿抹布清洁冰箱门。取出内部的所有东西, 拆下冰箱门搁架和底座搁架。向上提取门搁架即可将其取出。清洗并擦干搁架, 然后从上面向下滑动, 将其放回原位。
- 请勿在冰箱的外部表面或镀铬部件上使用氯水或清洁产品。氯会使这些金属表面生锈。

6.1. 防止异味

产品有没有任何异味的材料制成。但是, 如果在不适当的部分保存食品以及清洁内部表面不当, 可能会产生异味。为了避免产生异味, 每 15 天请使用苏打来清洁冰箱内部一次。

- 将食品保存在密封的容器中。没有密封的食品可能会散发出微生物, 并造成异味。
- 请勿在冰箱内保存过期和变质的食品。
- 不要使用锐物和研磨工具或肥皂、家居清洁剂、洗涤剂、汽油、苯、蜡等, 否则塑料部件上的印章将会被擦掉, 并且发生变形。用温水和软布清洗并擦干。

6.2. 保护塑料表面

泼洒到塑料表面的油可能会造成这些表面的损坏, 必须使用热水立即进行清洁。

7 故障排除

联系服务人员之前，请检查此清单。这样做将节省您的时间和金钱。此清单包括与工艺和材料故障无关的一些常见的投诉。这里提及的某些功能可能不适用于您的产品。

冰箱不工作。

- 电源插头没有插好。>>> 将插头完全插入插座中。
- 连接到为冰箱提供电源的插座的保险丝或主电源保险丝已烧断。>>> 检查保险丝。

冷藏室侧壁上出现冷凝水（多功能区、冷藏区、控制区和变温区）。

- 环境过冷。>>> 请勿将产品安装在温度低于 -5°C 的环境中。
- 冰箱门打开过于频繁 >>> 不要过于频繁地打开冰箱门。
- 环境过于潮湿。>>> 请勿将冰箱安装在潮湿的环境中。
- 内含液体的食品保存在未密封的容器中。>>> 请将内含液体的食品保存在密封的容器中。
- 冰箱门一直打开。>>> 请勿长时间敞开冰箱门。
- 自动调温器设置为过低的温度。>>> 将自动调温器设置到适当的温度。

压缩机不工作。

- 在突然断电或者拔下和插入接头时，冰箱制冷系统中的气体压力尚未平衡，从而触发压缩机的热保护。冰箱将在大约 6 分钟后重新启动。如果冰箱此后没有重新启动，请联系服务人员。
- 除霜功能正在运行。>>> 对于全自动除霜产品而言，这是正常的。除霜功能会定期运行。
- 冰箱插头没有插好。>>> 确保电源线已插好。
- 温度设置不正确。>>> 选择正确的温度设置。
- 电源已断开。>>> 电源恢复后，冰箱会继续正常工作。

使用过程中冰箱的运行噪音逐渐增大

- 由于环境温度的变化，冰箱的运行性能可能会存在差异。这是正常的，并非故障。

冰箱运行过于频繁或时间过长。

- 新产品可能会比以前的产品大。较大的产品需要更长的运行时间。
- 室温可能较高。>>> 在较高室温下，冰箱通常需要较长的时间来运行。
- 冰箱插头可能刚插入不久或刚装入新的食品。>>> 冰箱插头刚插入不久或刚装入新的食品时，可能需要更长的时间才能达到设定的温度。这是正常的。
- 最近可能在冰箱中放入了大量热的食品。>>> 请勿将热的食品放入冰箱中。
- 冰箱门经常打开或长时间敞开。>>> 进入冰箱内部的热空气导致冰箱运行时间较长。请勿经常打开冰箱门。
- 冷冻室或冷藏室的门可能没有关严。>>> 检查确保这些门已经完全关闭。
- 冰箱可能设置为过低的温度。>>> 将温度设置为更高并等待冰箱到达调节好的温度。
- 冷藏室或冷冻室的门密封圈可能较脏、磨损、开裂或未适当固定好。>>> 清洁或更换密封圈。损坏/开裂的门密封圈将导致冰箱运行较长的时间才能保持当前的温度。

冷冻室温度很低，而冷藏室温度足够。

- 冷冻室的温度设置为很低。>>> 调高冷冻室的温度并再次检查。

冷藏室温度很低，而冷冻室温度足够。

- 冷藏室的温度设置为很低。>>> 调高冷藏室的温度并再次检查。

保存在冷藏室抽屉内的食品被冻住了。

- 冷藏室的温度设置为很低。>>> 调高冷冻室的温度并再次检查。

冷藏室或冷冻室内的温度过高。

故障排除

- 冷藏室的温度设置为很高。>>> 冷藏室的温度设置会影响冷冻室的温度。变更冷藏室或冷冻室的温度并等待，直到冷藏室或冷冻室达到调节好的温度水平。
- 冰箱门经常打开或长时间敞开。>>> 请勿过于频繁打开冰箱门。
- 冰箱门可能未关严。>>> 完全关闭冰箱门。
- 冰箱插头可能刚插入不久或刚装入新的食品。>>> 这是正常的。冰箱插头刚插入不久或刚装入新的食品时，可能需要更长的时间才能达到设定的温度。
- 最近可能在冰箱中放入了大量热的食品。>>> 请勿将热的食品放入冰箱中。
- 没有定期清洁冰箱。>>> 使用海绵、热水和苏打水定期清洁冰箱内部。
- 某些容器和包装材料可能会产生异味。>>> 使用没有异味的容器和包装材料。
- 食品放置在未密封的容器中。>>> 将食品保存在密封的容器中。没有密封的食品可能会散发出微生物，并造成异味。
- 从冰箱中取出任何已过期或变质的食品。

振动或噪音。

- 地面不平坦或不坚固。>>> 如果冰箱缓慢移动时产生晃动，请调节支脚来平衡冰箱。同时确保地面足够坚固，能够承载冰箱。
- 放置在冰箱上的任何物品均可能导致噪音的产生。>>> 取下放置在冰箱上的任何物品。

产品发出类似液体流动、喷溅等的噪音。

- 根据原理，冰箱工作时涉及液体和气体的流动。>>> 这是正常的，并非故障。

产品发出类似风吹的噪音。

- 冰箱使用风扇来进行冷却。这是正常的，并非故障。

产品内壁出现冷凝水。

- 炎热或潮湿的天气会增加结冰和冷凝现象。这是正常的，并非故障。
- 冰箱门经常打开或长时间敞开。>>> 请勿过于频繁打开冰箱门；如果门已打开，请关上。
- 冰箱门可能未关严。>>> 完全关闭冰箱门。

产品外面或门之间出现冷凝水。

- 周围空气可能很潮湿，在潮湿气候下，这是很正常的。>>> 湿度下降时，冷凝水将会消失。

内部出现异味。

冰箱门未关。

- 食品包装袋可能妨碍冰箱门的关闭。>>> 重新放置妨碍关门的物品。
- 冰箱在地面上没有处于完全竖立位置。>>> 调节支脚以平衡冰箱。
- 地面不平坦或不坚固。>>> 确保地面足够坚固，能够承载冰箱。

蔬菜盒已卡住。

- 食品可能已接触到抽屉的顶板。>>> 重新摆放抽屉中的食品。



⚠ 如果遵循本节中的指示操作后，问题仍然存在，请联系您的供货商或经过授权的服务人员。请勿自己尝试修理产品。

beko 冰箱变频压缩机十年质保卡

感谢您选购高品质的 beko 产品。

本产品的冰箱变频压缩机享有延长保修政策，零件免费保修期为十年。

为了使您充分享受 beko 冰箱变频压缩机的十年免费保修政策，请于购机 90 日内登陆 beko 官方网站 <http://www.beko.com.cn>/服务支持页面完成十年质保信息注册。

延长保修条款：

1. 保修条款仅对产品购买所在国家有效。
2. 保修范围为：
 - Beko 冰箱变频压缩机自购买之日起的 10 年内免费保修。
 - 免费范围包括一个免费备件，不包括人工费和交通费。
3. 如果保修卡不完整、遭到篡改或有缺陷无法识别，其视为无效。
4. 申请保修服务时，请同时出示购机发票及此质保凭证。
5. 保修仅适用于原始购买人，不得转让给任何第三方。
6. 免责条款：符合下列情形之一，不享受延保服务：
 - 不正当的运输、安装、使用环境、操作导致的损坏
 - 自然灾害或意外事件等不可抗力导致的损坏
 - 自行或非厂方特约维修店进行拆修导致的损坏
 - 在商业或非住宅设施内商用或集体使用本产品
 - 其他不符合说明书保修条款的情形

- 以上信息如有更改，恕不另行通知，以官方网站为准。

***以上条款仅限变频压缩机型号**

**BU SAYFA FTP_AKÜ ENERJİ ADRESİNDEN
MATBAA TARAFINDAN ALINARAK BASILACAKTIR.**