

beko

Refrigerator

User Manual

冰箱

冰箱用户手册

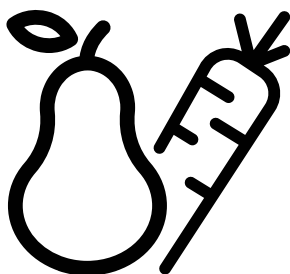

GN1416231ZX-GN1416233ZGB

EN/ZH

579923 0000/AC



Please read this manual before using the product!

Dear Customer,

We'd like you to make the best use of our product, which has been manufactured in modern facilities with care and meticulous quality controls.

Thus, we advise you to read the entire user manual before you use the product. In case the product changes hands, do not forget to hand the guide to its new owner along with the product.

This guide will help you use the product quickly and safely.

- Please read the user guide carefully before installing and operating the product.
- Always observe the applicable safety instructions.
- Keep the user guide within easy reach for future use.
- Please read any other documents provided with the product.

Keep in mind that this user guide may apply to several product models. The guide clearly indicates any variations of different models.





	Important information and useful tips.
	Risk of life and property.
	Risk of electric shock.
	The product's packaging is made of recyclable materials, in accordance with the National Environment Legislation.

1. Safety and environment instructions	3	5 Operating the product	13
2 Your Refrigerator	6	5.1 Indicator panel	13
2 Your Refrigerator	7	5.2 Indicator panel	18
3 Installation	8	5.3 Freezing fresh food	21
3.1 Appropriate location for installation	8	5.4 Recommendations for preserving the frozen food	21
3.2 Installing the plastic wedges	8	5.5 Deep-freeze information	21
3.3 *Adjusting the feet	9	5.6 Placing the food	22
3.4 Electric connection	10	5.7 Door open warning	22
4 Preparation	11	5.8 Chiller compartment	22
4.1 Things to be done for saving energy	11	5.9 Crisper	22
4.2 Recommendations about the fresh food compartment	11	5.10 Humidity-controlled crisper	22
4.3 Initial use	12	(FreSHelf)	22
		5.11 Egg tray	23
		5.12 Movable Middle Section	23
		5.13 Cool Control Storage Compartment	23
		5.14 Blue light	23
		5.15 Odour filter	23
		5.16 Wine cellar compartment	24
		5.17 Using internal water dispenser	26
		5.18 Dispensing water	26
		5.19 For using water dispenser	26
		5.20 Icematic	27
		5.21 Icematic and ice storage container	27
		6. Maintenance and Cleaning	28
		7 Troubleshooting	29

1. Safety and environment instructions

This section provides the safety instructions necessary to prevent the risk of injury and material damage. Failure to observe these instructions will invalidate all types of product warranty.

Intended use

	WARNING: Keep ventilation openings, in the appliance enclosure or in the built-in structure, clear of obstruction.
	WARNING: Do not use mechanical devices or other means to accelerate the defrosting process, other than those recommended by the manufacturer.
	WARNING: Do not damage the refrigerant circuit.
	WARNING: Do not use electrical appliances inside the food storage compartments of the appliance, unless they are of the type recommended by the manufacturer.

This appliance is intended to be used in household and similar applications such as – staff kitchen areas in shops, offices and other working environments;
– farm houses and by clients in hotels, motels and other residential type environments;
– bed and breakfast type environments;
– catering and similar non-retail applications.

1.1. General safety

- This product should not be used by persons with physical, sensory and mental disabilities, without sufficient

knowledge and experience or by children. The device can only be used by such persons under supervision and instruction of a person responsible for their safety. Children should not be allowed to play with this device.

- In case of malfunction, unplug the device.
- After unplugging, wait at least 5 minutes before plugging in again.
- Unplug the product when not in use.
- Do not touch the plug with wet hands! Do not pull the cable to plug off, always hold the plug.
- Do not plug in the refrigerator if the socket is loose.
- Unplug the product during installation, maintenance, cleaning and repair.
- If the product will not be used for a while, unplug the product and remove any food inside.
- Do not use the product when the compartment with circuit cards located on the upper back part of the product (electrical card box cover) (1) is open.

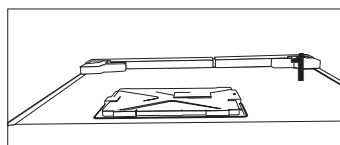
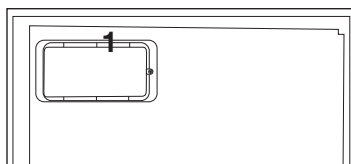

- Do not use steam or steamed cleaning materials for cleaning the refrigerator and melting the ice inside. Steam may contact the electrified areas and cause short circuit or electric shock!
- Do not wash the product by spraying or pouring water on it! Danger of electric shock!

Important instructions regarding safety and environment

- In case of malfunction, do not use the product, as it may cause electric shock. Contact the authorised service before doing anything.
- Plug the product into an earthed socket. Earthing must be done by a qualified electrician.
- If the product has LED type lighting, contact the authorised service for replacing or in case of any problem.
- Do not touch frozen food with wet hands! It may adhere to your hands!
- Do not place liquids in bottles and cans into the freezer compartment. They may explode.
- Place liquids in upright position after tightly closing the lid.
- Do not spray flammable substances near the product, as it may burn or explode.
- Do not keep flammable materials and products with flammable gas (sprays, etc.) in the refrigerator.
- Do not place containers holding liquids on top of the product. Splashing water on an electrified part may cause electric shock and risk of fire.
- Exposing the product to rain, snow, sunlight and wind will cause electrical danger. When relocating the product, do not pull by holding the door handle. The handle may come off.
- Take care to avoid trapping any part of your hands or body in any of the moving parts inside the product.
- Do not step or lean on the door, drawers and similar parts of the refrigerator. This will cause the product to fall down and cause damage to the parts.
- Take care not to trap the power cable.

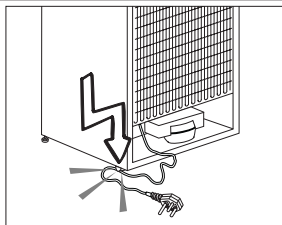

1.1.1 HC warning

If the product comprises a cooling system using R600a gas, take care to avoid damaging the cooling system and its pipe while using and moving the product. This gas is flammable. If the cooling system is damaged, keep the product away from sources of fire and ventilate the room immediately.



The label on the inner left side indicates the type of gas used in the product.

1.1.2 For models with water dispenser

- Pressure for cold water inlet shall be maximum 90 psi (6.2 bar). If your water pressure exceeds 80 psi (5.5 bar), use a pressure limiting valve in your mains system. If you do not know how to check your water pressure, ask for the help of a professional plumber.
- If there is risk of water hammer effect in your installation, always use a water hammer prevention equipment in your installation. Consult Professional plumbers if you are not sure that there is no water hammer effect in your installation.
- Do not install on the hot water inlet. Take precautions against of the risk of freezing of the hoses. Water temperature operating interval shall be 33°F (0.6°C) minimum and 100°F (38°C) maximum.
- Use drinking water only.

Important instructions regarding safety and environment

1.2. Intended use

- This product is designed for home use. It is not intended for commercial use.
- The product should be used to store food and beverages only.
- Do not keep sensitive products requiring controlled temperatures (vaccines, heat sensitive medication, medical supplies, etc.) in the refrigerator.
- The manufacturer assumes no responsibility for any damage due to misuse or mishandling.
- Original spare parts will be provided for 10 years, following the product purchasing date.

1.3. Child safety

- Keep packaging materials out of children's reach.
- Do not allow the children to play with the product.
- If the product's door comprises a lock, keep the key out of children's reach.

1.4. Compliance with WEEE Directive and Disposing of the Waste Product

This product complies with EU WEEE Directive (2012/19/EU). This product bears a classification symbol for waste electrical and electronic equipment (WEEE).



This product has been manufactured with high quality parts and materials which can be reused and are suitable for recycling. Do not dispose of the waste product with normal domestic and other wastes at the end of its service life. Take it to the collection center for the recycling of electrical and electronic equipment. Please consult your local authorities to learn about these collection centers.

1.5. Compliance with RoHS Directive

- This product complies with EU WEEE Directive (2011/65/EU). It does not contain harmful and prohibited materials specified in the Directive.

1.6. Package information

- Packaging materials of the product are manufactured from recyclable materials in accordance with our National Environment Regulations. Do not dispose of the packaging materials together with the domestic or other wastes. Take them to the packaging material collection points designated by the local authorities.

2 Your Refrigerator

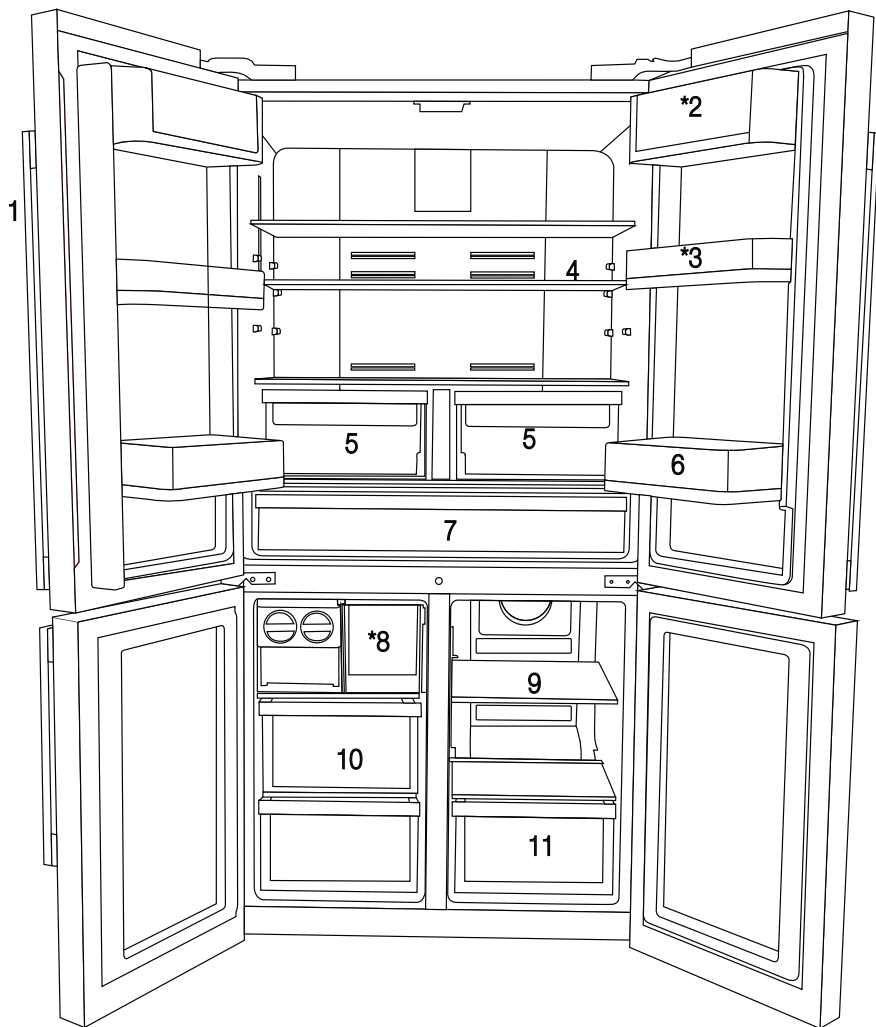

- 1- Control and indicator panel
 - 2- Butter & Cheese section
 - 3- 70 mm moving door shelf
 - 4- Fridge compartment glass shelf
 - 5- Fridge compartment crisper
 - 6- Gallon door shelf
 - 7- Chiller compartment
 - 8- Icebox drawer
 - 9- Multizone compartment glass shelf/cooler
 - 10- Freezer compartment drawers
 - 11- Multizone Compartment's drawer
- * OPTIONAL



Figures in this user manual are schematic and may not match the product exactly. If the subject parts are not included in the product you have purchased, then those parts are valid for other models.

2 Your Refrigerator

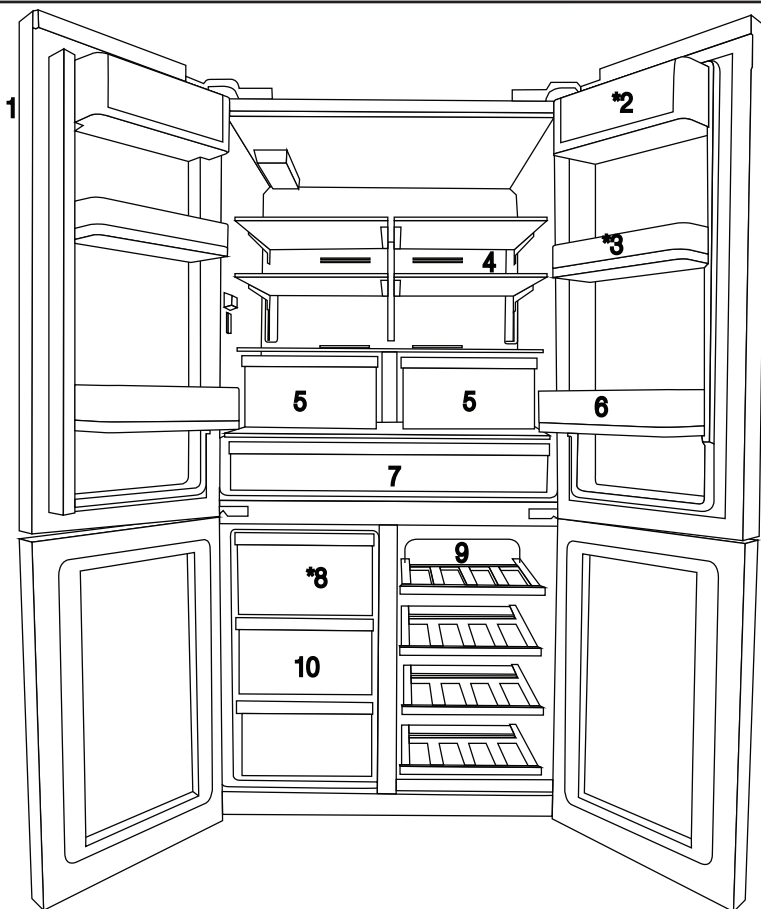

- 1- Control and indicator panel
- 2- Butter & Cheese section
- 3- 70 mm moving door shelf
- 4- Fridge compartment glass shelf
- 5- Fridge compartment crisper
- 6- Gallon door shelf

- 7- Chiller compartment
- 8- Icebox drawer
- 9- Multizone compartment glass shelf/cooler
- 10- Freezer compartment drawers
- * OPTIONAL



Figures in this user manual are schematic and may not match the product exactly. If the subject parts are not included in the product you have purchased, then those parts are valid for other models.

3 Installation

3.1 Appropriate location for installation

Contact an Authorized Service for the installation of the product. In order to prepare the product for use, refer the information in the user manual and ensure that electrical installation and water installation are appropriate. If not, call a qualified electrician and technician to have any necessary arrangements carried out.

	WARNING: Manufacturer shall not be held liable for damages that may arise from procedures carried out by unauthorized persons.
	WARNING: Product must not be plugged in during installation. Otherwise, there is the risk of death or serious injury!
	WARNING: : If the door clearance of the room where the product shall be placed is so tight to prevent passing of the product, remove the door of the room and pass the product through the door by turning it to its side; if this does not work, contact the authorized service.

- Place the product on a level floor surface to prevent jolts.
- Install the product at least 30 cm away from heat sources such as hobs, heater cores and stoves and at least 5 cm away from electrical ovens.
- Product must not be subjected to direct sun light and kept in humid places.
- Appropriate air ventilation must be provided around your product in order to achieve an efficient operation. If the product is to be placed in a recess in the wall, pay attention to leave at least 5 cm distance with the ceiling and side walls.
- Do not install the product in places where the temperature falls below -5°C .

3.2 Installing the plastic wedges

Plastic wedges supplied with the product are used to create the distance for the air circulation between the product and the rear wall.

1. To install the wedges, remove the screws on the product and use the screws supplied together with the wedges.

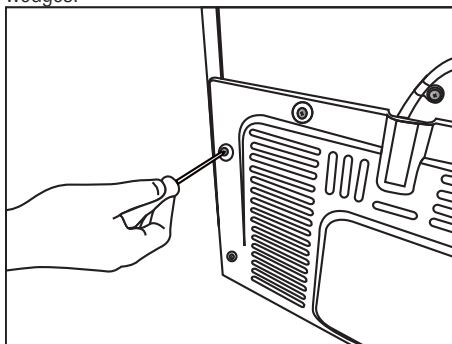

2. Insert the 2 plastic wedges onto the rear ventilation cover as illustrated in the figure.

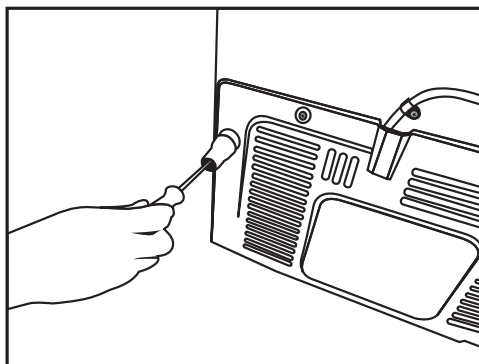

Installation

3.3 *Adjusting the feet

If the product stands unbalanced after installation, adjust the feet on the front by rotating them to the right or left.

*If your product does not have a wine compartment or is not a glass door, your product does not have adjustable stands, the product has fixed stands.

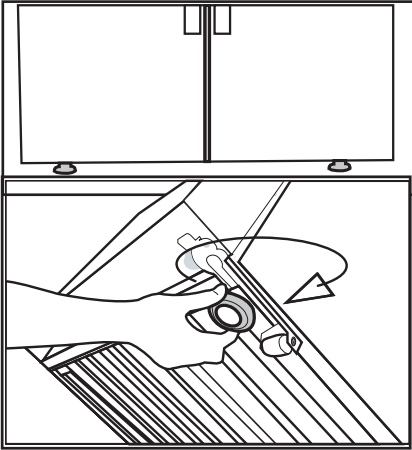

To adjust the doors vertically,

Loosen the fixing nut located at the bottom.

Rotate the adjusting nut according to the position of the door (clockwise/counter-clockwise).

Tighten the fixing nut in order to fix the position.

To adjust the doors horizontally,

Loosen the fixing nut located at the top.

Rotate the side adjusting nut according to the position of the door (clockwise/counter-clockwise).

Tighten the fixing nut which is at the top in order to fix the position.

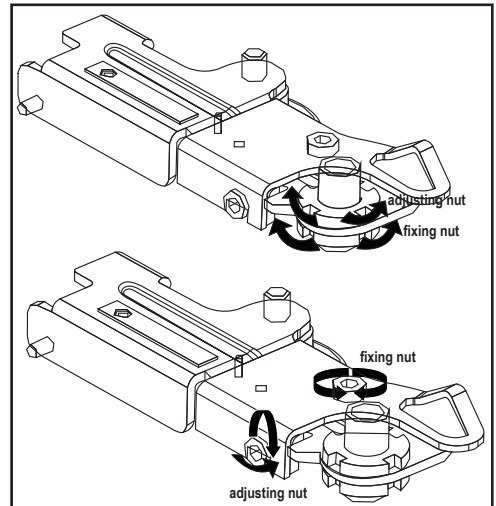

Installation

- Upper hinge group is fixed with 3 screws.
- The hinge cover is attached after the sockets are installed.
- Then the hinge cover is fixed with two screws.

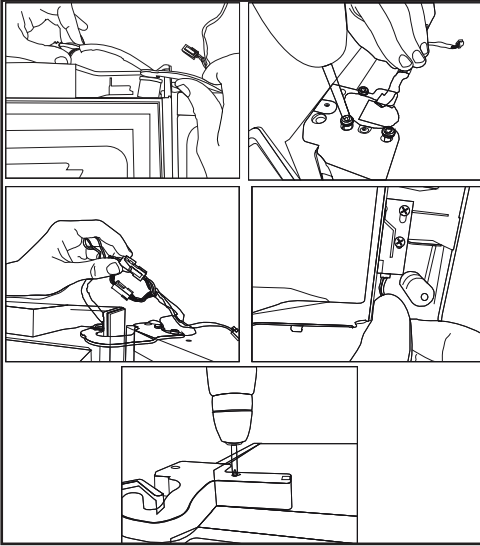

3.4 Electric connection



WARNING: Do not make connections via extension cables or multi-plugs.



WARNING: Damaged power cable must be replaced by the Authorized Service Agent.



If two coolers are to be installed side by side, there should be at least 4 cm distance between them.

- Our company shall not be liable for any damages that will arise when the product is used without grounding and electrical connection in accordance with the national regulations.
- Power cable plug must be within easy reach after installation.
- Do not use extension cords or cordless multiple outlets between your product and the wall outlet.

4 Preparation

4.1 Things to be done for saving energy



Connecting your refrigerator to systems that save energy is dangerous as they may cause damage on the product.

- Do not leave the doors of your refrigerator open for a long time.
- Do not put hot food or drinks in your refrigerator.
- Do not overload the refrigerator. Cooling capacity will fall when the air circulation in the refrigerator is hindered.
- Do not place the refrigerator in places subject to direct sunlight. Install the product at least 30 cm away from heat sources such as hobs, ovens, heater units and stoves and at least 5 cm away from electrical ovens.
- Pay attention to store your food in refrigerator in closed containers.
- To be able store maximum food in the freezer compartment of your refrigerator, the upper drawer has to be removed and placed on top of glass shelf. Power consumption stated for your refrigerator has been determined after removing the icematic and the upper drawers as to allow maximum loading. It is strongly recommended to use the lower drawers in the freezer and the multizone compartment while loading.
- Airflow should not be blocked by placing foods in front of the freezer and the multizone compartment fans. Foods should be loaded by leaving minimum 5 cm space in front of the protective fan grid.
- Thawing the frozen foods in the fridge compartment both saves energy and reserves the quality of the foods.



Temperature of the room where your refrigerator is located should at least be 10°C /50°F. Operating your refrigerator under cooler conditions is not recommended with regard to its efficiency.



Inside of your refrigerator must be cleaned thoroughly.



If two coolers are to be installed side by side, there should be at least 4 cm distance between them.

4.2 Recommendations about the fresh food compartment

- Make sure that the food does not touch the temperature sensor in fresh food compartment. To allow the fresh food compartment to keep its ideal storage temperature, the sensor must not be hindered by food.
- Do not place hot foods or beverages inside the product.

Preparation

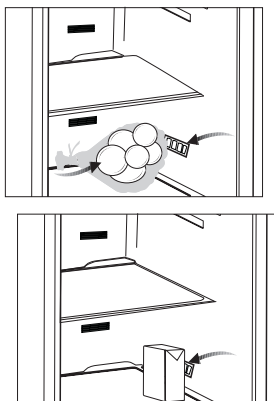

4.3 Initial use

Before using the product, make sure that all preparations have been made in accordance with the instructions given in the "Important instructions regarding safety and environment" and "Installation" chapters.

- Clean the interior of the refrigerator as recommended in the "Maintenance and cleaning" section. Before you start the refrigerator, make sure that the interior is dry.
- Plug the refrigerator in a grounded socket. The interior illumination is lit when the door of the refrigerator is opened.
- Operate the refrigerator for 6 hours without placing any food in it and do not open its door unless it is necessary.



You will hear a noise when the compressor starts up. The liquids and gases sealed within the refrigeration system may also give rise to noise, even if the compressor is not running and this is quite normal.



Front edges of the refrigerator may feel warm. This is normal. These areas are designed to be warm to avoid condensation.

5 Operating the product

5.1 Indicator panel

Touch-controlled indicator panel allows you to set the temperature and control the other functions related to the refrigerator without opening the door of the product. Just press the relevant buttons for function settings.

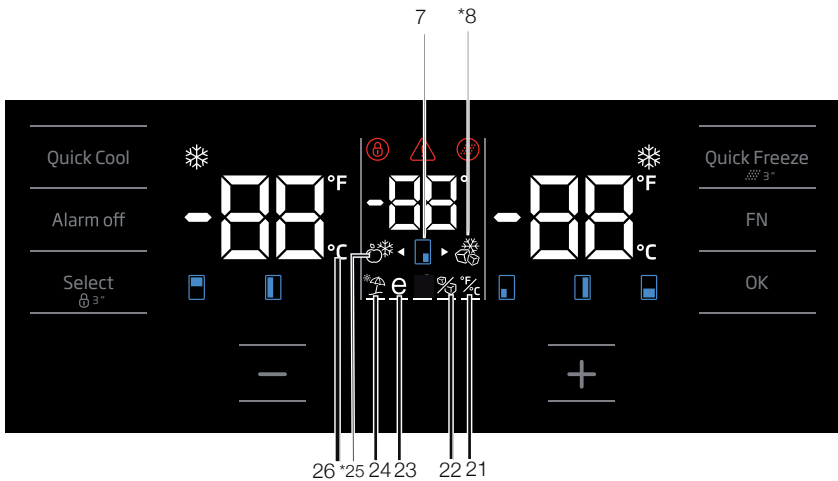
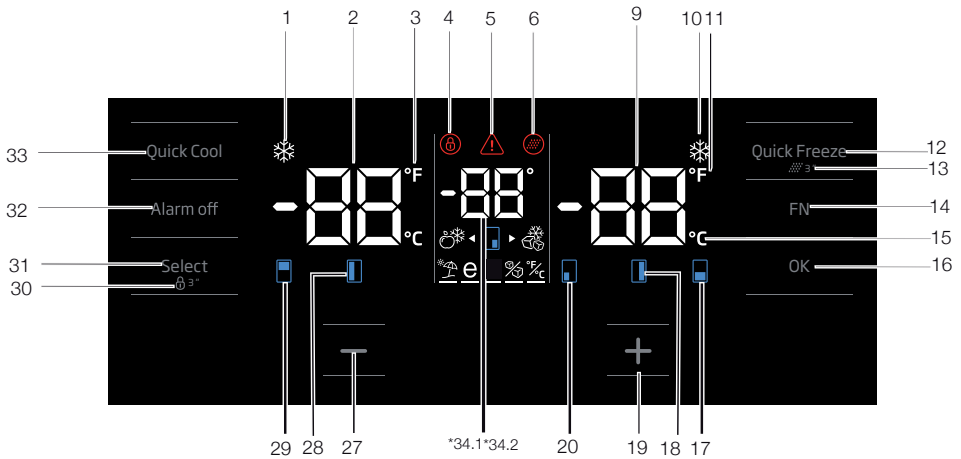

Figures in this user manual are schematic and may not match the product exactly. If the subject parts are not included in the product you have purchased, then those parts are valid for other models.

Operating the product

1. Quick cooling function indicator

It turns on when the quick fridge function is activated.

2. Fridge compartment temperature indicator

Temperature of the fridge compartment is shown; it can be set to 8,7,6,5,4,3,2,1.

3. Fahrenheit indicator

It is a Fahrenheit indicator. When the Fahrenheit indication is activated, the temperature set values are shown in Fahrenheit and the relevant icon turns on.

4. Key lock

Press key lock button simultaneously for 3 seconds. Key lock symbol

will light up and key lock mode will be activated.

Buttons will not function if the Key lock mode is active. Press key lock button simultaneously for 3 seconds again. Key lock symbol will turn off and the key lock mode will be exited.

Press the key lock button if you want to prevent changing of the temperature setting of the refrigerator.

5. Power failure/High temperature / error warning

This indicator illuminates during power failure, high temperature failures and error warnings. During long-term power failures, the highest temperature value that the freezer compartment reaches will blink on the digital display. After checking the food located in the freezer compartment, press the alarm off button to clear the warning.

Please refer to "solutions recommended for troubleshooting" section on your manual if you observe that this indicator is illuminated.

6. Filter reset icon

This icon turns on when the filter needs to be reset.

7. Temperature change cabin icon

Indicates the cabin whose temperature is to be changed. When the temperature change cabin icon starts flashing, it is understood that the relevant cabin has been selected.

8. Joker freezer icon

Hover over the Joker freezer icon using the FN button; the icon will start to flash. When you press the OK key, joker cabin freezer icon turn on and operates as a freezer.

9. Freezer compartment temperature indicator

Temperature of the fridge compartment is shown; it can be set to -18, -19, -20, -21, -22, -23, -24.

10. Quick freeze function indicator

It turns on when the quick freeze function is activated.

11. Fahrenheit indicator

It is a Fahrenheit indicator. When the Fahrenheit indication is activated, the temperature set values are shown in Fahrenheit and the relevant icon turns on.

12. Quick freeze function button

Press this button to activate or deactivate the quick freeze function. When you activate the function, the freezer compartment will be cooled to a temperature lower than the set value.



Use the quick freeze function when you want to quickly freeze the food placed in freezer compartment. If you want to freeze large amounts of fresh food, activate this function before putting the food into the product.



If you do not cancel it, Quick Freeze will cancel itself automatically after 4 hours at the most or when the fridge compartment reaches to the required temperature.



This function is not recalled when power restores after a power failure.

13. Filter reset

The filter is reset when the quick freeze button is pressed for 3 seconds. Filter reset icon goes off.

Operating the product

14. FN button

Using this key, you can switch between the functions that you want to select. Upon pressing this key, the icon, whose function is required to be activated or deactivated, and this icon's indicator starts flashing. The FN button gets deactivated if not pressed for 20 seconds. You need to press this button to change the functions again.

15. Celsius indicator

It is a Celsius indicator. When the Celsius indication is activated, the temperature set values are shown in Celsius and the relevant icon turns on.

16. OK button

After navigating the functions using the FN button, when the function is cancelled via the OK button, the relevant icon and the indicator flashes. When the function is activated, it remains on. The indicator continues to flash in order to show the icon it is on.

17. Temperature change cabin icon

Indicates the cabin whose temperature is to be changed. When the temperature change cabin icon starts flashing, it is understood that the relevant cabin has been selected.

18. Temperature change cabin icon

Indicates the cabin whose temperature is to be changed. When the temperature change cabin icon starts flashing, it is understood that the relevant cabin has been selected.

19. Set increasing button

Select the relevant cabin with the select button; the cabin icon representing the relevant cabin will start to flash. If you press the set increasing button during this process, the set value gets increased. If you keep pressing it in a loop, the set value returns to the beginning.

20. Temperature change cabin icon

Indicates the cabin whose temperature is to be changed. When the temperature change cabin icon starts flashing, it is understood that the relevant cabin has been selected.

21. Setting the Celsius and Fahrenheit indicator

Hover over this key using the FN key and select Fahrenheit and Celsius via the OK key. When the relevant temperature type is selected, the Fahrenheit and Celsius indicator turns on.

22. Ice machine off icon

Press the FN key (until it reaches the ice icon and the lower line) to switch off the ice machine. The ice machine off icon and the ice machine function indicator start flashing when you hover over them, thus you can understand whether the ice machine will be turned on or off. When you press the OK button, the ice machine icon lights continuously and the Indicator continues to flash during this process. If you do not press any button after 20 seconds, the icon and the indicator remains on. Thus, the ice machine is switched off. In order to switch on the ice machine again, hover over the icon and the indicator; thus, both the ice machine off icon and the indicator will start flashing. If you do not press any button within 20 seconds, the icon and the indicator will go off and thus the ice machine will be switched on again.



Indicates whether the icematic is on or off.



Water flow from water tank will stop when this function is selected. However, ice made previously can be taken from the icematic.

23. Eco fuzzy function icon

Press the FN key (until it reaches the letter e icon and the lower line) to activate the eco fuzzy. When you hover over the eco fuzzy icon and the eco fuzzy function indicator, they start flashing. Thus, you can understand whether the eco fuzzy function will be activated or deactivated. When you press the OK button, the eco fuzzy function icon lights continuously and the Indicator continues to flash during this process. If you do not press any button after 20 seconds, the icon and the indicator remains on. Thus, the eco fuzzy function is activated. In order to cancel the eco fuzzy function,

Operating the product

hover over the icon and the indicator again and press the OK key. Thus, both the eco fuzzy function icon and the indicator will start flashing. If you do not press any button within 20 seconds, the icon and the indicator will go off and the eco fuzzy function will be cancelled.

24. Vacation function icon

Press the FN key (until it reaches the umbrella icon and the lower line) to activate the vacation function. When you hover over the vacation function icon and the vacation function indicator, they start flashing. Thus, you can understand whether the vacation function will be activated or deactivated. When you press the OK button, the vacation function icon lights continuously and thus the Vacation function is activated. The Indicator continues to flash during this process. Press the OK key to cancel the vacation function. Thus, both the vacation function icon and the indicator will start flashing and the vacation function will be cancelled.

25. Joker fridge icon

When you select the joker fridge icon using the FN button and press the OK key, the joker cabin turns into a fridge cabin and operates as a cooler.

26. Celsius indicator

It is a Celsius indicator. When the Celsius indication is activated, the temperature set values are shown in Celsius and the relevant icon turns on.

27. Set decreasing function

Select the relevant cabin with the select button; the cabin icon representing the relevant cabin will start to flash. If you press the set decreasing button during this process, the set value gets decreased. If you keep pressing it in a loop, the set value returns to the beginning.

28. Temperature change cabin icon

Indicates the cabin whose temperature is to be changed. When the temperature change cabin icon starts flashing, it is understood that the relevant cabin has been selected.

29. Temperature change cabin icon

Indicates the cabin whose temperature is to be changed. When the temperature change cabin icon starts flashing, it is understood that the relevant cabin has been selected.

30. Key lock

Press key lock button simultaneously for 3 seconds. Key lock symbol will light up and key lock mode will be activated. Buttons will not function if the Key lock mode is active. Press key lock button simultaneously for 3 seconds again. Key lock symbol will turn off and the key lock mode will be exited.

Press the **key lock** button if you want to prevent changing of the temperature setting of the refrigerator.

31. Select button

Use this button to select the cabin whose temperature you want to change. Switch between the cabins by pressing this button. The selected cabin can be understood from the cabin icons (7,17,18,20,28,29). Whichever cabin icon is flashing, the cabin, whose temperature set value you want to change, is selected. Then, you can change the set value by pressing the cabin set value decreasing button (27) and the cabin set value increasing button (19). If you do not press the select button for 20 seconds, the cabin icons will go off. You need to press this key to select a cabin again.

32. Alarm off warning

In case of power failure/high temperature alarm, after checking the foods in the freezer compartment, press the alarm off button to clear the warning.

33. Quick cooling function button

The button has two functions. To activate or deactivate the quick cool function, press it briefly. Quick Cool indicator will turn off and the product will return to its normal settings.

Operating the product



Use quick cooling function when you want to quickly cool the food placed in the fridge compartment. If you want to cool large amounts of fresh food, activate this function before putting the food into the product.



If you do not cancel it, quick cooling will cancel itself automatically after 8 hours at the most or when the fridge compartment reaches to the required temperature.



If you press the quick cooling button repeatedly with short intervals, the electronic circuit protection will be activated and the compressor will not start up immediately.



This function is not recalled when power restores after a power failure.

34. 1 Joker temperature indicator

Temperature set values of the joker cabin are displayed.

34. 2 Wine cooler compartment temperature indicator

Temperature set values of the winecabin are displayed.

Operating the product

5.2 Indicator panel

Touch-control indicator panel allows you to set the temperature and control the other functions related to the refrigerator. Just press the relevant buttons for function settings.

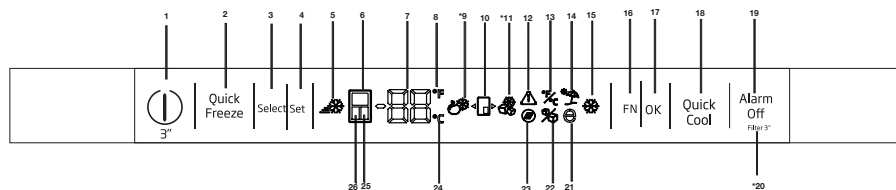

1-On/Off function

Press the On/Off button for 3 seconds to turn off or turn on the fridge.

2. Quick freeze function button

Press this button to activate or deactivate the quick freeze function. When you activate the function, the freezer compartment will be cooled to a temperature lower than the set value.



Use the quick freeze function when you want to quickly freeze the food placed in freezer compartment. If you want to freeze large amounts of fresh food, activate this function before putting the food into the product.



If you do not cancel it, Quick Freeze will cancel itself automatically after 4 hours at the most or when the fridge compartment reaches to the required temperature.



This function is not recalled when power restores after a power failure.

3.Select button

Use this button to select the cabin whose temperature you want to change. Switch between

the cabins by pressing this button. The selected cabin can be understood from the cabin icons (6, 25, 24). Whichever cabin icon is power on, the cabin, whose temperature set value you want to change, is selected. Then, you can change the set value by pressing the cabin set value Temperature Adjustment button (4)

4.Temperature Adjustment / Temperature Decrease

When pressed, decreases the temperature of the selected compartment.

5-Quick freeze Indicator

This icon lits when the Quick freeze function is active.

6. Fridge compartment indicator

When this indicator is active, the temperate of the fridge compartment is displayed on the temperature value indicator.Fridge compartment can be set to 8, 7, 6, 5, 4, 3, 2 or 1°C / 46, 45, 44, 43, 42, 41, 40,39,38,37,36,35,34 or 33°F by pressing Temperature Adjustment button (4).

7. Temperature value indicator

Shows the temperature value of the selected compartment.

8. Fahrenheit indicator

It is a Fahrenheit indicator. When the Fahrenheit indication is activated, the temperature set values are shown in Fahrenheit and the relevant icon turns on.

9. Joker fridge icon



Figures in this user manual are schematic and may not match the product exactly. If the subject parts are not included in the product you have purchased, then those parts are valid for other models.

Operating the product

When you select the joker fridge icon using the FN button (16) and press the OK button (17) the joker cabin turns into a fridge cabin and operates as a cooler.

10. Joker cabin icon

It shows joker cabin icon.

11. Joker freezer icon

When you select the joker freezer icon using the FN button (16) and press the OK button (17) the joker cabin turns into a freezer cabin and operates as a freezer.

12. Power failure/High temperature / error warning

This indicator illuminates during power failure, high temperature failures and error warnings. During long-term power failures, the highest temperature value that the freezer compartment reaches will blink on the digital display. After checking the food located in the freezer compartment, press the alarm off button (19) to clear the warning.

13. Setting the Celsius and Fahrenheit indicator

Hover over this key using the FN key and select Fahrenheit and Celsius via the OK key. When the relevant temperature type is selected, the Fahrenheit and Celsius indicator turns on.

14. Vacation function icon

Press the FN key (until it reaches the umbrella icon) to activate the vacation function. When you hover over the vacation function icon, it start flashing. Thus, you can understand whether the vacation function will be activated or deactivated. When you press the OK button, the vacation function indicator lights continuously and thus the Vacation function is activated. Press the OK key to cancel the vacation function. Thus, the vacation function indicator will start flashing and the vacation function will be cancelled.

15. Quick cooling function indicator

It turns on when the quick fridge function is activated.

16. FN button

Using this key, you can switch between the functions that you want to select. Upon pressing this key, the icon, whose function is required to be

activated or deactivated, and this icon's indicator starts flashing. The FN button gets deactivated if not pressed for 20 seconds. You need to press this button to change the functions again.

17. OK button

After navigating the functions using the FN button, when the function is cancelled via the OK button, the relevant indicator flashes. When the function is activated, it remains on. The indicator continues to flash in order to show the icon it is on.

18. Quick cooling function button

The button has two functions. To activate or deactivate the quick cool function, press it briefly. Quick Cool indicator will turn off and the product will return to its normal settings.

19. Alarm off warning

In case of power failure/high temperature alarm, after checking the foods in the freezer compartment, press the alarm off button to clear the High temperature warning icon (12).

20. Filter reset

The filter is reset when the alarm off button (19) is pressed for 3 seconds. Filter reset icon goes off.

21. Eco fuzzy function icon

Press the FN key (until it reaches the letter e icon) to activate the eco fuzzy. When you hover over the eco fuzzy icon it start flashing. Thus, you can understand whether the eco fuzzy function will be activated or deactivated. When you press the OK button, the eco fuzzy function icon lights continuously during this process. If you do not press any button after 20 seconds, the icon remains on. Thus, the eco fuzzy function is activated. In order to cancel the eco fuzzy function, hover over the icon again and press the OK key. Thus, the eco fuzzy function icon will start flashing. If you do not press any button within 20 seconds, the icon will go off and the eco fuzzy function will be cancelled.

22. Ice machine off icon

Press the FN key (until it reaches the ice icon) to switch off the ice machine. The ice machine off icon start flashing when you hover over it, thus you

Operating the product

can understand whether the ice machine will be turned on or off. When you press the OK button, the ice machine icon lights continuously during this process. If you do not press any button after 20 seconds, the icon and the indicator remains on. Thus, the ice machine is switched off. In order to switch on the ice machine again, hover over the icon. The ice machine off icon will start flashing. If you press ok button, the icon will go off and thus the ice machine will be switched on again.



Indicates whether the icematic is on or off.



Water flow from water tank will stop when this function is selected. However, ice made previously can be taken from the icematic.

23. Filter reset icon

This icon turns on when the filter needs to be reset.

24. Celsius indicator

It is a Celsius indicator. When the Celsius indication is activated, the temperature set values are shown in Celsius and the relevant icon turns on.

25. Joker compartment indicator

When this indicator is active, the temperate of the joker compartment is displayed on the temperature value indicator. Joker compartment set values change by pressing Temperature Adjustment button (4).

26. Freezer compartment indicator

When this indicator is active, the temperate of the freezer compartment is displayed on the temperature value indicator. Freezer compartment can be set to -18, -19, -20, -21, -22, -23 and -24 °C / 0, -2, -4, -6, -8, -10 and -12°F by pressing Temperature Adjustment button (4).

Operating the product

Freezer Compartment Setting	Fridge Compartment Setting	Remarks
-18°C	4°C	This is the normal recommended setting.
-20, -22 or -24°C	4°C	These settings are recommended when the ambient temperature exceeds 30°C.
Quick Freeze	4°C	Use when you wish to freeze your food in a short time. Your product will return to its previous mode when the process is over.
-18°C or colder	2°C	Use these settings if you think that your fridge compartment is not cold enough because of the hot ambient conditions or frequent opening and closing of the door.

5.3 Freezing fresh food

- In order to preserve the quality of the food, it shall be frozen as quickly as possible when it is placed in the freezer compartment, use the fast freezing feature for this purpose.
- You may store the food longer in freezer compartment when you freeze them while they are fresh.
- Pack the food to be frozen and close the packing so that it would not allow entrance of air.
- Ensure that you pack your food before putting them in the freezer. Use freezer containers, foils and moisture-proof papers, plastic bags and other packing materials instead of traditional packing papers.
- Label each pack of food by adding the date before freezing. You may distinguish the freshness of each food pack in this way when you open your freezer each time. Store the food frozen before in the front side of compartment to ensure that they are used first.
- Frozen food must be used immediately after they are thawed and they should not be re-frozen.
- Do not freeze too large quantities of food at one time.

5.4 Recommendations for preserving the frozen food

Compartment shall be set to -18°C at least.

1. Put packages in the freezer as quickly as possible after purchase without allowing the to thaw.
2. Check whether the "Use By" and "Best Before" dates on the packaging are expired or not before freezing it.
3. Ensure that the package of the food is not damaged.

5.5 Deep-freeze information

According to IEC 62552 standards, the product shall freeze at least 4.5 kg of food at 25°C ambient temperature to -18°C or lower within 24 hours for every 100-litres of freezer volume. It is possible to preserve the food for a long time only at -18°C or lower temperatures.

You can keep the freshness of food for many months (at -18°C or lower temperatures in the deep freeze).

Foods to be frozen should not be allowed to come in contact with the previously frozen items to prevent them from getting thawed partially.

Operating the product

Boil the vegetables and drain their water in order to store vegetables for a longer time as frozen. After draining their water, put them in air-proof packages and place them inside the freezer. Food such as bananas, tomatoes, lettuce, celery, boiled eggs, potatoes are not suitable for freezing. When these foods are frozen, only their nutritional value and taste shall be affected negatively. They shall not be spoiled so that they would create a risk for human health.

5.6 Placing the food

Freezer compartment shelves	Various frozen food such as meat, fish, ice cream, vegetables and etc.
Refrigerator compartment shelves	Food in pans, covered plates and closed containers, eggs (in closed container)
Door shelves of fridge compartment	Small and packaged food or beverage
Crisper	Vegetables and fruits
Fresh zone compartment	Delicatessen (breakfast food, meat products that shall be consumed in a short time)

5.7 Door open warning

(This feature is optional)

An audio warning signal will be given when the door of your product is left open for 1 minute. This warning will be muted when the door is closed or any of the display buttons (if any) are pressed.

5.8 Chiller compartment

Chiller compartments allow you to prepare the food for freezing. You can also use these compartments to store your food at a temperature a few degrees below the fridge compartment.

You can increase the inner volume of your refrigerator by removing any of the chiller compartments:

1. Pull the compartment towards yourself until it stops.
2. Lift the compartment about 1 cm up and pull towards yourself to remove it from its seating.

5.9 Crisper

Crisper of the refrigerator is designed specially to keep the vegetables fresh without losing their humidity. For this purpose, cool air circulation is intensified around the crisper in general. Remove the door shelves that stand against the crisper before removing the crisper.

5.10 Humidity-controlled crisper

(FreSHelf)

(This feature is optional)

Humidity rates of fruits and vegetables are kept under control thanks to the humidity-controlled crisper and thus the food is ensured to stay fresh for a longer period.

We recommend that you place leafy vegetables such as lettuce and spinach and vegetables sensitive to humidity loss as horizontally as possible when putting them in the crisper; not in a horizontal position on their roots.

While the vegetables are being replaced, their specific weights should be taken into consideration. Heavy and hard vegetables must be placed at the bottom of the crisper and light and soft vegetables must be on the upper part.

Operating the product

Never leave the vegetables in their plastic bags in the crisper. If they are left in their plastic bags, this will cause them to rot in a little while. If you not prefer the vegetable to get in contact with other vegetables for hygienic reasons, use perforated paper or a similar material instead of plastic bags.

Do not place pears, apricots, peaches etc., especially those fruits that generate large amounts of ethylene, in the same crisper with other fruits and vegetables. The ethylene gas emitted by these fruits cause other fruits to ripen sooner and to rot in a shorter span of time.

5.11 Egg tray

You can install the egg holder to the desired door or body shelf.

Never keep the egg holder in the freezer compartment.

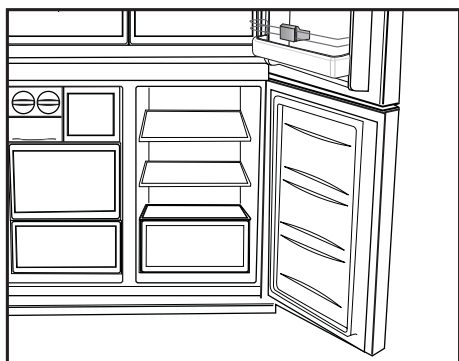

5.12 Movable Middle Section

Movable middle section is intended to prevent the cold air inside your refrigerator from escaping outside.

1- Sealing is provided when the gaskets on the door presses on the surface of the movable middle section while the fridge compartment doors are closed.

2- Another reason that your refrigerator is equipped with a movable middle section is that it increases the net volume of the fridge compartment. Standard middle sections occupy some non-usable volume in the refrigerator.

3-Movable middle section is closed when the left door of the fridge compartment is opened.

4-It must not be opened manually. It moves under the guidance of the plastic part on the body while the door is closed.

5.13 Cool Control Storage Compartment

The Cool Control Storage Compartment of your refrigerator may be used in any desired mode by adjusting it to fridge (2/4/6/8 °C) or freezer (-18/-20/-22/-24) temperatures. You can keep the compartment at the desired temperature with the Cool Control Storage Compartment's Temperature Setting Button. The temperature of the Cool Control Storage Compartment may be set to 0 and 10 degrees in addition to the fridge compartment temperatures and to -6 degrees in addition to the freezer compartment temperatures. 0 degree is used to store the deli products longer, and -6 degrees is used to keep the meats up to 2 weeks in an easily sliceable condition.

The feature of switching to a Fridge or Freezer compartment is provided by a cooling element located in the closed section (Compressor Compartment) behind the refrigerator. During operation of this element, sounds similar to the sound of seconds heard from an analogue clock may be heard. This is normal and is not fault cause.

5.14 Blue light (in some models)

Crisper of the refrigerator are illuminated with a blue light. Foodstuff stored in the crisper continue their photosynthesis by means of the wavelength effect of blue light and thus, preserve their freshness and increase their vitamin content.

5.15 Odour filter

Odour filter in the air duct of the fridge compartment prevents build-up of unpleasant odours in the refrigerator.

5.16 Wine cellar compartment

(This feature is optional)

1 – Fill your cellar compartment

Wine cellar was built to contain up to 28 front bottles + 3 bottles accessible using a telescopic rack. These maximum quantities declared are given for information purpose only and correspond to tests carried out with a "Bordelaise 75cl" standard bottle.

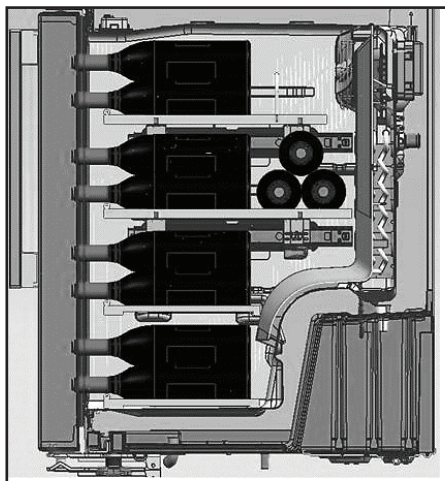
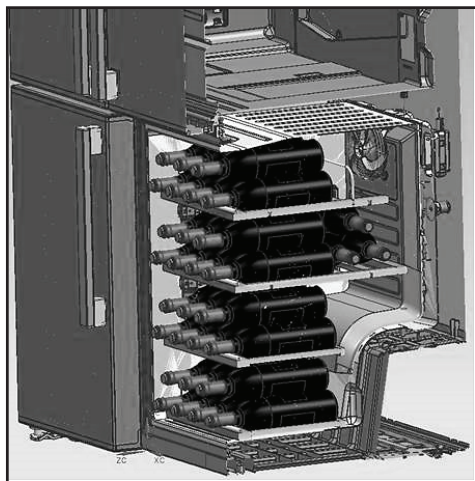

2- Suggested optimum service temperatures

Our advice: If you mix different types of wines, choose a 12 ° Celsius setting just like in a real cellar.

For white wines, which are to be served between 6 and 10 °, think of putting your bottles in the refrigerator 1/2 hour before serving, the refrigerator will be able to maintain the bottles at the preferred temperature. As regards red wines, they will heat up slowly at room temperature when serving.

16 -17°C	Fine Bordeaux wines - Red
15 -16°C	Fine Burgundy wines- Red
14 -16°C	Grand crus (great growth) of dry white wines
11 -12°C	Light,fruity and young red wines
10 -12°C	Provence rosé wines, French wines
10 -12°C	Dry white wines and red country wines
8 - 10°C	White country wines
7 - 8°C	Champagnes
6-°C	Sweet white wines

Operating the product

3- Suggestions relating to the opening of a wine bottle before tasting:

White wines	About 10 minutes before serving
Young red wines	About 10 minutes before serving
Thick and mature red wines	About 30 to 60 minutes before serving

4- How long can an open bottle be preserved?

Unfinished bottles of wine must be corked properly and can be preserved in a cold and dry place during the following periods:

	White	wines Red wines
75 % full bottle	3 to 5 days	4 to 7 days
50 % full bottle	2 to 3 days	3 to 5 days
Less than 50 %	1 day	2 days

Operating the product

5.17 Using internal water dispenser (in some models)

After connecting the refrigerator to a water source or replacing the water filter, flush the water system. Use a sturdy container to depress and hold the water dispenser lever for 5 seconds, then release it for 5 seconds. Repeat until water begins to flow. Once water begins to flow, continue depressing and releasing the dispenser paddle (5 seconds on, 5 seconds off) until a total of 4 gal. (15L) has been dispensed. This will flush air from the filter and water dispensing system, and prepare the water filter for use. Additional flushing may be required in some households. As air is cleared from the system, water may spurt out of the dispenser.

Allow 24 hours for the refrigerator to cool down and chill water. Dispense enough water every week to maintain a fresh supply.



After 5 minutes of continuous dispensing, the dispenser will stop dispensing water to avoid flooding. To continue dispensing, press the dispenser paddle again.

5.18 Dispensing water

Hold a container under the dispenser spout while pressing the dispenser pad.

Release the dispenser pad to stop dispensing.



It is normal for the first few glasses of water taken from the dispenser to be warm.



If the water dispenser is not used for a long period of time, dispose of first few glasses of water to obtain fresh water.

During initial use, you will have to wait approximately 24 hours for the water to cool down. Take out the glass a little while after you pull the trigger.

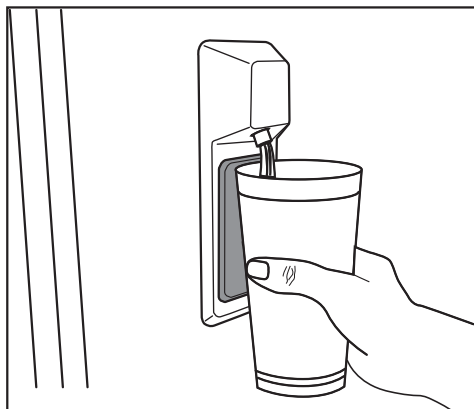

5.19 For using water dispenser



Before using your fridge first time and after replacing your water filter, water dispenser may drip drops of water. To prevent water dripping or leaking from dispenser, please bleed the air from the system by dispensing 5-6 gallons (about 20 liter) of water through the water dispenser before the first use and every time after you change the water filter. This will remove any air trapped in the system and stop the water dispenser from leaking. Checking coupler position and the straightness of water line at the back of the unit will be required if there's an obstruction in water flow.



If your water dispenser is leaking just a few drops of water after you have dispensed some water, this is normal.

Operating the product

5.20 Icematic (in some models)

To get ice from the icematic, fill the water tank in the fridge compartment with water up to the maximum level.

Ice cubes in the ice drawer may stick to each other and become a bulk due to hot and humid air in approximately 15 days. This is normal. If you cannot break the bulk apart, you can empty the ice container and make ice again.



It is recommended to change the water in the water tank if it remains in the water tank for more than 2-3 weeks.



Strange noises you hear from the refrigerator at 120-minute intervals are the sounds of ice-making and pouring. This is normal.



If you do not want to make ice, press the Ice off icon to stop the icematic to save energy and prolong the service life of your refrigerator.



It is normal that a few drops of water drop from the dispenser after you have taken water.

5.21 Icematic and ice storage container

(in some models)

Using the Icematic

Fill the Icematic with water and place it into its seat. Your ice will be ready approximately in two hours. Do not remove the Icematic from its seating to take ice.

Turn the knobs on the ice reservoirs clockwise by 90 degrees.

Ice cubes in the reservoirs will fall down into the ice storage container below.

You may take out the ice storage container and serve the ice cubes.

If you wish, you may keep the ice cubes in the ice storage container.

Ice storage container

Ice storage container is only intended for accumulating the ice cubes. Do not put water in it. Otherwise, it will break.

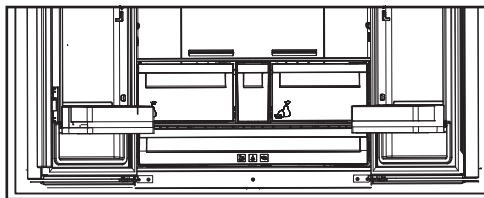

6. Maintenance and Cleaning

Cleaning the product regularly will prolong its service life.



WARNING: Disconnect the power before cleaning the refrigerator.

- Do not use sharp and abrasive tools, soap, house cleaning materials, detergents, gas, gasoline, varnish and similar substances for cleaning.
- For non-No Frost products, water drops and frosting up to a fingerbreadth occur on the rear wall of the Fridge compartment. Do not clean it; never apply oil or similar agents on it.
- Only use slightly damp microfiber cloths to clean the outer surface of the product. Sponges and other types of cleaning cloths may scratch the surface.
- Melt a teaspoonful of carbonate in the water. Moisten a piece of cloth in the water and wring out. Wipe the device with this cloth and dry off thoroughly.
- Take care to keep water away from the lamp's cover and other electrical parts.
- Clean the door using a wet cloth. Remove all items inside to detach the door and chassis shelves. Lift the door shelves up to detach. Clean and dry the shelves, then attach back in place by sliding from above.

- Do not use chloric water or cleaning products on the exterior surface and chrome-coated parts of the product. Chlorine will cause rust on such metallic surfaces.
- Do not use sharp, abrasive tools, soap, household cleaning agents, detergents, kerosene, fuel oil, varnish etc. to prevent removal and deformation of the prints on the plastic part. Use lukewarm water and a soft cloth for cleaning and then wipe it dry.

6.1. Preventing Bad Odour

The product is manufactured free of any odorous materials. However, keeping the food in inappropriate sections and improper cleaning of internal surfaces may lead to malodour.

To avoid this, clean the inside with carbonated water every 15 days.

- Keep the foods in sealed holders. Microorganisms may spread out of unsealed food items and cause malodour.
- Do not keep expired and spoiled foods in the refrigerator.

6.2. Protecting Plastic Surfaces

Oil spilled on plastic surfaces may damage the surface and must be cleaned immediately with warm water.

7 Troubleshooting

Check this list before contacting the service. Doing so will save you time and money. This list includes frequent complaints that are not related to faulty workmanship or materials. Certain features mentioned herein may not apply to your product.

The refrigerator is not working.

- The power plug is not fully settled. >>> Plug it in to settle completely into the socket.
- The fuse connected to the socket powering the product or the main fuse is blown. >>> Check the fuses.

Condensation on the side wall of the cooler compartment (MULTI ZONE, COOL, CONTROL and FLEXI ZONE).

- The environment is too cold. >>> Do not install the product in environments with temperatures below -5°C.
- The door is opened too frequently >>> Take care not to open the product's door too frequently.
- The environment is too humid. >>> Do not install the product in humid environments.
- Foods containing liquids are kept in unsealed holders. >>> Keep the foods containing liquids in sealed holders.
- The product's door is left open. >>> Do not keep the product's door open for long periods.
- The thermostat is set to too low temperature. >>> Set the thermostat to appropriate temperature.

Compressor is not working.

- In case of sudden power failure or pulling the power plug off and putting back on, the gas pressure in the product's cooling system is not balanced, which triggers the compressor thermic safeguard. The product will restart after approximately 6 minutes. If the product does not restart after this period, contact the service.
- Defrosting is active. >>> This is normal for a fully-automatic defrosting product. The defrosting is carried out periodically.
- The product is not plugged in. >>> Make sure the power cord is plugged in.
- The temperature setting is incorrect. >>> Select the appropriate temperature setting.
- The power is out. >>> The product will continue to operate normally once the power is restored.

The refrigerator's operating noise is increasing while in use.

- The product's operating performance may vary depending on the ambient temperature variations. This is normal and not a malfunction.

The refrigerator runs too often or for too long.

Troubleshooting

- The new product may be larger than the previous one. Larger products will run for longer periods.
- The room temperature may be high. >>> The product will normally run for long periods in higher room temperature.
- The product may have been recently plugged in or a new food item is placed inside. >>> The product will take longer to reach the set temperature when recently plugged in or a new food item is placed inside. This is normal.
- Large quantities of hot food may have been recently placed into the product. >>> Do not place hot food into the product.
- The doors were opened frequently or kept open for long periods. >>> The warm air moving inside will cause the product to run longer. Do not open the doors too frequently.
- The freezer or cooler door may be ajar. >>> Check that the doors are fully closed.
- The product may be set to temperature too low. >>> Set the temperature to a higher degree and wait for the product to reach the adjusted temperature.
- The cooler or freezer door washer may be dirty, worn out, broken or not properly settled. >>> Clean or replace the washer. Damaged / torn door washer will cause the product to run for longer periods to preserve the current temperature.

The freezer temperature is very low, but the cooler temperature is adequate.

- The freezer compartment temperature is set to a very low degree. >>> Set the freezer compartment temperature to a higher degree and check again.

The cooler temperature is very low, but the freezer temperature is adequate.

- The cooler compartment temperature is set to a very low degree. >>> Set the freezer compartment temperature to a higher degree and check again.

The food items kept in cooler compartment drawers are frozen.

- The cooler compartment temperature is set to a very low degree. >>> Set the freezer compartment temperature to a higher degree and check again.

The temperature in the cooler or the freezer is too high.

Troubleshooting

- The cooler compartment temperature is set to a very high degree. >>> Temperature setting of the cooler compartment has an effect on the temperature in the freezer compartment. Wait until the temperature of relevant parts reach the sufficient level by changing the temperature of cooler or freezer compartments.
- The doors were opened frequently or kept open for long periods. >>> Do not open the doors too frequently.
- The door may be ajar. >>> Fully close the door.
- The product may have been recently plugged in or a new food item is placed inside. >>> This is normal. The product will take longer to reach the set temperature when recently plugged in or a new food item is placed inside.
- Large quantities of hot food may have been recently placed into the product. >>> Do not place hot food into the product.

Shaking or noise.

- The ground is not level or durable. >>> If the product is shaking when moved slowly, adjust the stands to balance the product. Also make sure the ground is sufficiently durable to bear the product.
- Any items placed on the product may cause noise. >>> Remove any items placed on the product.

The product is making noise of liquid flowing, spraying etc.

- The product's operating principles involve liquid and gas flows. >>> This is normal and not a malfunction.

There is sound of wind blowing coming from the product.

- The product uses a fan for the cooling process. This is normal and not a malfunction.

There is condensation on the product's internal walls.

- Hot or humid weather will increase icing and condensation. This is normal and not a malfunction.
- The doors were opened frequently or kept open for long periods. >>> Do not open the doors too frequently; if open, close the door.
- The door may be ajar. >>> Fully close the door.

There is condensation on the product's exterior or between the doors.

- The ambient weather may be humid, this is quite normal in humid weather. >>> The condensation will dissipate when the humidity is reduced.

The interior smells bad.

- The product is not cleaned regularly. >>> Clean the interior regularly using sponge, warm water and carbonated water.
- Certain holders and packaging materials may cause odour. >>> Use holders and packaging materials without free of odour.
- The foods were placed in unsealed holders. >>> Keep the foods in sealed holders. Micro-organisms may spread out of unsealed food items and cause malodour. Remove any expired or spoilt foods from the product.

Troubleshooting

The door is not closing.

- Food packages may be blocking the door. > > > Relocate any items blocking the doors.
- The product is not standing in full upright position on the ground. > > > Adjust the stands to balance the product.
- The ground is not level or durable. > > > Make sure the ground is level and sufficiently durable to bear the product.

The vegetable bin is jammed.

- The food items may be in contact with the upper section of the drawer. > > > Reorganize the food items in the drawer.

If The Surface Of The Product Is Hot.

- High temperatures may be observed between the two doors, on the side panels and at the rear grill while the product is operating. This is normal and does not require service maintenance! Be careful when touching these areas.



WARNING: If the problem persists after following the instructions in this section, contact your vendor or an Authorised Service. Do not try to repair the product.

使用本产品前，请阅读本手册！

亲爱的顾客：

我们的产品采用先进设备精心制造，并通过严格的质量控制检测，希望您能从中获取最大的效益。

在使用本产品前，建议您阅读整个用户手册。如果本产品转让他人，请一并移交用户指南给新的用户。

本指南将帮助您快速和安全地使用本产品。

- 安装和操作本产品前，请仔细阅读产品指南。
- 请始终遵循相关的安全说明。
- 用户指南应置于触手可及之处，以备日后参考。
- 请阅读随产品提供的任何其他文件。

请注意，本指南可能适用于多个产品型号。本指南清晰地标出了不同型号的变化。

	重要信息或者有用的提示。
	影响生命和财产安全的危险。
	有触电的危险。
	本产品的包装材料根据国家环境规定，采用可回收材料制成。

1	安全和环境说明	3	6	维护和清洁	26
2	您的冰箱	6	7	故障排除	27
2	您的冰箱	7			
3	安装	8			
3.1	适当的安装位置	8			
3.2	安装塑料楔子	8			
3.3*	调整支腿	8			
3.4	电气连接	10			
4	准备	11			
4.1	节能措施	11			
4.2	新鲜食物隔间的建议	11			
4.3	初次使用	11			
5	操作本产品	12			
5.1	指示灯	12			
5.2	指示灯面板	16			
5.3	冷冻新鲜食物	19			
5.4	储藏冷冻食物之建议	19			
5.5	深度冷冻信息	19			
5.6	放置食物	20			
5.7	门开警告	20			
5.8	冰温室	20			
5.9	果蔬盒	20			
5.10	湿度控制的果蔬盒 (FreSHelf)	20			
5.11	蛋托	20			
5.12	可移动中间部分	21			
5.13	变温室	21			
5.14	蓝光	21			
5.15	异味过滤器	21			
5.16	冷却室	22			
5.17	使用内部饮水机	23			
5.18	在最初的使用, 你将不得不	23			
5.19	制冰盒和冰储藏容器	24			
5.20	制冰盒	24			
5.21	制冰盒和冰储藏容器	25			

1 安全和环境说明

本节提供必要的安全指南，以防受伤和材料损坏。未遵守这些指南将使冰箱的各种保修失效。

既定用途

	警告： 确保该电器外壳或者内置结构中的通风开口不受任何阻碍。
	警告： 请勿使用机械装置或者其它手段，加速除霜过程，除非制造商建议这样做。
	警告： 请勿损坏制冷剂回路。
	警告： 请勿在该电器的食物储藏室使用电气装置，除非是制造商建议的类型。

本装置拟用于家庭和类似场合，例如

- 商店、办公室和其它环境中的员工厨房区域；
- 农房和在宾馆、汽车旅馆及其它居住型环境中由客户使用；
- 住宿和早餐型环境中；
- 给养和类似的非零售场合。

1.1. 一般安全性

- 存在体力、感知力或精神障碍的人员，如果没有掌握足够的知识和经验，或者儿童，不得使用本产品。此类人员必须在负责其安全的成年人的监督和指导下使用本装置。儿童不得使用本装置。
- 若发生故障，拔下插头。

- 拔下插头后，等待至少5分钟，再重新连接插头。
- 不使用时，请拔下插头。
- 请勿用湿手接触插头！拔插头时请勿拉扯电线，而应始终握住插头。
- 如果插座松脱，请勿连接冰箱插头。
- 安装、维护、清洁和修理过程中，应拔下产品插头。
- 若长时间不使用本产品，拔下插头，并取出内部所有食物。
- 电路卡位于产品上方后部（电卡盒盖）（1）的隔室打开时，请勿使用本产品。

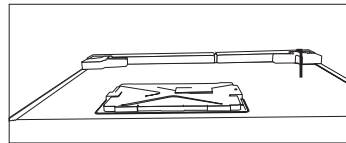
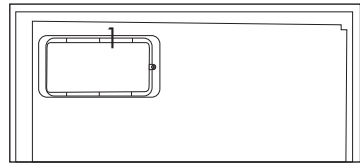

- 切勿使用蒸汽或蒸汽清洁材料清洁冰箱及融化内部冰块。蒸汽可能接触带电区域，并造成短路或触电！
- 清洁本产品时，请勿在上面洒水或倒水！有触电的危险！
- 若发生故障，请勿使用冰箱，否则，可能造成触电。采取任何措施前，请联系授权服务中心。
- 将产品插头插入接地的插座。接地工作必须由具备资格的电工完成。

重要的安全和环境说明

- 如果产品配置有 LED 类型的灯，如需更换或有任何问题，请与授权服务中心联系。
- 请勿用湿手接触冷冻食物！食物可能粘到您的手上！
- 请勿将瓶装或罐装液体放入冷冻室。其可能爆裂！
- 拧紧液体瓶盖后，直立放置。
- 请勿在产品附近喷洒易燃物质，可能着火或爆炸。
- 请勿将易燃材料或装有易燃气体（喷雾等）的物品放入冰箱内。
- 请勿在本产品顶部放置装有液体的容器。水飞溅到电气元件上可能导致发生触电或者火灾危险。
- 本产品淋雨、落雪、受到阳光照射和风吹均会影响到电气安全。重新摆放本产品时，请勿抓握门把手拉拽。把手可能会脱落。
- 小心您的双手或身体的任何部位不要被冰箱内的移动零件卡住。
- 请勿踩踏或倚靠在冰箱的门、抽屉或类似部位。这可能会造成本产品倾倒，并损坏部件。
- 小心不要缠住电线。

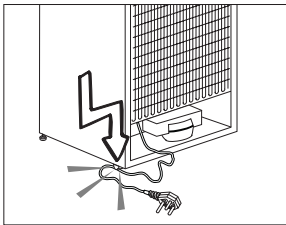

1.1.1 HC 警告

如果冰箱包含使用 R600a 气体的制冷系统，使用和移动冰箱时，小心避免损坏制冷系统及其管道。此气体易燃。如果制冷系统损坏，本产品应远离火源，并立即对房间通风。



本产品使用的气体类型在位于冰箱内部左壁上的标签上注明。

1.1.2 针对配有饮水机的型号

- 冷水入口压力最高为 90 psi (6.2 巴)。如果水压超过 80 psi (5.5 巴)，在主系统中，使用压力限制阀。如果不了解如何检查水压，可以寻求专业水管工的帮助。
- 如果安装环境有水击的风险，请务必使用水击防止设备。如果不确定安装环境是否有水击效应，请咨询专业的水管工。
- 请勿在热水入口安装。采取措施，防止软管冻结。水温操作间隔最低 33° F (0.6° C)，最高 100° F (38° C)。
- 只能使用饮用水。

1.2. 既定用途

- 本产品设计供家庭使用。不用于商业用途。
- 本产品应用来存放食物和饮料。
- 请勿将需要控制温度的敏感产品（疫苗、对温度变化敏感的药物、医用材料等）放入冰箱内。
- 制造商对使用不当或处理不当造成的损坏不承担任何责任。
- 自购买之日起的 10 年内，我们将提供原装备件。

1.3. 儿童安全

- 包装材料经置于儿童不可及之处。
- 儿童不得摆弄本产品。
- 如果冰箱门上有锁，钥匙应置于儿童不可及之处。

1.4. 符合 WEEE 指令 和报废产品处置

本产品符合 EU WEEE 指令(2012/19/EU)。本产品带有报废电子电器设备(WEEE) 的分类符号。

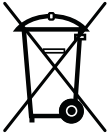

本产品采用可以重复利用和适合回收的优质零件和材料制成。在本产品使用寿命结束时，请勿将其作为日常的生活垃圾和其他废物进行处置。应将其送至回收电器电子设备的收集中心。有关这些收集中心的信息，请咨询当地的权力机构。

1.5. 符合 RoHS 指令

- 本产品符合 EU WEEE 指令(2011/65/EU)。其不含有该指令中指定的有害和禁用材料。

1.6. 包装信息

- 本产品的包装材料根据国家环境规定，采用可回收材料制成。包装材料不得与生活垃圾或其他废物一起处置。应将其送至当地机构指定的包装材料回收点。

2 您的冰箱

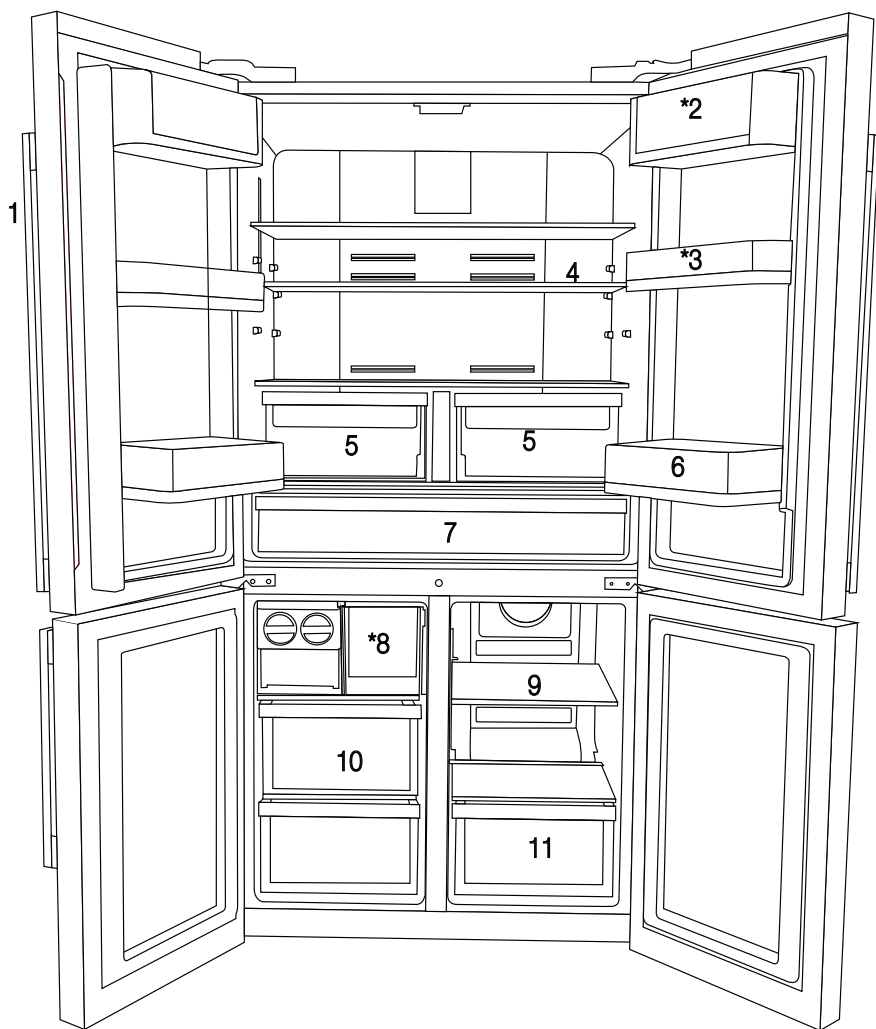

- 1- 控制和指示器面板
- 2- 黄油和干酪部分
- 3- 70 mm 移动门搁架
- 4- 冷藏室玻璃搁架
- 5- 冷藏室果蔬盒
- 6- 大瓶门搁架

- 7- 冰温室
- 8- 制冰盒抽屉
- 9- 冷却室搁架
- 10- 冷冻室抽屉
- 11- 变温室抽屉

* 可选



本手册中的图片都是示意图，可能与您的产品有所不同。如果主体零件没有包含在您购买的产品当中，表明其适用于其它型号。

2 您的冰箱

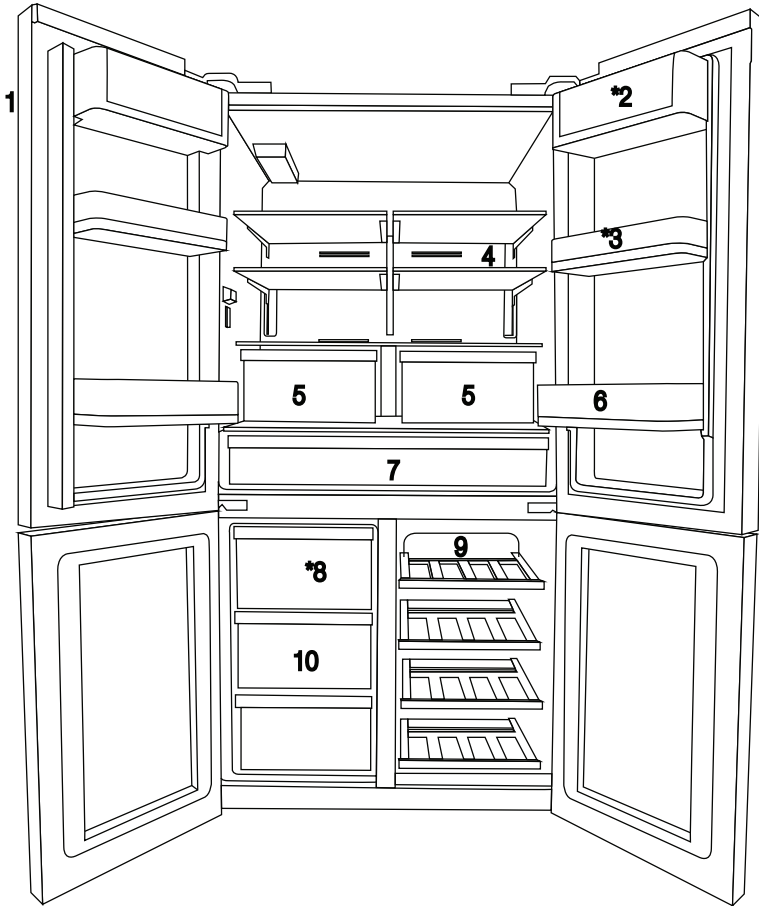

- 1- 控制和指示器面板
- 2- 黄油和干酪部分
- 3- 70 mm 移动门搁架
- 4- 冷藏室玻璃搁架
- 5- 冷藏室果蔬盒
- 6- 大瓶门搁架

- 7- 冰温室
- 8- 制冰盒抽屉
- 9- 冷却室搁架
- 10- 冷冻室抽屉

* 可选



本手册中的图片都是示意图，可能与您的产品有所不同。如果主体零件没有包含在您购买的产品当中，表明其适用于其它型号。

3 安装

3.1 适当的安装位置

请联系授权服务中心安装本产品。产品准备使用时，请参考用户手册中的信息，并确保水电连接适当。否则，请安排具有资质的电工和技工，实施必要的安排。



警告：对于由未经授权之人员实施的步骤导致的损坏，制造商不承担任何责任。



警告：安装期间，本产品插头不得插入电源。否则，有导致死亡或严重受伤的危险！



警告：如果即将放置本产品的房间门太窄，阻碍产品通过，应拆卸房门，且本产品侧着通过；如果仍不可行，请与授权服务中心联系。

- 将产品放置在平坦的地面，防止晃动。
- 产品安装位置距离热源（例如，炉盘、中央加热器和炉灶）至少 30 cm，距离电烤箱至少 5 cm。
- 安装后，产品不得受到阳光直射，亦不得处于潮湿的环境中。
- 在产品周围必须有适当的通风，以便获得高效的操作。如果冰箱放置在墙壁内的凹口，距离天花板和墙壁必须至少 5 cm。
- 请勿在温度降低于 -5°C 的位置安装冰箱。

3.2 安装塑料楔子

产品附带的塑料楔子用于在产品与后部墙壁之间提供必要的距离，促进空气流通。

1. 方法是，拆下本产品上的螺丝，并使用随楔子一起提供的螺丝。

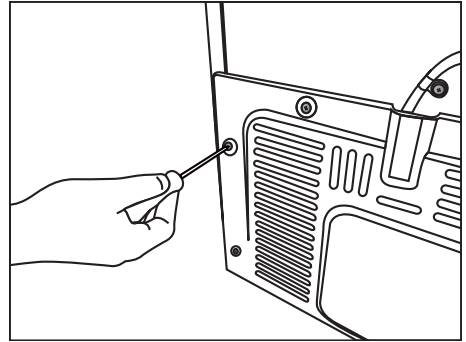

2. 如图所示，在后部通风口罩盖插入 2 个塑料楔子。

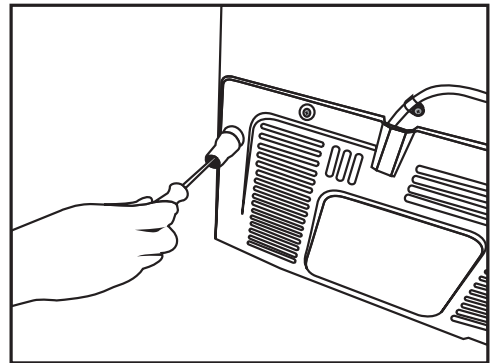

3.3* 调整支腿

安装后，如果产品不稳，可以调整支腿，向左或向右转动。

* 如果您的产品没有酒柜或没有安装玻璃门，则您的产品将不会配备可调式支架，而是配备固定式支架。

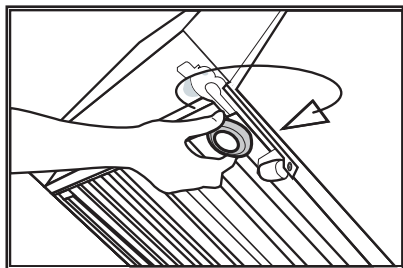
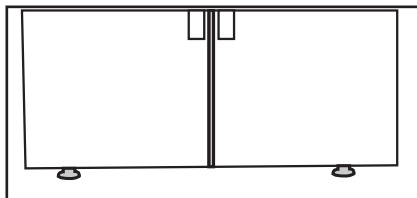

若要 竖直 调整 冰箱 门，
松开位于底部的固定螺母。
根据冰箱门的位置，转动调节螺母（顺时针/逆时针）。
转动固定螺母，以便固定住。
若要水平调整门，
松开位于顶部的固定螺母。
根据门的位置，调整侧面调整螺母（顺时针/逆时针）。
上紧顶部的固定螺母，以便固定住。

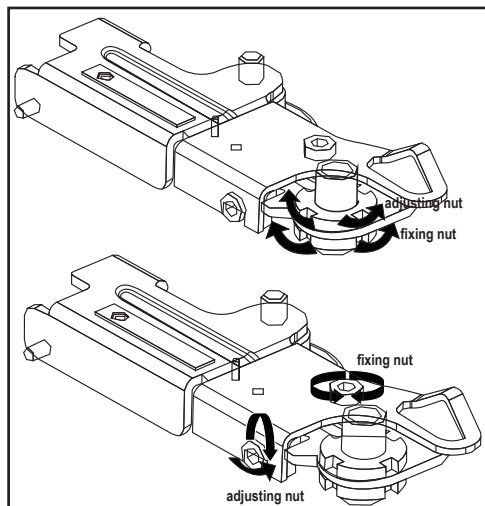

安装

- 上铰链组用3个螺钉固定。
- 安装完插座后，将铰链盖连接起来。
- 然后铰链盖用两个螺钉固定。

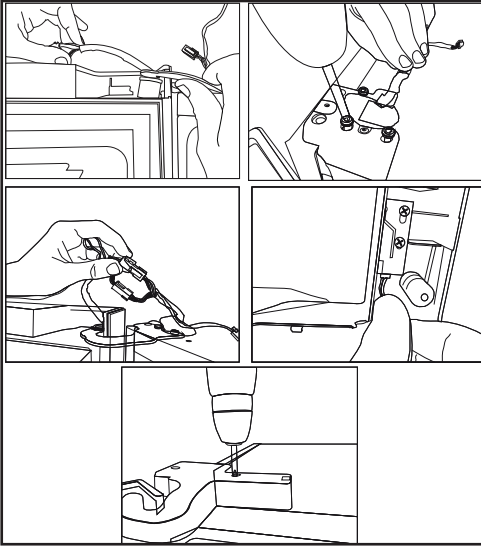

3.4 电气连接



警告：请勿通过扩充电缆或多用插头连接。



警告：受损的电源线必须由授权服务代理更换。



如果并排安装两台冰箱，必须至少间隔 4 cm。

- 本产品必须根据国家规定，在接地的情况下使用，否则，如果发生任何损坏，我公司不承担任何责任。
- 安装后，电源线插头必须触手可及。
- 在产品与比壁插座之间，请勿使用加长电线或无绳多用插座。

4 准备

4.1 节能措施



将冰箱连接到节能系统可能有危险，这可能导致本产品损坏。

- 请勿长时间敞开冰箱门。
- 请勿在冰箱内放置灼热的食物或饮料。
- 冰箱不可装入过多的食物。冰箱内的空气循环受到阻碍时，制冷能力将下降。
- 冰箱应远离受到阳光直射的位置。冰箱的安装位置距离热源（例如，炉盘、烤箱、加热器和炉灶）至少 30 cm，距离电烤箱至少 5 cm。
- 注意在密闭的容器内保存食品。
- 为了在冰箱的冷冻室放入最大数量的食物，必须拆除上方的抽屉，并放在铁丝搁架顶部。产品声明的耗电量是在拆除制冰盒和上方抽屉，放置最大数量的食物确定的。装入食物时，强烈建议您使用冷冻室和多功能区下方的抽屉。
- 放置食物时，注意不要阻碍冷冻室和多功能区风扇前部的气流。放入的食物与保护风扇隔栅前部至少留出 5cm 空间。
- 在冷藏室解冻食物可以节能和保持食物品质。

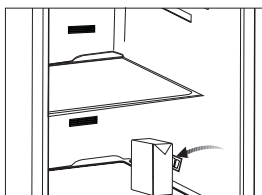
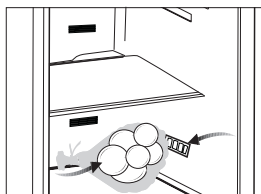

4.3 初次使用

使用本产品前，请务必根据“重要的安全和环境说明”以及“安装”章节中的说明，做好所有准备工作。

- 按照“维护和清洁”章节中的建议，清洁冰箱内部。开始使用冰箱前，确保内部干燥。
- 冰箱插入接地插座。冰箱门打开时，内部照明亮起。
- 在不放入任何食物的情况下，冰箱运转 6 小时，且不打开冰箱门，除非特别必要。



冰箱所在的房间温度至少为 10°C / 50° F。考虑到冰箱的效率，不建议在更低的温度条件下操作冰箱。



必须彻底清洁冰箱内部。



如果并排安装两台冰箱，必须至少间隔 4 cm。



在压缩机启动时，您将听到噪声。即使压缩机没有运转，制冷系统中密封的液体和气体也可能产生噪声，这是正常的。



可能感觉冰箱的前边温热。这是正常的。这些区域设计保持温热，以免发生冷凝。

4.2 新鲜食物隔间的建议

- 确保食物不会接触新鲜食物隔室的温度传感器。为了确保新鲜食物冷藏室保持理想的贮存温度，传感器不得被食物阻碍。
- 请勿在冰箱内放入热食或热饮。

5 操作本产品

5.1 指示灯

利用触控指示灯面板可以设置温度和控制与产品有关的其它功能，而不必打开产品的门。仅按下功能设置的相关按钮。

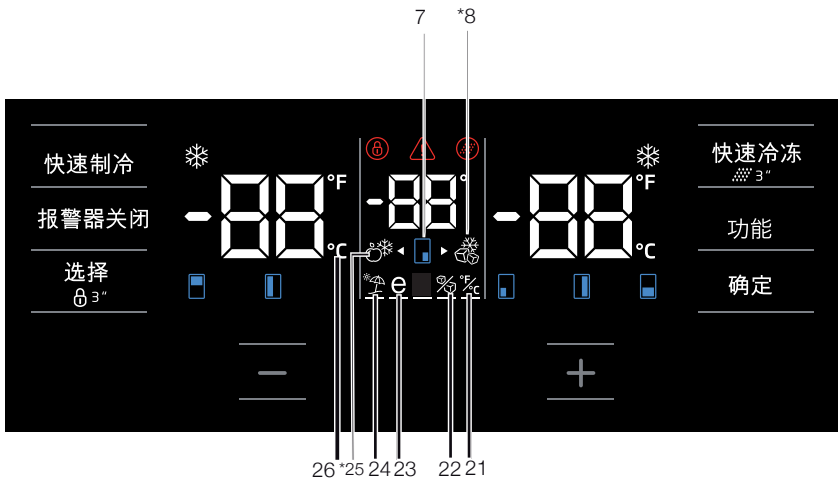
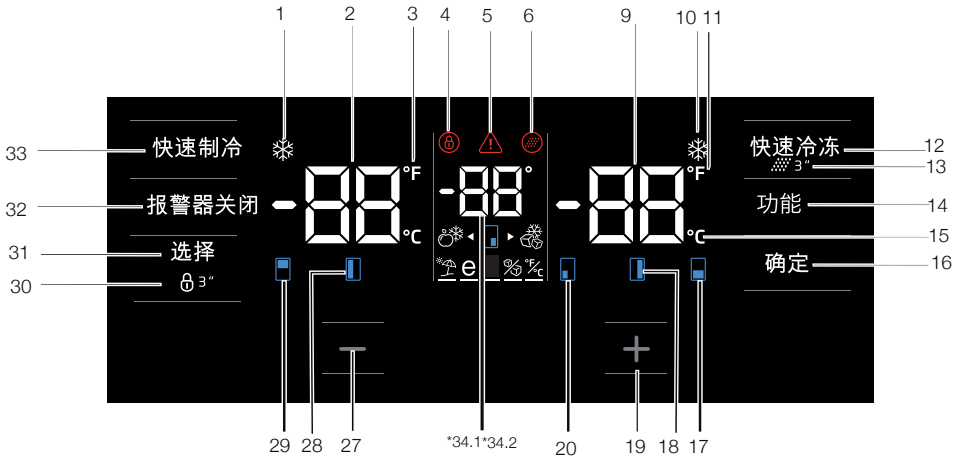

本手册中的图片都是示意图，可能与您的产品有所不同。如果主体零件没有包含在您购买的产品当中，表明其适用于其它型号。

操作本产品

1.快速制冷功能指示灯

快速冷藏功能启动时，指示灯亮起。

2.冷藏室温度指示灯

显示冷藏室温度；可以设置为

8,7,6,5,4,3,2,1。

3.华氏温度指示器

其为华氏温度指示器。激活显示华氏温度时，以华氏度为单位，显示温度设定值，且相关按钮开启。

4.键锁

同时按下键锁按钮 3 秒钟。键锁符号

将亮起，且激活键锁模式。如果键锁模式活动，按钮将不工作。再次同时按下键锁按钮 3 秒钟。“按键锁”图标将熄灭，并将退出“按键锁”模式。

如果想要防止修改冰箱的温度设置，按下键锁按钮。

5.电源故障/高温/错误警告

在电源故障、高温故障和错误警告期间，此指示灯亮起。电源长期故障期间，冷冻室达到的最高温度将在数字显示屏上闪烁。检查冷冻室中的食物后，按下报警器关闭按钮，清除警报。

如果您注意到指示灯亮起，请参阅手册中“故障检修建议措施”一节。

6.过滤器重置图标

过滤器需要重置时，该图标亮起。

7.温度设置图标

显示温度改变的隔室。该图标开始闪烁，说明该隔室已被选中。

8.Joker 冷冻室图标

使用 FN 按钮，在 Joker 冷冻室图标上方盘旋，图标将开始闪烁。按下 OK (确定) 键后，joker 冷冻室图标将开启，且作为冷冻室操作。

9.冷冻室温度指示器

显示冷冻室温度；可以设置为 -18, -19, -20, -21, -22, -23, -24。

10.快速冷冻功能指示器

快速冷冻功能开启时，其亮起。

11.华氏温度指示器

其为华氏温度指示器。激活显示华氏温度时，以华氏度为单位，显示温度设定值，且相关按钮开启。

12.快速冷冻功能按钮

按下该按钮，激活或解除快速冷冻功能。激活该功能时，冷冻室将冷却至低于预设值的温度。



您希望快速冷冻放在冷冻室的食物时，使用快速冷冻功能。如果您想冷冻大量的新鲜食物，将食物放入冰箱前，请激活该功能。



如果您没有取消，“快速制冷”功能将在最多 4 小时后或在冷藏室达到要求的温度后自行取消。



断电后，在电源恢复时，该功能不会重新调用。

13.过滤器重置

按下快速冷冻按钮 3 秒钟，重置过滤器。过滤器重置图标熄灭。

14.FN 按钮

使用该按键，可以在希望选择的功能之间切换。按下该按键时，要求激活或解除之功能的图标，和该图标的指示灯开始闪烁。如果在 20 秒内没有按下，将解除 FN 按钮。您需要按下此按钮，再次切换功能。

15.摄氏度指示器

这是摄氏度指示器。激活显示摄氏温度时，以摄氏度为单位，显示温度设定值，且相关图标开启。

16.OK 按钮

使用 FN 按钮导航功能后，在通过确定按钮取消功能时，相关图标和指示灯闪烁。

该功能激活时，其保持亮起。指示灯继续闪烁，以便显示亮起的图标。

17. 温度设置图标

显示温度改变的隔室。该图标开始闪烁，说明该隔室已被选中。

18. 温度设置图标

显示温度改变的隔室。该图标开始闪烁，说明该隔室已被选中。

19. 设置增大按钮

使用选择按钮，选择相关隔室；代表相关隔室的图标将开始闪烁。该过程期间，如果按下设置增加按钮，将增加设定值。如果在该循环中持续按住，设定值将返回初始值。

20. 温度设置图标

显示温度改变的隔室。该图标开始闪烁，说明该隔室已被选中。

21. 设置摄氏和华氏度指示器

使用 FN 键在该按键上方盘旋，并通过确认键，选择华氏度或摄氏度。选择相关的温度类型后，华氏度和摄氏度指示灯开启。

22. 制冰机关闭图标

按下 FN 键（直至其达到冰图标，和下方线条）关闭制冰机。在上方停留时，制冰机关闭图标和制冰机功能指示灯开始闪烁，这样，您可以了解制冰机是否开启。在您按下确定按钮时，制冰机图标连续亮起，且整个过程中指示灯持续闪烁。在 20 秒后，如果没有按下任何按钮，图标和指示灯保持亮起。这样，制冰机关闭。若要再次开启制冰机，在图标和指示灯上方停留，这样，制冰机关闭图标和指示灯将开始闪烁。在 20 秒后，如果没有按下任何按钮，图标和指示灯将熄灭，且制冰机将再次开启。



显示制冰盒是否开启。



选择该功能时，来自水箱的水流将停止。但是，可以从制冰机取出之前制的冰。

23. Eco fuzzy 功能图标

按下 FN 键（直至其达到字母 e 图标，和下方线条）激活 Eco fuzzy。您在 eco fuzzy 图标和 eco fuzzy 功能指示灯上方停留时，其开始闪烁。这样，您可以理解 eco fuzzy 功能是否激活。在您按下确定按钮时，eco fuzzy 图标连续亮起，且整个过程中指示灯持续闪烁。在 20 秒后，如果没有按下任何按钮，图标和指示灯保持亮起。这样，激活 eco fuzzy 功能。若要取消 eco fuzzy 功能，再次在图标和指示灯上方盘旋，并按下 OK 键。这样，eco fuzzy 功能图标和指示灯将开始闪烁。如果在 20 秒内没有按下任何按钮，图标和指示灯将熄灭，且将取消 eco fuzzy 功能。

24. 闲置功能图标

按下 FN 键（直至其达到伞形图标，和下方线条），激活闲置功能。在闲置功能图标和闲置功能指示灯上方盘旋时，其开始闪烁。这样，您可以理解闲置功能是否激活。在您按下确定按钮时，闲置功能图标连续亮起，并激活闲置功能。在该过程期间，指示灯持续闪烁。按下 OK 键，取消闲置功能。这样，闲置功能图标和指示灯将开始闪烁，且闲置功能将取消。

25. Joker 冷藏室图标

使用 FN 按钮选择 joker 冷藏室图标，并按下 OK 键，joker 隔室切换为冷藏室，并作为制冷器工作。

26. 摄氏度指示器

这是摄氏度指示器。激活显示摄氏温度时，以摄氏度为单位，显示温度设定值，且相关图标开启。

27. 设置减少功能

使用选择按钮，选择相关隔室；代表相关隔室的图标将开始闪烁。该过程期间，如果按下设置减少按钮，将减少设定值。如果在该循环中持续按住，设定值将返回初始值。

操作本产品

28. 温度设置图标

显示温度改变的隔室。该图标开始闪烁，说明该隔室已被选中。

29. 温度设置图标

显示温度改变的隔室。该图标开始闪烁，说明该隔室已被选中。

30. 键锁

同时按下键锁按钮 3 秒钟。键锁符号将亮起，且激活键锁模式。如果键锁模式活动，按钮将不工作。再次同时按下键锁按钮 3 秒钟。“按键锁”图标将熄灭，并将退出“按键锁”模式。

如果希望防止修改冰箱的温度设置，按下键锁。

31. 选择按钮

使用该按钮，选择希望修改温度的隔室。按下该按钮，在隔室之间切换。可以从隔室图标了解选择的隔室(7,17,18,20,28,29)。图标按钮闪烁时，表示选择了您希望修改温度设定值的隔室。之后，可以按下隔室设置减少按钮(27)和隔室设置增加按钮(19)修改设定值。如果在 20 秒内没有按下选择按钮，隔室图标将熄灭。您需要再次使用该按钮选择隔室。

32. 报警器关闭警告

如果电源故障/高温警报，检查了冷冻室内的食物后，按下报警器关闭按钮，清除警告。

33. 快速制冷功能按钮

该按钮有两个功能。若要激活或解除快速制冷功能，快速按下之。快速制冷指示器将熄灭，且产品恢复正常设置。



在您希望快速冷却放置在冷藏室的食物时，使用快速制冷功能。如果您想冷却大量的新鲜食物，将食物放入冰箱前，激活该功能。



如果您没有取消，“快速制冷”功能将在最多 8 小时或在冷藏室达到要求的温度后自行取消。



如果您快速多次按下“快速制冷”按钮，电路电子保护系统将启动，所以，压缩机将不会立即启动。



断电后，在电源恢复时，该功能不会重新调用。

34. 1 Joker 温度指示器

显示 joker 隔室的温度设定值。

34. 2 葡萄酒制冷室温度指示器

显示葡萄酒区的温度设定值。

5.2 指示灯面板

利用触控指示灯面板可以设置温度和控制与产品有关的其它功能，而不必打开产品的门。仅按下功能设置的相关按钮。

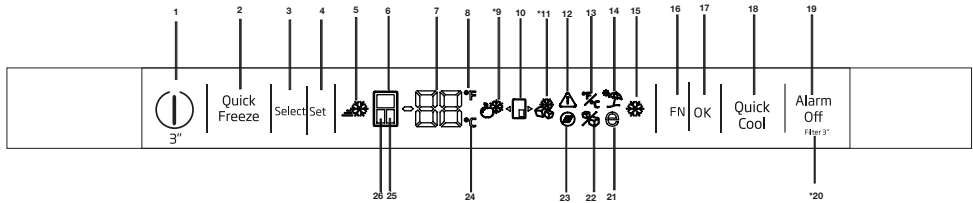

1- “开/关” 功能

按下“开/关”按钮3秒钟可关闭或开启冰箱。

2. “快速冷冻功能” 按钮

按下该按钮可激活或解除快速冷冻功能。激活该功能时，冷冻室将冷却至低于预设值的温度。



当您希望快速冷冻放在冷冻室的食物时，请使用快速冷冻功能。如果您想冷冻大量的新鲜食物，则请在将食物放入冰箱之前激活该功能。



如果您不取消该功能，则快速冷冻功能将在至多4小时后或者在冷藏室达到所需温度后自动取消。



断电后，在电源恢复时，该功能不会被重新调用。

3. “选择” 按钮

使用该按钮可选择希望修改温度的隔室。按下该按钮可在隔室之间切换。可以从隔室图标(6、25、24)了解选择的隔室。当某一隔室图标闪烁时，表示您已选择希望修改其温度设置值的隔室。然后，您可

以通过按下隔室温度设置值“温度调整”按钮(4)来更改设置值

4. “温度调整/温度降低”

按下后可降低所选隔室的温度。

5-“快速冷冻” 指示器

当激活“快速冷冻”功能时，该图标亮起。

6. “冷藏室” 指示器

当激活此指示器时，冷藏室的温度将显示在温度值指示器上。您可以通过按下“温度调整”按钮(4)将冷藏室温度设置为8、7、6、5、4、3、2或1°C/46、45、44、43、42、41、40、39、38、37、36、35、34或33°F。

7. “温度值” 指示器

显示所选隔室的温度值。

8. “华氏温度” 指示器

其为华氏温度指示器。当激活显示华氏温度时，温度设置值以华氏度为单位显示，且相关图标亮起。

9. Joker 冷藏室图标

当您使用FN按钮(16)选择“Joker 冷藏室”图标并按下“确定”按钮(17)时，joker隔室切换为冷藏室，并作为制冷器工作。

10. “Joker 隔室” 图标

其显示joker隔室图标。



本手册中的图片都是示意图，可能与您的产品有所不同。如果主体零件没有包含在您购买的产品当中，表明其适用于其它型号。

操作本产品

11. “Joker 冷冻室” 图标

当您使用 FN 按钮 (16) 选择 “Joker 冷冻室” 图标并按下 “确定” 按钮 (17) 时, joker 隔室切换为冷冻室, 并作为冷冻器工作。

12. “电源故障/高温/错误警告”

在电源故障、高温故障和错误警告期间, 此指示器亮起。在长时间电源故障期间, 冷冻室达到的最高温度将在数字显示屏上闪烁。当检查冷冻室中的食物之后, 请按下 “报警器关闭” 按钮 (19) 以清除警报。

13. “设置摄氏度和华氏度” 指示器

使用 FN 键将鼠标悬停在該按键上, 然后通过 “确定” 键选择华氏度或摄氏度。选择相关的温度类型后, “华氏度和摄氏度” 指示器亮起。

14. “闲置功能” 图标

按下 FN 键 (直至其达到伞形图标) 可激活 “闲置功能”。当您將鼠标悬停在 “闲置功能” 图标上时, 该图标开始闪烁。因此, 您可以了解 “闲置功能” 将激活还是取消。当您按下 “确定” 按钮后, “闲置功能” 图标将连续亮起, 因此 “闲置功能” 将激活。按下 “确定” 键可取消 “闲置功能”。这样, “闲置功能” 指示器将开始闪烁, 且 “闲置功能” 将取消。

15. “快速制冷功能” 指示器

当激活 “快速冷藏功能” 时, 该指示器亮起。

16. FN 按钮

使用该按键可在希望选择的功能之间切换。按下该按键后, 要求激活或解除之功能的图标以及该图标的指示器将开始闪烁。如果您在 20 秒内没有按下 FN 按钮, 其功能将取消。您需要按下此按钮才能再次切换功能。

17. “确定” 按钮

使用 FN 按钮导航各种功能后, 在通过 “确定” 按钮取消某一功能时, 相关指示器将闪烁。在激活该功能后, 该按钮将保持亮起。指示器将继续闪烁以显示其所在的图标。

18. “快速制冷功能” 按钮

该按钮具有两种功能。若要激活或解除快速制冷功能, 请短按此按钮。“快速制冷” 指示器将熄灭, 且产品将恢复其标准设置。

19. “报警器关闭” 警告

如果出现电源故障/高温警报, 在检查冷冻室内的食物后, 请按下 “报警器关闭” 按钮以清除 “高温警告” 图标 (12)。

20. “过滤器重置”

按下 “报警器关闭” 按钮 (19) 3 秒钟后, 过滤器将被重置。“过滤器重置” 图标熄灭。

21. “Eco Fuzzy 功能” 图标

按下 FN 键 (直至其达到字母图标) 可激活 “Eco Fuzzy 功能”。当您將鼠标悬停在 “Eco Fuzzy” 图标上时, 该图标开始闪烁。这样, 您可以了解 “Eco Fuzzy 功能” 将激活还是取消。当您按下 “确定” 按钮时, “Eco Fuzzy 功能” 图标将在此过程期间持续亮起。在 20 秒后, 如果您没有按下任何按钮, 此图标将保持亮起。这样, “Eco Fuzzy 功能” 随即激活。若要取消 “Eco Fuzzy 功能”, 请再次將鼠标悬停在该图标上, 然后按下 “确定” 键。这样, “Eco Fuzzy 功能” 图标将开始闪烁。如果您在 20 秒内没有按下任何按钮, 该图标将熄灭, 且将 “Eco Fuzzy 功能” 将取消。

22. “制冰机关闭” 图标

按下 FN 键 (直至其达到冰块图标) 可关闭制冰机。將鼠标悬停在 “制冰机关闭” 图标上时, 该图标开始闪烁, 因此您可以了解制冰机将开启还是关闭。当您按下 “确定” 按钮时, “制冰机” 图标指示灯将在此过程期间持续亮起。在 20 秒后, 如果您没有按下任何按钮, 该图标和指示灯将保持亮起。因此, 制冰机将关闭。若要再次开启制冰机, 請將鼠标悬停在该图标上。“制冰机关闭” 图标将开始闪烁。如果您按下 “确定” 按钮, 该图标将熄灭, 且制冰机将再次关闭。



显示制冰盒是开启还是关闭。



选择该功能时，来自水箱的水流将停止。但是，可以从制冰机取出之前制备的冰块。

23. “过滤器重置”图标

当过滤器需要重置时，该图标亮起。

24. “摄氏度”指示器

这是摄氏度指示器。当激活显示摄氏温度时，温度设置值将以摄氏度为单位显示，且相关图标将亮起。

25. “Joker 隔室”指示器

此指示器活动时，joker 隔室的温度会显示在温度值指示器上。您可以通过按下“温度调整”按钮 (4) 来更改 joker 隔室设置值。

26. “冷冻室”指示器

当激活此指示器时，冷冻室的温度将显示在温度值指示器上。您可以通过按下“温度调整”按钮 (4) 将冷冻室温度设置为 -18、-19、-20、-21、-22、-23 和 -24° C/0、-2、-4、-6、-8、-10 和 -12° F。

操作本产品

冷冻室设置	冷藏室设置	备注
-18° C	4° C	这是正常的建议设置。
-20, -22 或 -24° C	4° C	环境温度超过 30° C 时，建议使用这些设置。
快速冷冻	4° C	在您希望短时间冷冻食物时使用。在这一过程结束后，冰箱将恢复之前的模式。
-18° C 或更冷	2° C	如果您认为，由于高温条件或者经常打开和关闭冰箱门，导致冷藏室不够冷，可以使用这些设置。

5.3 冷冻新鲜食物

- 为保持食物品质，放入冷冻室的食物应尽快冷冻，可以使用快速冷冻功能。
- 在食物新鲜的时候即冷冻，可以在冷冻室放置更长时间。
- 包装需要冷冻的时候，并关闭包装，确保没有空气进入。
- 放入冰箱前，请务必对食物加以包装。使用冷冻容器、铝箔和防湿纸，塑料袋和其他包装材料，代替传统的包装纸。
- 标记每个食物包，注明冷冻前的日期。通过这种方式，每次打开冰箱时，可以区分每个食物包装的新鲜度。将之前冷冻的食物放置在冷冻室的前部，确保首先消耗之。
- 冷冻食物在解冻后必须立即使用，不得重新冷冻。
- 请勿一次冷冻大量食物。

5.4 储藏冷冻食物之建议

冷冻室温度至少设置为 -18° C。

1. 在购买后，尽快将食物放入冷冻室，避免解冻。
2. 冷冻前，请检查包装上的“使用截止”和“最佳食用”日期。
3. 确保食物包装完好。

5.5 深度冷冻信息

根据 IEC 62552 标准，对于每 100 升的冷冻容量，冰箱在 25° C 的环境温度，在 24 小时内将至少 4.5 kg 食物冷冻至 -18° C 或以下。

只有在 -18° C 或更低的温度，才能将食物保存较长时间。

您可以在数个月的时间内使食物保持新鲜（深度冷冻至 -18° C 或更低的温度）。

即将冷冻的食物不得与之前冷冻的食物相接触，以免部分解冻。

蔬菜用开水焯一下，并控干，可以在冷冻室存放更长时间。水控干后，将蔬菜放置在不透气的包装内，而后放入冰箱。香蕉、西红柿、生菜、芹菜、煮蛋、土豆和等食物不能冷冻。如果冷冻这些食物，营

操作本产品

养价值和口感都会受到不良影响。最终可能给人体健康带来风险。

5.6 放置食物

冷冻室搁架	各种冷冻食物，例如，肉、鱼、冰淇淋，蔬菜等。
冰箱搁架	放在盘子、盖板和密闭容器内的食物，蛋（在密闭容器中）
冷藏室门搁架	小包食物或饮料
果蔬盒	蔬菜和水果
保鲜区	熟食（短时间内食用的早餐食物、肉制品）

5.7 门开警告

(该功能可选)

在冰箱门打开超过 1 分钟时，会发出声音警报信号。关闭冰箱门或按下任何显示按钮（如果有）时，警报将静音。

5.8 冰温室

冰温室可以为冷冻食物做好准备。您也可以使用这些空间以比冷藏室低的温度存放食物。

您可以通过拆除冰温室，增大冰箱内的容量：

1. 向外拉冰温室，直至其停住。
2. 冰温室抬高大约 1 cm，并向外拉，从底座上拆卸制冷室。

5.9 果蔬盒

冰箱的果蔬盒专门设计保持蔬菜的新鲜度，而不会失去水分。对此，一般情况下，在果蔬盒周围发生冷空气流通。拆卸

果蔬盒前，请拆下与果蔬盒对齐的冰箱门搁架。

5.10 湿度控制的果蔬盒

(FreSHelf)

(该功能可选)

通过湿度控制果蔬盒，蔬菜和水果的湿度率得到良好控制，确保食物长时间保鲜。

我们建议莴苣、菠菜等多叶的蔬菜和对水分损失敏感的蔬菜应尽可能水平放置，而不是直立放置。

放置蔬菜时，应考虑蔬菜的比重。较重和较硬的蔬菜应放在果蔬盒底部，较轻和较软的蔬菜应放在顶部。

放在果蔬盒的蔬菜应从塑料袋中取出。如果长时间放置在塑料袋中，可能导致很快腐烂。出于卫生的原因，如果不希望蔬菜相互接触，可以使用穿孔的纸或类似材料。

请勿将梨，杏，桃子等放置在与其它水果和蔬菜相同的果蔬盒中，尤其那些产生大量乙烯的水果。这些水果散发的乙烯气体会导致其他水果更早成熟，或在较短时间内腐烂。

5.11 蛋托

您可以在冰箱门或者支架上安装蛋托。切勿将蛋托置于冷冻室。

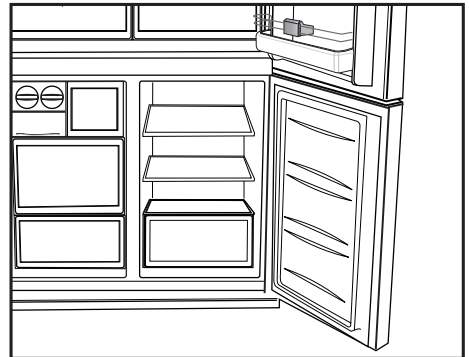

5.12 可移动中间部分

可移动的中间部分既定用于防止冰箱内的冷空气逸出。

1- 在关闭冷藏室的门之后，冰箱门上的垫圈挤压可移动中间部分的表面，从而提供密封。

2- 冰箱配备有可移动中间部分的另一个原因是，其可以增加冷藏室的净容量。标准的中间部分占据冰箱某些无用的空间。

3- 在关闭冷藏室左侧的门之后，可移动的中间部分关闭。

4- 切勿用手打开。在门关闭后，其在本体上的塑料零件的引导下移动。

5.13 变温室

冰箱的变温室可以设置为冷冻室、冷藏室、0°C、-6°C不同温区间室。

变温室设置为冷冻室，温度调节范围为-18/-20/-22/-24°C；变温室设置为冷藏室，温度调节范围为2/4/6/8/10°C；变温室设置为-6°C，可使肉类在易于切割的状态下最长储藏2周；变温室设置为0°C，可更长时间储藏熟食。

变温室切换为不同温区间室是通过一个制冷元件进行的。该制冷元件位于冰箱背面的封闭部分（压缩机室）中。该元件工作期间，会听到类似时钟秒针走动的声音。这是正常现象，并非产品故障。

5.14 蓝光

（仅限某些型号）

本产品的果蔬盒使用蓝色光照明。在果蔬盒中储存的食物通过蓝色光的波长效应，继续它们的光合作用，从而保持其新鲜度和增加维生素含量。

5.15 异味过滤器

冷藏室空气管道中的异味过滤器可以防止冰箱内产生异味。

5.16 冷却室

(该功能可选)

1 - 温度范围: 5 - 20 °C

如用作酒类储存区, 该间室前部可存放 28 瓶酒, 并配有一个可容纳 3 瓶酒的伸缩架。此处的最大装酒数量仅供参考, 测试使用的是“Bordelaise 75cl”标准大小的酒瓶。

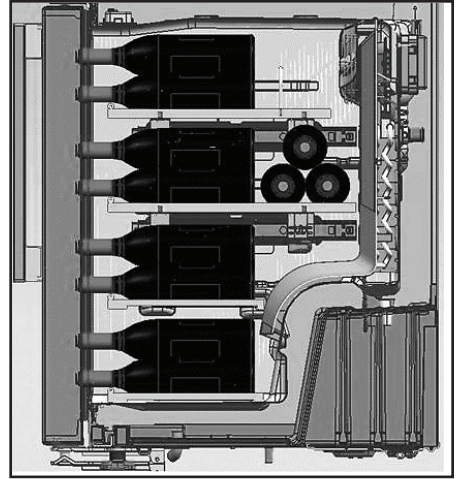
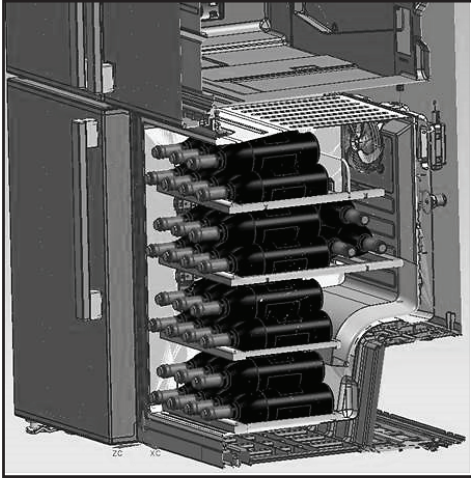

2- 建议的最佳饮用温度

建议: 如果酒柜中装有不同种类的酒, 请将酒柜温度保持在 12 °C 摄氏度, 与真正地窖的温度相同。对于饮用温度需为 6 - 10 °C 的白葡萄酒, 可考虑在饮用之前将酒瓶放入冰箱冷藏半小时, 使酒温保持在最佳饮用温度范围内。对于红葡萄酒, 饮用前, 需使之慢慢达到室温。

16 - 17°C	上等波尔多葡萄酒 - 红酒
15 - 16°C	上等勃艮第葡萄酒 - 红酒
14 - 16°C	特级干白葡萄酒
11 - 12°C	新酿低度果味红葡萄酒
10 - 12°C	普罗旺斯桃红葡萄酒, 法国葡萄酒
10 - 12°C	干白葡萄酒和乡村红葡萄酒
8 - 10°C	乡村白葡萄酒
7 - 8°C	香槟酒
6°C	甜白葡萄酒

操作本产品

3- 饮用前开瓶建议:

白葡萄酒

饮用前约 10 分钟开瓶

新酿红葡萄酒

饮用前约 10 分钟开瓶

浓郁香醇红葡萄酒

饮用前约 30 至 60 分钟开瓶

4- 开瓶后可保鲜多久?

如未喝完, 酒瓶须正确竖立放置, 存放于干冷之处, 保鲜时间如下所示:

	白葡萄酒	红葡萄酒
酒瓶内剩余 75%	3 至 5 天	4 至 7 天
酒瓶内剩余 50%	2 至 3 天	3 至 5 天
酒瓶内不足 50%	1 天	2 天

5.17 使用内部饮水机

(在一些模型)

将冰箱连接到水源或更换滤水器后, 冲洗水系统。使用坚固的容器来压制并保持饮水机杠杆5秒然后释放它5秒。重复直到水开始流动。一旦水开始流动, 继续压抑和释放机桨(5秒开, 5秒关)直至总共4加仑。(15L)已分配。这将冲洗空气从过滤器和水分配系统, 并准备使用的水过滤器。一些家庭可能需要额外冲洗。当空气从系统中清除时, 水会从分配器流出。让冰箱冷却24小时、使水冷却。每周分配足够的水以保持新鲜的供给。

在最初的使用, 你将不得不等待约24个小时的水降温。

扣动扳机后, 把杯子取出一会儿。

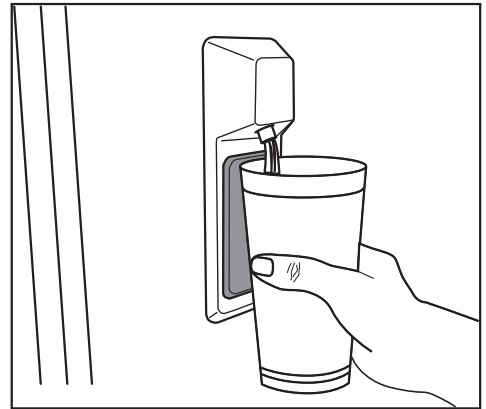

5.18 在最初的使用, 你将不得不等待约24个小时的水降温。

扣动扳机后, 把杯子取出一会儿。



连续分配5分钟后, 分配器将停止分配水以避免水浸。要继续配药, 再按分配器桨。

按住分配器垫时, 在分配器喷嘴下放置容器。

释放分配器垫停止配药。



从饮水机取水的头几杯水温暖是很正常的。



如果长期不使用饮水机、处理前几杯水以获得淡水。



在第一次使用冰箱之前并更换水过滤器后，饮水机可能会滴水。防止饮水机滴水或漏水，首次使用前，请排出空气从系统分配5-6加仑（约20升）通过饮水机的水并每次更换滤水器后将消除任何空气被困在系统和停止饮水机泄漏。如果水流有障碍物，则需要检查接头位置和机组后部的直线度。



如果你的饮水机漏了几滴水后，你分配了一些水，这是正常的。

5.19 制冰盒和冰储藏容器

制冰盒使用方法

* 在制冰盒放满水，并将其放入底座。冰块在两个小时便可以制作完成。取冰块时，不得从底座取下制冰盒。

* 将旋钮顺时针转动 90 度。

单元格中的冰块将掉落到下面的冰储藏容器中。

* 您可以取出冰储藏容器，并开始使用冰块。

* 您也可以根据需要，将冰块保留在冰储藏容器中。

冰储藏容器

冰储藏容器仅用于收集冰块。请勿在里面放水。否则，其可能破裂。

5.20 制冰盒

(仅限某些型号)

若要取出制冰盒的冰块，在冷藏室中的水槽中加水至最高水位。

在大约 15 天的热湿空气中，冰块抽屉中的冰块可能会彼此粘连，变成大块。这是正常的。如果无法将大块分开，可以清空冰盒，重新制冰。



如果水槽中的水超过 2-3 周，建议更换水槽中的水。



每隔 120 分钟听到的冰箱奇怪噪音是制冰和倒水的声音。这是正常的。



如果您不想制冰，按“结束制冰”图标停止使用制冰盒，节约冰箱的能源和延长使用寿命。



接水后，饮水机有一些水滴下来是正常的。

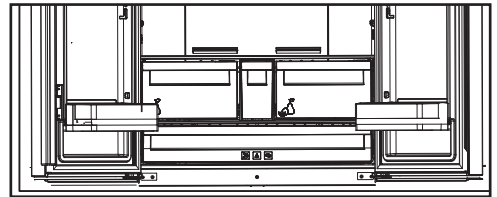

5.21 制冰盒和冰储藏容器

制冰盒使用方法

* 在制冰盒放满水，并将其放入底座。冰块在两个小时便可以制作完成。取冰块时，不得从底座取下制冰盒。

* 将旋钮顺时针转动 90 度。

单元格中的冰块将掉落到下面的冰储藏容器中。

* 您可以取出冰储藏容器，并开始使用冰块。

* 您也可以根据需要，将冰块保留在冰储藏容器中。

冰储藏容器

冰储藏容器仅用于收集冰块。请勿在里面放水。否则，其可能破裂。

6 维护和清洁

定期清洁冰箱将会延长其服务寿命。



警告：清洁冰箱之前，请断开电源。。

- 清洁时，请勿使用锋利的研磨器具、肥皂、家用清洁剂、洗涤剂、气体、汽油、蜡光剂和类似物质。
- 在水中化入一茶匙苏打。在水中浸湿一块抹布并将其拧出。使用这块抹布来擦洗冰箱，然后彻底擦干。
- 小心不要让水进入灯罩和其它电气部件。
- 对于非无霜型产品，冷藏室的后壁会出现水滴和最大可达一指宽度的霜花。请勿对后壁进行清洁；切勿向后壁涂抹油类或类似制剂。
- 只能使用略微润湿的超细纤维布清洁产品的外表面。海绵和其他类型的清洁布可能会刮伤该表面。
- 使用湿抹布清洁冰箱门。取出内部的所有东西，拆下冰箱门搁架和底座搁架。向上提取门搁架即可将其取出。清洗并擦干搁架，然后从上面向下滑动，将其放回原位。
- 请勿在冰箱的外部表面或镀铬部件上使用氯水或清洁产品。氯会使这些金属表面生锈。

6.1. 防止异味

产品有没有任何异味的材料制成。但是，如果在不适当的部分保存食品以及清洁内部表面不当，可能会产生异味。

为了避免产生异味，每 15 天请使用苏打来清洁冰箱内部一次。

- 将食品保存在密封的容器中。没有密封的食品可能会散发出微生物，并造成异味。
- 请勿在冰箱内保存过期和变质的食品。
- 不要使用锐物和研磨工具或肥皂、家居清洁剂、洗涤剂、汽油、苯、蜡等，否则塑料部件上的印章将会被擦掉，并且发生变形。用温水和软布清洗并擦干。

6.2. 保护塑料表面

泼洒到塑料表面的油可能会造成这些表面的损坏，必须使用热水立即进行清洁。

7 故障排除

联系服务人员之前，请检查此清单。这样做将节省您的时间和金钱。此清单包括与工艺和材料故障无关的一些常见的投诉。这里提及的某些功能可能不适用于您的产品。

冰箱不工作。

- 电源插头没有插好。>>> 将插头完全插入插座中。
- 连接到为冰箱提供电源的插座的保险丝或主电源保险丝已烧断。>>> 检查保险丝。

冷藏室侧壁上出现冷凝水（多功能区、冷藏区、控制区和变温区）。

- 环境过冷。>>> 请勿将产品安装在温度低于 -5°C 的环境中。
- 冰箱门打开过于频繁 >>> 不要过于频繁地打开冰箱门。
- 环境过于潮湿。>>> 请勿将冰箱安装在潮湿的环境中。
- 内含液体的食品保存在未密封的容器中。>>> 请将内含液体的食品保存在密封的容器中。
- 冰箱门一直打开。>>> 请勿长时间敞开冰箱门。
- 自动调温器设置为过低的温度。>>> 将自动调温器设置到适当的温度。

压缩机不工作。

- 在突然断电或者拔下和插入接头时，冰箱制冷系统中的气体压力尚未平衡，从而触发压缩机的热保护。冰箱将在大约 6 分钟后重新启动。如果冰箱此后没有重新启动，请联系服务人员。
- 除霜功能正在运行。>>> 对于全自动除霜产品而言，这是正常的。除霜功能会定期运行。
- 冰箱插头没有插好。>>> 确保电源线已插好。
- 温度设置不正确。>>> 选择正确的温度设置。
- 电源已断开。>>> 电源恢复后，冰箱会继续正常工作。

使用过程中冰箱的运行噪音逐渐增大

- 由于环境温度的变化，冰箱的运行性能可能会存在差异。这是正常的，并非故障。

冰箱运行过于频繁或时间过长。

- 新产品可能会比以前的产品大。较大的产品需要更长的运行时间。
- 室温可能较高。>>> 在较高室温下，冰箱通常需要较长的时间来运行。
- 冰箱插头可能刚插入不久或刚装入新的食品。>>> 冰箱插头刚插入不久或刚装入新的食品时，可能需要更长的时间才能达到设定的温度。这是正常的。
- 最近可能在冰箱中放入了大量热的食品。>>> 请勿将热的食品放入冰箱中。
- 冰箱门经常打开或长时间敞开。>>> 进入冰箱内部的热空气导致冰箱运行时间较长。请勿经常打开冰箱门。
- 冷冻室或冷藏室的门可能没有关严。>>> 检查确保这些门已经完全关闭。
- 冰箱可能设置为过低的温度。>>> 将温度设置为更高并等待冰箱到达调节好的温度。
- 冷藏室或冷冻室的门密封圈可能较脏、磨损、开裂或未适当固定好。>>> 清洁或更换密封圈。损坏/开裂的门密封圈将导致冰箱运行较长的时间才能保持当前的温度。

冷冻室温度很低，而冷藏室温度足够。

- 冷冻室的温度设置为很低。>>> 调高冷冻室的温度并再次检查。

冷藏室温度很低，而冷冻室温度足够。

- 冷藏室的温度设置为很低。>>> 调高冷藏室的温度并再次检查。

保存在冷藏室抽屉内的食品被冻住了。

- 冷藏室的温度设置为很低。>>> 调高冷冻室的温度并再次检查。

冷藏室或冷冻室内的温度过高。

故障检修

- 冷藏室的温度设置为很高。>>> 冷藏室的温度设置会影响冷冻室的温度。变更冷藏室或冷冻室的温度并等待，直到冷藏室或冷冻室达到调节好的温度水平。
- 冰箱门经常打开或长时间敞开。>>> 请勿过于频繁打开冰箱门。
- 冰箱门可能未关严。>>> 完全关闭冰箱门。
- 冰箱插头可能刚插入不久或刚装入新的食品。>>> 这是正常的。冰箱插头刚插入不久或刚装入新的食品时，可能需要更长的时间才能达到设定的温度。
- 最近可能在冰箱中放入了大量热的食品。>>> 请勿将热的食品放入冰箱中。

振动或噪音。

- 地面不平坦或不坚固。>>> 如果冰箱缓慢移动时产生晃动，请调节支脚来平衡冰箱。同时确保地面足够坚固，能够承载冰箱。
- 放置在冰箱上的任何物品均可能导致噪音的产生。>>> 取下放置在冰箱上的任何物品。

产品发出类似液体流动、喷溅等的噪音。

- 根据原理，冰箱工作时可能会涉及液体和气体的流动。>>> 这是正常的，并非故障。

产品发出类似风吹的噪音。

- 冰箱使用风扇来进行冷却。这是正常的，并非故障。

产品内壁出现冷凝水。

- 炎热或潮湿的天气会增加结冰和冷凝现象。这是正常的，并非故障。
- 冰箱门经常打开或长时间敞开。>>> 请勿过于频繁打开冰箱门；如果门已打开，请关上。
- 冰箱门可能未关严。>>> 完全关闭冰箱门。

产品外面或门之间出现冷凝水。

- 周围空气可能很潮湿，在潮湿气候下，这是很正常的。>>> 湿度下降时，冷凝水将会消失。

内部出现异味。

- 没有定期清洁冰箱。>>> 使用海绵、热水和苏打水定期清洁冰箱内部。
- 某些容器和包装材料可能会产生异味。>>> 使用没有异味的容器和包装材料。
- 食品放置在未密封的容器中。>>> 将食品保存在密封的容器中。没有密封的食品可能会散发出微生物，并造成异味。
- 从冰箱中取出任何已过期或变质的食品。

冰箱门未关。

- 食品包装袋可能妨碍冰箱门的关闭。>>> 重新放置妨碍关门的物品。
- 冰箱在地面上没有处于完全竖立位置。>>> 调节支脚以平衡冰箱。
- 地面不平坦或不坚固。>>> 确保地面足够坚固，能够承载冰箱。

蔬菜盒已卡住。

- 食品可能已接触到抽屉的顶板。>>> 重新摆放抽屉中的食品。



警告: 如果遵循本节中的指示操作后，问题仍然存在，请联系您的供货商或经过授权的服务人员。请勿自己尝试修理产品。