

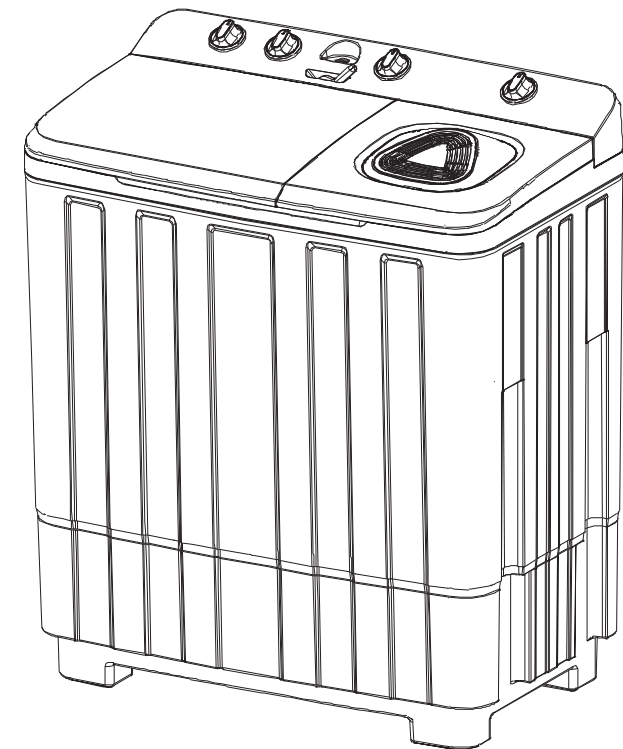

TWIN TUB WASHING MACHINE

MODEL: WTTA10503WP



Attachment

Content

Before using

Warning note	1
Parts name	3
How to use drainpipe	4
Water inlet hose installation ..	5

Operation

Preparation before operation	6
Use of detergent	7
Operation Step	8

Cleaning maintenance	10
Troubleshooting	11
Specification	12
Attachment	13

Name	Quantity	Position
use manual	one piece	spin tub
gland	one piece	spin tub
water inlet hose	one piece	spin tub

This appliance is intended to be used in household and similar applications such as:

- Staff kitchen areas in shops, offices and other working environments;
- Farm houses;
- By clients in hotels, motels and other residential type environments;
- Bed and breakfast type environments;
- Areas for communal use in blocks of flats or in launderettes.

Specification

Model	WTTA10503WP
Rated voltage and frequency	230V~/60Hz
Water level(mm)/ water capacity(L)	Low water level:265 Middle water level:327 High water level:389 Overflow water level:449 Low water capacity:61 Middel water capacity:77 High water capacity:89 Overflow water capacity:102
Water Inlet pressure(MPa)	0. 02MPa-0. 2MPa
Rated washing capacity(kg)	10.5
Rated capacity of spin (kg)	5.0
Wash noise(dB)	≤ 62
Spin noise (dB)	≤ 72
Dimensions(mm)	850x510x992
Rated input power(W)	Wash:420 Spin:180

Warning Note

The product belongs to I class appliance and pls be careful to use.



Warning:
Safe use of
electricity



Warning Symbol:Once a product contains this sign attached, it involves the safety. So the product must be operated according to the requirement to avoid any damage on the machine or user.



Forbidden Symbol:This sign means forbidden behavior which will cause damage to the machine and users.

- Do not wash raincoat or car cover that are waterproof. If there are clothes that floats on the water surface, you should note the label on the clothes and confirm if it is okay to be washed by washing machine to avoid any break.
- Do not use the clothes that contain the volatile substances such as gas.
- Waterproof clothing such as down jacket should not be put in the spin tub.



- Do not equip the machine in the bathroom where the place is humid and do not wash the machine.
- Do not put the machine on the place where it is hard to drain water.
- Do not put the wet clothing on the machine especially on the control panel.

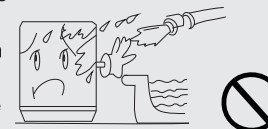

- Do not alter the specifications or attempt to modify this product in any ways.
- Do not use the water hotter than 50°C.
- Do not put the items on the washing machine.
- Keep the appliance away from the direct sunlight and heat sources like the heater.
- The distance between washing machine and wall is at least 5cm.

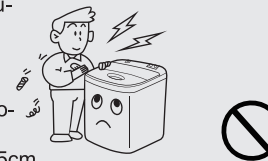

- Young children should be supervised to ensure that they do not play with the appliance.
- This appliance is not intended for use by person(including children) with reduced physical, sensory or mental capabilities, or lack of experience and knowledge, unless they have been given supervision or instruction concerning use of the appliance by a person responsible for their safety.

- Do not let the children climb the machine.
- Do not put the hand into the working machine. It is dangerous even if the speed is very slow.
- Do not let children play with the carton or any other packages.

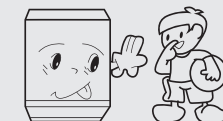

- When the machine with glass top lid is open, the angle between top lid and horizontal plane is more than 60 degree then the lid can be released, avoiding any accident.



Warning Note

- The washing machine should not be situated on the windproof carpet. If so , please adjust the feet in order to allow air to circulate freely. Do not put the machine on the high platform to avoid falling down.

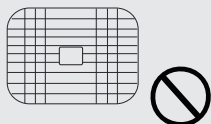

- Do not make the electric cable bended, stretched, twisted, strapped or changed, pressed or nipped.
- If the electric cable or plug is damaged or the socket becomes loose, they must be repaired or changed by our appointed repair stations or the professionals of our post-sale service department to avoid danger.

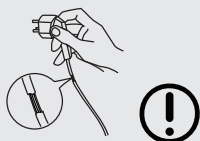

- Always unplug the appliance and turn off the water when the power is cut, moving or cleaning the washing machine, or it is not in use.
- When the program is over, the tap must be closed and unplug the power to ensure the cut of washing machine. Have a check on the power cable and plug before next-time use.
- Do not insert or pull off the plug with wet hand.

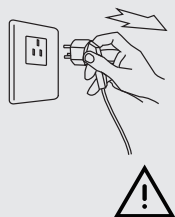

- Please insert the plug into the power socket with 230V single-phase three-stage AC.
- The plug must be the single special socket that meet national compulsory certification of qualified products.

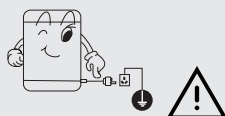

- The power must be connected with ground safely. The ground wire should be connected rightly and get away from underground water pipe and cable. If household electricity cannot reach the safety standard, it should be dealt with by professionals.



Troubleshooting

- When the washing items fall out of the spin tub:
If the item fall out of the spin tub, please contact with our after-sale service, otherwise it will hinder draining.
- When the water remained freezes:
Pour water(below 50°C) into washing tub to have a full soak and then move the pulsator.
Drain water totally to avoid the frozen water. And make the Change-over switch to the “soft” or “standard”. If the switch on the “drain”, it is difficult to melt on ce the water freezes.
- Other troubles
If there are problems on the machine, pull out and check the plug first. After confirming the problem, contact with us. Do not repair it by yourself.

Phenomena	Reason
The washing machine do not work	● Power cut? ● Plug is not inserted tightly? ● Something impede pulsator?
It does not drain	● drainpipe is bended or get blocked?
Noise during washing	Hard items put into the washing tub?
Noise and strenuous vibration	● The machine is balanced? ● Too much laundries? ● The clothes is put rightly?
Some water in the drain hose and the machine	The remaining water when the factory make test which is a normal phenomenon
Drop of water on the surface of tub	It is normal when environment temperature is higher than the normal water temperature.
The water cannot be stored	If there are some hard items remained in the drain valve? If water level of Washing tub exceed overflow level?

Cleaning maintenance

Note: • Close the tap after washing and discharge the drain hose.

- Before cleaning, pull plug off .
- Hang up the power cord and drain hose.



Lint filter cleaning

- The use of filter is a must during the washing process and should be cleaned after it is used.
- Make sure the lint filter into a proper position to avoid the filter falling off.

Cleaning step

- It is necessary to use lint filter during washing.
- After washing, please clean the lint filter in time.

Clean the lint filter according to the following steps:

1. Pull out the lint filter .(see Illustration 1)
2. Open the lint filter and wash it. (see Illustration 2)
3. Close the lint filter and install it to proper position.

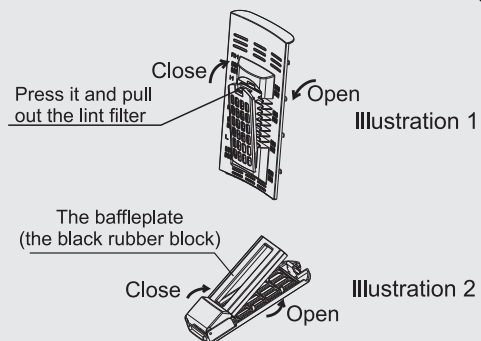

Maintenance

- Use neutral detergent when the machine is dirty. Do not use cleanser, volatile chemical materials to clean the machine, which will damage plastic parts and the surface.
- Do not spray towards the machine.
- Put the inlet hose down after working.
- Do not store water in the tub for a long time. Drain the water totally after using.
- Unplug it after using and hang the power cord in the right position.
- Clean the exterior cabinet of the appliance with soft cloth.

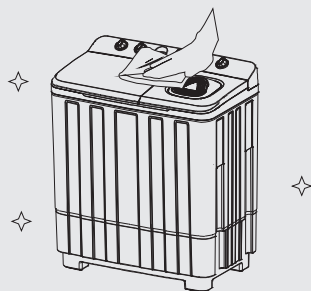

Parts Name

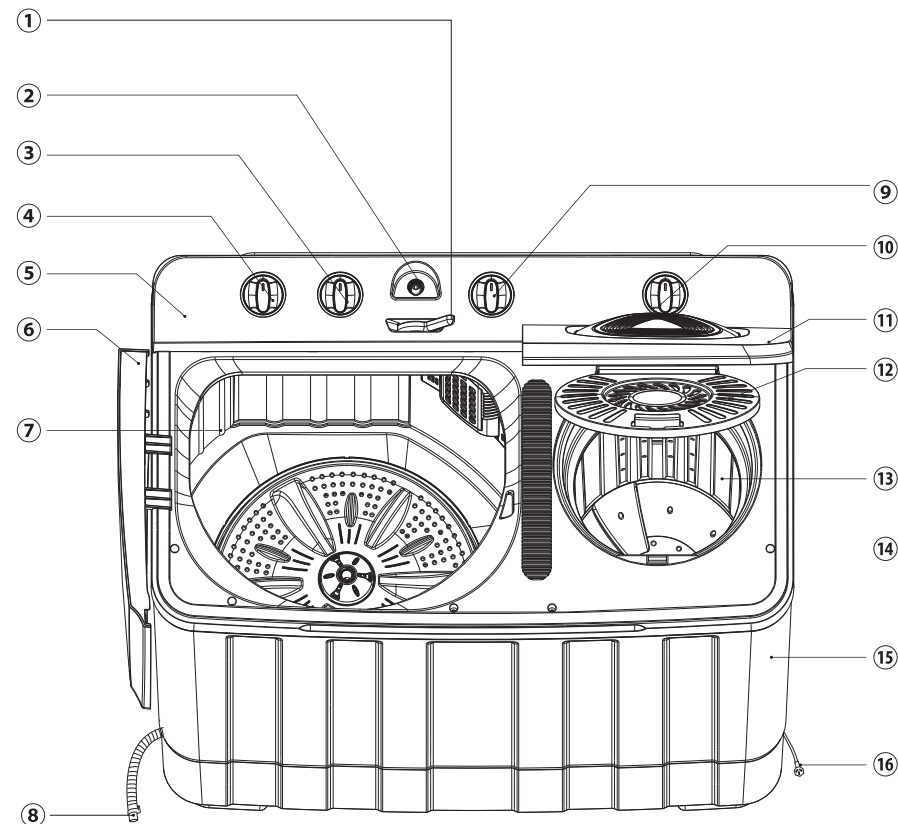

- | | |
|----------------------|---------------------------|
| ① Water inlet switch | ⑨ Drain selector |
| ② Inlet mouth | ⑩ Spin timer |
| ③ Wash selector | ⑪ Cover for spin |
| ④ Wash timer | ⑫ Inner cover of spin tub |
| ⑤ Control panel | ⑬ Spin tub |
| ⑥ Cover for washing | ⑭ Pulsator |
| ⑦ Washing tub | ⑮ Out frame |
| ⑧ Drainpipe | ⑯ Power cord |

How to use drainpipe

Please equip the washing machine as specified in the manual which is rather important to your safety.

How to use drainpipe

The drainpipe should be smooth

1. The height of drainpipe should be not more than 10cm, to avoid leakage or stop. If drain a long time, some water will stay in the machine.
2. Do not extrude the drainpipe ensure drain smoothly.
3. Drainpipe should be cut from the middle parts if it is too long; The drainpipe should be cut in bevel angle to drain smoothly.
4. If you need longer drainpipe, please buy another one; Inner diameter of the longer one should not less than 30mm and the length should not more than 1.5m.



Operation Step

(2) First spin process

1. Put the laundry into the spin tub smoothly.

2. Spin

- 1) Press the gland rightly
- 2) Close the spin top lid
- 3) Spin for 1-2 minutes

3. Spraying spin

- 1) Open the top lid of spin.
- 2) Put the inlet hose into the water inlet mouth and open the water tap. The water could spray and wash the laundry evenly to get rid of the foam.
- 3) Close the outer tub cover and spin for 1-2 minutes.

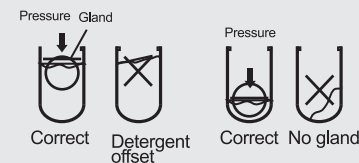

(3) Rinse Process

Put the laundry into the washing tub and select suitable water speed according to the laundry.

Stored rinse (repeated 2-3 times spin and rinse)

1. Fill the water to the suitable water level.
2. Time washer should be adjusted to 2-3 minutes to rinse. When the laundry is less, select "soft"

(4) Second spin process

1. Put the laundry into the spin tub smoothly.
2. Put the gland rightly and close the spin tub cover.
3. Select the spin time according to the laundry. If there is noise during the spin, please replace the laundry smoothly.

- when the machine is spinning, if at the same time drain water, it should spin 1 min at first, and then to start drain water, otherwise it will stop as there are too much water in spin tub.
- when the machine is spinning, if open the spin tub cover, the machine will pause spin, close the cover of spin tub, the machine will go on spin.

Operation Step

1.Preparation before washing

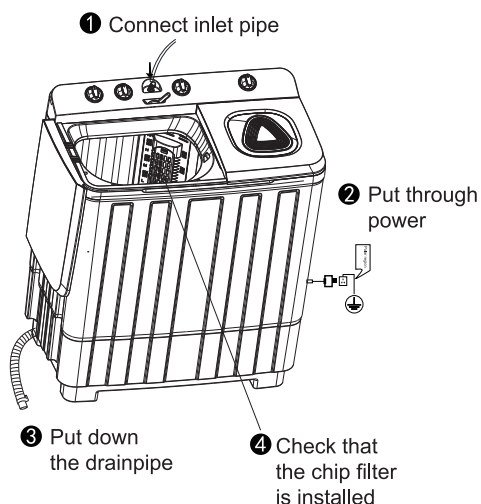

2.Washing Order

If the time should be set within 2 minutes, the timer should be set up more than 6 minutes first, then turn back to the 2 minutes.

Change-over switch should be rotated forcibly.

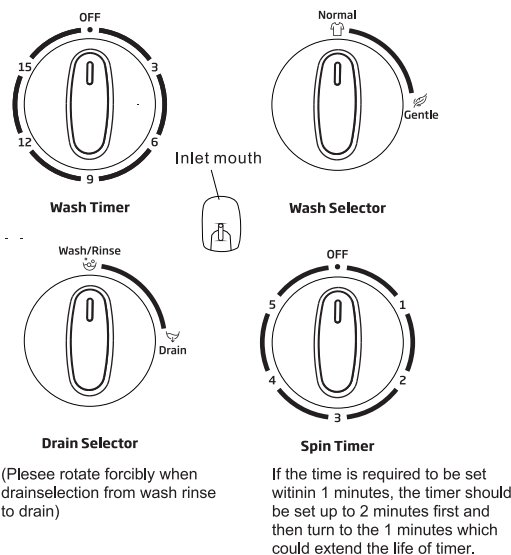

(1) Wash process

1. Fill water to the selected level. Add washing powder and then run for 30 seconds to dissolve it completely.
2. Put laundries in and add water to the suitable water level.
3. Select the water speed according to the laundry.
4. Select the washing time according to the laundry.
5. After washing, select the "drain".

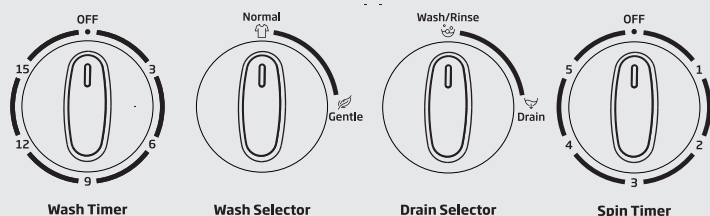

Water inlet hose installation

Water inlet hose installation

- The instructions for appliances connected to the water mains by detachable hose-sets shall state that the new hose-sets supplied with the appliance are to be used and that old hose-sets should not be reused.
- Please install the hose according to the model. Insert the water inlet hose into the water inlet mouth of control Panel(Refer to the right picture: control panel)

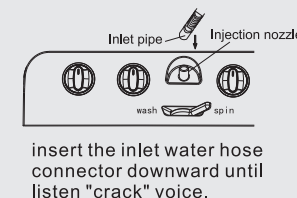

Water selector

Select water level according to the washing quantity.
(Choose water level: "high", "middle", "low")

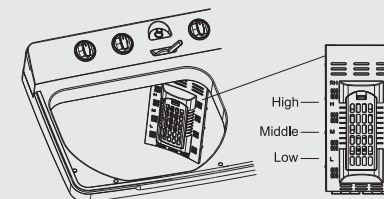

Lint Filter B Installation

Insert the bottom of the filter into the hole properly, then press the top of the filter to make it into the proper position.

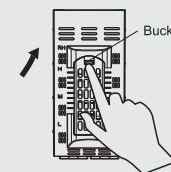

Preparation before operation

How to classify the laundry

- Make sure if there is any special requirements for the laundry.
- Before washing ,empty all pockets of small objects which may have been left inside(coin、 keys and etc.) As these could damage the drain pump.
- Knot the long band, fasten the buttons and close the zippers.
- Do not overload the machine. Load the laundry loosely.
- Turn around the clothes with buttons to avoid any noise.



Additional Notes:

- Make sure the laundries are washable.
- The broken clothes should be mended before being washed.
- Colored clothes should be washed separately from white ones.
- Please immerge the non-absorbable laundries by hand.
- Some stains such as fruit, wine, grass, rust etc. are difficult to remove and should be treated before washing with specific pr-oducts, which can be found in most household shops. In somecases it may help to soak the stain before washing with a special pre-soak product or biological detergent.
- Overturn the nap fabric and long floss laundries before putting them into the machine.
- Do not put the laundries polluted by chemicals into the machinedirectly.
- Very small item(handkerchiefs, ribbons, socks etc) should be w-ashed in a washing bag or a pillow case.

Use of detergent

How to use bleach

- Fill water to the selected level, dilute the bleach in the container, and pour it slowly into the washing tub.
- Do not use bleach for colored or figured laundries as they are prone to lose colors.
- Do not put bleach to laundries directly.
- Refer to the manual for the usage and quantity of the bleach.
- Please dissolve powder bleach before use.

How to use the washing powder

- Dissolve in the machine directly (not suitable for preset program)
 - 1.Low water level.
 - 2.Add the washing powder, and run for 30 seconds to dissolve it completely.
 - 3.Put laundries in, select suitable water level.
- The instant dissolving of the washing powder
 - 1.Prepare warm water of 30 in a container.
 - 2.Pour the powder while stirring to fully dissolve it.
- The washing powder is more prone to pollute the laundries than the detergent, therefore, please use it with proper dosage.
- The dosage of the washing powder, please refer to washing powder manual.
- It is suggested to use low foam washing powder.