

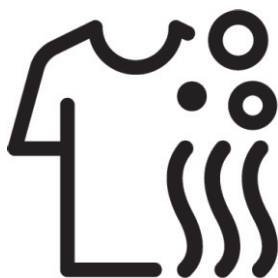

Washer-Dryer

User Manual



B1D85364WBEE
B1D85364WWEE



EN/ET/SQ/BG/HR/HU/EL

Please read this user manual first!

Dear Customer,

Thank you for choosing a Beko product. We hope that you get the best results from your product which has been manufactured with high quality and state-of-the-art technology. Therefore, please read this entire user manual and all other accompanying documents carefully before using the product.

Follow all warnings and information in the user manual. Thus, you protect yourself and your product against possible dangers.

Keep the user manual. If you hand over the product to someone else, provide the user manual as well. Warranty terms, usage and troubleshooting methods of your product are in user guide.

Symbols and Definitions

The following symbols are used in the user guide:







	Danger that could result in death or injury.
	Important information or useful hints about usage.
	Read the user manual.
	Recyclable materials.
	Hot surface warning.
	
WARNING	Danger that may result in property damage to the product or its environment.

Table of Contents

1	Safety Instructions.....	4
1.1	Intended Use.....	4
1.2	Safety of Children,	4
1.3	Electrical Safety.....	5
1.4	Handling Safety	6
1.5	Installation Safety.....	6
1.6	Operational Safety.....	8
1.7	Drying Safety	9
1.8	Maintenance and Cleaning Safety ..	12
2	Important Instructions for Environment	13
2.1	Compliance with WEEE Directive.....	13
2.2	Package Information.....	13
3	Technical Specifications	14
4	Installation.....	15
4.1	Appropriate Installation Location.....	15
4.2	Removing Transportation Safety Bolts	16
4.3	Connecting to Water Supply.....	16
4.4	Connecting the Drain Hose to the Drain.....	17
4.5	Adjusting the Stands	19
4.6	Electrical Connection	19
4.7	Handling the Product.....	19
5	Preliminary Preparation	21
5.1	Sorting the Laundry	21
5.2	Preparing Laundry for Washing	21
5.3	Tips for Energy and Water Saving.....	21
5.4	Start Up.....	21
5.5	Loading the Laundry.....	22
5.6	Correct Load Capacity.....	22
5.7	Using Detergent and Softener	22
5.8	Tips for Efficient Washing.....	25
5.9	Tips for Efficient Drying.....	26
6	Operating the Product.....	28
6.1	Control Panel	28
6.2	Symbols on the Display	29
6.3	Preparing the Laundry	30
6.4	Preparing the Laundry for Drying	30
6.5	Sort the Laundry According to Colour and Degree of Soiling	31
6.6	Degree of Soiling	31
6.7	Sorting the Laundry According to Care Label Specifications	32
6.8	Table of Wash Cycle.....	33
6.9	Various Cycles.....	35
6.10	Various Functions.....	36
6.11	How to Use the Appliance.....	38

6.12	Cancelling the Programme.....	40
6.13	End of Programme.....	40
6.14	Standby Mode.....	40
7	Maintenance and Cleaning	41
7.1	Cleaning the Detergent Drawer.....	41
7.2	Cleaning the Loading Door and the Drum.....	41
7.3	Cleaning the Loading Door and the Drum.....	42
7.4	Cleaning the Mesh Filter in the Water Inlet Hose and the Water Inlet Valve ..	42
7.5	Cleaning the Mesh Filter in the Water Inlet Hose and the Water Inlet Valve ..	42
8	Troubleshooting	44
9	DISCLAIMER / WARNING	49



1 Safety Instructions

This section includes the safety instructions necessary to prevent the risk of personal injury or material damage.

Our company shall not be held responsible for damages that may occur if these instructions are not observed.

- Installation and repair operations shall always be performed by Authorized Service.
- Use original spare parts and accessories only.
- Do not repair or replace any component of the product unless it is clearly specified in the operation manual.
- Do not modify the product.



1.1 Intended Use

- The service life of your product is 10 years. During this period, original spare parts will be available to operate the appliance properly.
- This product has been designed for domestic use. It is not for commercial purposes, or it should not be used out of its intended use.
- Use only for washing and drying textile products that are marked accordingly.

- The manufacturer assumes no responsibility for any damage due to misuse or mishandling.
- This appliance is intended to be used in household and similar applications. For example;
 - Personnel kitchens of stores, offices and other work environments,
 - Ranches,
 - By customers of hotels, motels and other accommodation facilities
 - Bed and breakfasts, hostel-like environments,
 - Common areas of apartment blocks or laundries.



1.2 Safety of Children, Vulnerable Persons and Pets

- This product may be used by children aged 8 years and older and persons with underdeveloped physical, sensory or mental capabilities or lack of experience and knowledge if they have been given supervision or instruction concerning use of the appliance in the product safe way and the hazards involved.
- Children under the age of 3 should be kept away unless continuously supervised.

- Electrical products are dangerous for children and pets. Children or pets should not play with, climb on top or inside the product. Check inside the product before use.
 - Use child lock to prevent children from intervening with the product.
 - Do not forget to close the loading door when leaving the room where the product is located. Children and pets may get locked inside and drown.
 - Children should not perform cleaning and user maintenance works without an adult's supervision.
 - Keep the packaging materials away from children. Risk of injury and suffocation.
 - Keep all detergents and additives used for the product away from children's reach.
 - Cut the power cable and break and deactivate the locking mechanism of the loading door before disposing of the product for children's safety.
-  **1.3 Electrical Safety**
- Product should be unplugged during installation, maintenance, cleaning and repair procedures. Unplug the product or turn off the fuse.
 - Damaged power cables should be replaced by the authorised service in order to prevent possible danger.
 - The product should not be fed via an external switching device such as a timer or connected to a circuit that is regularly switched on and off by a device.
 - Do not tuck the power cord under the product or to the rear of the product. Do not put heavy items on the power cord. Do not over bend, crush and touch the power cable to sources of heat.
 - Only use the original cable. Do not use cut or damaged cables.
 - Do not use an extension cord, multi-plug or adaptor to operate your product.
 - Extension cords, multi-socket outlets, adapters or portable power supplies can overheat and cause a fire. Make sure not to place power sockets and portable power supplies near or behind the product.
 - The plug shall be easily accessible. If this is not possible, a mechanism that meets the electrical legislation and that disconnects all terminals from

the mains (fuse, switch, main switch, etc.) shall be available on the electrical installation.

- Do not touch the plug with wet hands.
- When unplugging the appliance, don't hold the power cord, but the plug.
- Make sure the plug is not wet, dirty or dusty.
- Never connect your product to electricity saving devices. Such systems are harmful to the product.

1.4 Handling Safety

- Unplug the product before moving, remove the water outlet and water main connections. Drain any water left inside the product.
- This product is heavy, do not handle it by yourself. It may cause injuries if your product falls on you. Do not hit and drop the product while carrying.
- Do not hold parts such as the laundry loading door to lift and move the product. The upper tray should be tightly fixed for moving.
- Carry the product in an upright position. If it cannot be carried upright, tilt it to the right side in frontal view.

- Make sure that the hoses as well as the power cable are not folded, pinched or crushed after the product is fitted into its place after installation or cleaning procedures.

1.5 Installation Safety

- Check the information on the manual and installation instructions to prepare the product for installation and make sure the electrical mains, clean water mains and water outlet are suitable. If not, call a qualified electrician and plumber to have them make the necessary arrangements. These operations are the responsibility of the customer.
- Prior to commencing the installation, be sure to switch off the fuse to deactivate the power supply for the line to which the product will be connected.
- This product is intended for use at altitudes not exceeding 2000 meters above sea level.
- Check for any damage on the product before installing it. Do not have the product installed if it is damaged.

- Always wear personal protective equipment (gloves, etc.) during product installation, maintenance and repair. There is a risk of injury.
- Injuries may occur if hands are put into uncovered slots. Close the holes of the transportation safety bolts with plastic plugs.
- Do not install or leave the product at locations where it may be exposed to external environment conditions.
- Do not install the product at locations where temperature drops below 0°C.
- Do not place the product on a carpet or similar surface. It would create fire hazard since it cannot receive air from underneath.
- Place the product on a level and hard surface and balance with the adjustable legs.
- Connect the product to a grounding plug protected by a fuse suitable to the current values on the type label. Make sure the grounding is carried out by an expert electrician. Do not use the product without suitable grounding to local/national regulations.
- Plug the product in a socket with voltage and frequency values suitable to those indicated on the type label.
- Do not plug the product to loose, broken, dirty, greasy sockets or sockets that has come out their seats or sockets with a risk of water contact.
- Use the new hose set provided with the product. Do not re-use old hose sets. Do not make additions to the hoses.
- Connect the water inlet hose directly to the water tap. The pressure from the tap should be minimum 0.03 MPa (0.3 bars) and maximum 1MPa (10 bars). 10 to 80 litres of water should be running from the tap in a minute in order for the product to function properly. If the water pressure is above 1 MPa (10 Bars), a pressure-reducing valve should be fitted. The maximum allowed temperature is 25°C.
- Fit the end of the water discharge hose to the dirty water discharge drain, the sink or the bathtub.
- Place the power cable and hoses in locations without risk of tripping.
- Do not install the product behind a door, a sliding door or at another location that will prevent the door from opening completely.

- If a dryer is to be placed on the product, fix with a suitable connection apparatus obtained from the authorised service.
- There is a risk of contact with electrical pieces when the upper trays is removed. Do not dismantle the upper tray of the product.
- Place the product at least 1 cm away from the edges of furniture.
- Make sure the room in which the installation performed is adequately ventilated, as there may be a risk of undesirable gases coming out of the device igniting other fuels in the room or interacting with an open flame.
- Do not place sources of ignition (burning candle, cigarettes, etc.) or sources of heat (irons, furnaces, ovens, etc.) on top of or near the product. Do not put inflammable/explosive materials near the product.
- Do not get on the product.
- Unplug the product and turn off the tap if you will not be using the product for long periods.
- Detergent/maintenance materials may splash out of the detergent drawer if it is opened while the machine is working Contact of the detergent with your skin and eyes is dangerous.

1.6 Operational Safety

- When you are using the appliances, use only detergents, softeners and supplements suitable for washing machines.
- Do not use chemical solvents on the product. These materials contain an explosion risk.
- Do not operate defective or damaged products. Unplug the product (or turn off the fuse it is connected to), turn off the water tap and call an authorised service.
- Make sure pets do not climb inside the product. Check inside the product before use.
- Do not force open the locked loading door. The door will open once the washing is completed. If the door does not open, use the solutions for “loading door does not open” error in the Troubleshooting section.
- Do not wash elements contaminated with gasoline, kerosene, benzene, reducers, alcohol or other inflammable or explosive materials and industrial chemicals.

- Do not directly use dry cleaning detergent and do not wash, rinse, spin or dry laundry contaminated with dry cleaning detergent.
- Do not place your hands into the rotating drum. Wait until the drum no longer rotates.
- Do not place your hands or a metal object under the machine.
- If washing laundry at high temperatures, the discharged washing water would burn your skin if in contact with your skin, for ex. when the draining hose is connected to the tap. Do not touch the discharge water.
- Take the following precautions to prevent formation of biofilm and malodours:
 - Make sure the room where the washing machine is placed is well ventilated.
 - Wipe the door gasket and loading door glass with a dry and clean cloth at the end of the programme.
- The glass of the loading door will heat up when washing or drying at high temperatures. Therefore, do not allow especially children to touch the loading door glass while washing or drying.

- Before disposing of worn out and no longer usable items:
 1. Unplug the power plug and remove it from the socket.
 2. Cut the power cable and disconnect it with the plug from the appliance.
 3. Break the locking mechanism of the loading door to render it inoperable.
 4. Do not allow children to play with the outdated product.

1.7 **Drying Safety**

- Laundry that has been previously washed, cleaned, contaminated, or stained with gasoline/gas, dry cleaning solvents or other inflammable/explosive materials should not be dried in the machine because they give off inflammable or explosive vapours. Otherwise, fire hazard arises.
- Laundry contaminated with materials such as vegetable or mineral oil, acetone, alcohol, gasoline, gas oil, stain removers, naphtha, turpentine, paraffin or paraffin removers should be washed separately in hot water by adding extra detergent before being dried in the washing machine with dryer. Otherwise, fire hazard arises.

- Do not dry textile products that contain predominantly foam, rubber or rubber-like parts (e.g. shower caps, waterproof textile products, rubber products and clothes) or the ones that are filled and damaged (e.g. Pillows or coats). There is a risk of burns.
- If you use a laundry ball, detergent scale, laundry cage or ball in your machine, these products may melt during drying. If you are going to choose the drying feature, do not use these products. Otherwise, fire hazard arises.
- If you use industrial chemicals for cleaning, do not use the drying function. Otherwise, fire hazard arises.
- The door becomes very hot after drying process. After drying is over, open the door of the device completely. Do not touch the metal door located inside of the door glass. There is a risk of burns due to high temperatures.
- During Drying programmes, a cooling step is performed as the last step to ensure that the laundry remains at a temperature where it will not be damaged. You may be exposed to hot steam if you open the cover without completing the cooling step. Risk of seething.
- If the drying programmes are interrupted (as a result of programme cancellation or power failure), the laundry in the machine may be hot. Be careful.
- Do not stop the machine before drying programme is completed. If you have to stop the machine, take out all the laundry inside of it and place them in a suitable place and wait for them to cool.
- Avoid interrupting the drying program by stopping your tumble dryer prematurely, as the laundry inside the machine may become excessively hot in the event of program cancellation or a power failure. Risk of burns! If you have to stop the machine, take out the laundry and lay them somewhere to cool down.
- Your product is suitable to operate between the temperatures of 5°C and +35°C.
- Ambient temperatures between 15°C and +25°C are ideal for your product.
- Do not overload the machine for drying. Observe the specified maximum load levels for drying.

- If the laundry has been washed with a stain remover, run an additional rinsing speed before starting the drying speed.
- Do not dry leather laundry and laundry containing leather (such as leather tags on jeans) in the machine. The colour left by the leather parts may smear on other textiles.
- If there is a problem that you cannot solve using the information given in the safety instructions section, turn off and unplug the machine and call an Authorized Service.
- In your washer-dryer, you can only wash laundry, only dry laundry or do both of these processes. The machine should not be used for a long period of time only for drying wet laundry. While the machine is only used for drying, it should be run empty in a short washing programme every 15 starts.
- Before putting laundry in the machine, check all of them and make sure that there is no object such as lighter, coin, metal object and pin, etc. in their pockets or inside of them.
- Lingerie that has metal parts should not be dried in the machine. Metal parts may come off during drying and cause damage to the machine. Put them in a bag or pillowcase.
- Do not dry large laundry such as tulle curtains, curtains, sheets/beddings, blankets, rugs in the machine. Laundry may get damaged.
- Do not dry unwashed laundry in the machine.
- Do not use softener or anti-static agent unless recommended by the manufacturer.
- Products such as softener should be used in accordance with the manufacturer's instructions.
- Do not dry silk, wool and similar delicate clothes in the machine. Otherwise, wool clothes can shrink, and damage may be caused in other delicate clothes.
- Check the symbols on laundry label before washing and drying processes.
- The machine automatically cleans the lint itself that comes out of the laundry during drying. The machine performs automatic water intakes for cleaning. For this reason, the water tap of the machine should also be open during drying programmes.

- Prevent the lint from accumulating around the product.
- Remove all objects such as matches and lighters from your pockets.



1.8 Maintenance and Cleaning Safety

- Before cleaning or servicing the washing machine, unplug it or cut the power at the fuse.
- If you need to move the product for cleaning, do not pull on the cover. The cover can break and cause injury!
- Do not put hands, feet and metal objects under or behind your product. This can cause jams, and any sharp edge can cause personal injury.
- Use a clean, dry cloth to wipe foreign material or dust from the plug ends. When cleaning the plug, do not use a wet or damp cloth. Otherwise, there is a risk of fire or electric shock.
- Do not wash the product with pressure washers, by spraying vapour, water or pouring water. There is a risk of electrocution.
- Do not use sharp or abrasive tools to clean the product. Do not use household cleaners, soap, detergent, gas, gasoline, thinner, alcohol, varnish, etc. while cleaning.
- Cleaning agents containing solvents might reek poisonous fumes (for ex. cleaning solvent. Do not use cleaning products containing solvents.
- There may be detergent residues in the detergent drawer when you open it for cleaning.
- Do not dismantle the filter of the discharge pump while the product is running.
- The temperature in the machine may rise up to 90°C. Clean the filter after the water in the machine cools down in order to avoid risk of getting burnt.

2 Important Instructions for Environment

2.1 Compliance with WEEE Directive



This product complies with EU WEEE Directive (2012/19/EU). This product bears a classification symbol for waste electrical and electronic equipment (WEEE).

This product has been manufactured with high quality parts and materials which can be reused and are suitable for recycling. Do not dispose of the waste product with normal domestic and other wastes at the end of its service life. Take it to the collection center for the recycling of electrical and electronic equipment. Please consult your local authorities to learn about these collection centers.

Compliance with RoHS Directive:

The product you have purchased complies with EU RoHS Directive (2011/65/EU). It does not contain harmful and prohibited materials specified in the Directive.

2.2 Package Information

Packaging materials of the product are manufactured from recyclable materials in accordance with our National Environment Regulations. Do not dispose of the packaging materials together with the domestic or other wastes. Take them to the packaging material collection points designated by the local authorities.

3 Technical Specifications

Manufacturer's name or commercial brand	Beko
Model name	B1D85364WBEE B1D85364WWEE
Rated washing capacity (cotton) (kg)	8
Rated drying capacity (cotton) (kg)	5
Maximum spin speed (cycle/min)	1400
Built-In	No
Height (cm)	85
Width (cm)	60
Depth (cm)	52
Single Water inlet / Double Water inlet	+ / -
Rated voltage / Rated frequency in hertz (V/Hz)	220-240V~/50Hz
Rated current (A)	10
Rated power (W)	2000
Main model code	



The model information as stored in the product database can be reached by entering following website and searching for your model identifier (*) found on energy label.

<https://eprel.ec.europa.eu/>

SUPPLIER'S NAME

A

MODEL IDENTIFIER → (*)

A

 The consumption values apply when wireless network connection is turned off.

Symbols Table

Prewash	Fast	Fast+	Extra Rinse	Extra Water	Anti Crease	Pet Hair Removal	Steam	Night Mode	Soaking	Rinse Hold	Steeping
AutoDose	Liquid Detergent Selection	Softener Selection	Rinse	Spin+Drain	Drain	Temperature	Spin	No Spin	Tap Water (Cold)	No Water	Time Delay
Door Lock	Child Lock	On/Off	Start / Pause	Soil Level	Add Garment	Downloaded Program	Wash	Ok (End)	Cancel	AntiCrease+	Drying
Extra Dry	Cupboard Dry	Iron Dry	Timed Drying	Clean& Wear	Intensive	Water Mode	SaveWater	Easy Start			

4 Installation



Please read the "Safety Instructions" section first!

- Please contact the nearest Authorised Service for the installation of the appliance.
- Make sure that the installation and electrical connections of the product are performed by authorised service agent. Manufacturer shall not be held responsible for damages caused by operations performed by unauthorised persons.
- Preparation of the location and electrical, tap water and wastewater installations at the place of installation is under customer's responsibility.
- Make sure that the water inlet and discharge hoses as well as the power cable are not folded, pinched or crushed while pushing the product into its place after installation or cleaning procedures.
- Prior to installation, visually check if the product has any defects on it. Do not have the product installed if it is damaged. Damaged products cause risks for your safety.

4.1 Appropriate Installation Location

- Place the product on a hard and level floor. Do not place it onto a carpet with high pile or other similar surfaces. Placing on an improper floor shall cause noise and vibration problems.
- Do not place the product on the power cable.
- Do not install the product at places where temperature may fall below 0 °C. Freezing might damage your product.
- Leave a minimum space of 1 cm between the product and the furniture.
- If you will install the product on a surface with steps, never place it close to the edge.
- Do not place the product on any platform.
- There shall not be any locked, sliding or hinged doors that may prevent the loading door from opening completely in the installation location of this product.
- Do not place heat sources such as cooker, irons, ovens, heater etc. on the appliance and do not use them on the product.

4.2 Removing Transportation Safety Bolts

1. Loosen all transportation safety bolts with an appropriate wrench until they turn freely.
2. Bend the inner part by pressing it at the grip areas and pull the part out.
3. Attach the plastic covers supplied in the User Manual bag into the holes on the rear panel.

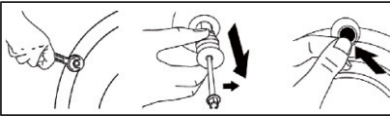

WARNING

Remove the transportation safety bolts before operating the product. Otherwise, the product will get damaged.



WARNING

Keep the transportation safety bolts in a safe place to reuse when the product needs to be moved again in the future. Install the transportation safety bolts in reverse order of the disassembly procedure. Never move the product without the transportation safety bolts properly fixed in place.

4.3 Connecting to Water Supply



WARNING

The water pressure required for the operation of the product is between 1-10 bars (0.1-1 MPa). To ensure a smooth operation of the machine, 10 - 80 liters of water shall be supplied in a minute from a fully opened tap. If the water pressure is higher, install a pressure reducing valve.



WARNING

Models with a single water inlet shall not be connected to the hot water tap. In such a case the laundry will get damaged, or the product will switch to protection mode and will not operate. Do not use old or used water inlet hoses on a new product. It may cause water leakage from your machine and stain your laundry.

1. Connect the special hose supplied with the product to the water inlet on the product.



WARNING

Make sure that the cold-water connection is performed correctly during the installation of the product. Otherwise, your laundry may come out as hot at the end of the washing cycle and thus they may be worn.

2. Tighten all hose nuts by hand. Never use a tool when tightening the nuts.
3. Open the taps completely after making the hose connection to check for water leaks at the connection points. If any leak occurs, turn off the tap and remove the nut. Check the gasket and tighten the nut carefully again. In order to prevent the water leaks and resultant damages, keep the taps closed when you do not use the product.

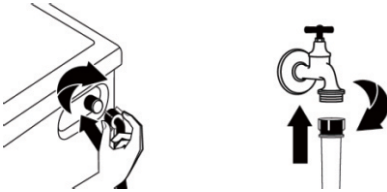

4.4 Connecting the Drain Hose to the Drain

1. Connect one end of the water inlet hose to a cold water tap and tighten by hand (see figure). Before performing the connection, allow the water to run freely until it is perfectly clear.

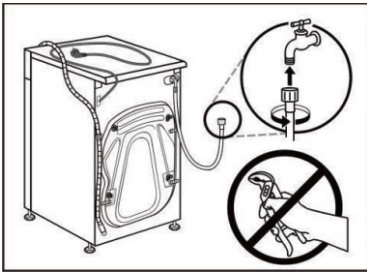

2. Connect the other end of the water inlet hose to the water inlet valve on the rear of the appliance and tighten by hand.

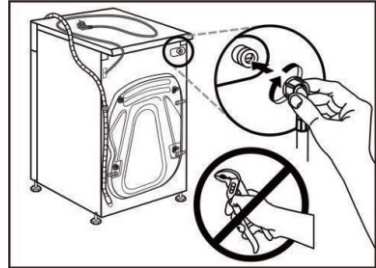

3. Turn on the tap slowly and make sure there are no leaks. Do not twist, squash, modify or cut the hose. Tighten the end of the hose firmly by hand.

The supply water pressure must be in 0.03-1 MPa range. If the water pressure exceeds this value, please fit a pressure reducing valve.

If the hose is not long enough, contact a specialized shop or an authorized technician.

Never use a second-hand water inlet hose. Use the new water inlet hose supplied with the appliance.

4. Height difference between the floor and drainage point should be minimum 60cm (24 in.) and maximum 100 cm (39 in.)

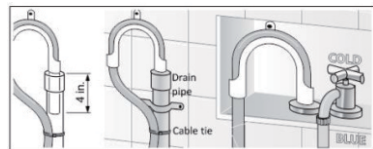
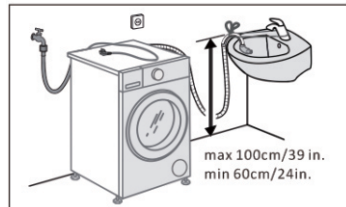

5. Attach the drain hose to the elbow (not provided with the appliance). Position the elbow on the drain hose 4 in (100mm) from the end of the hose into the drainpipe, if the hose is pushed down too far, this may cause the washer to self-syphon i.e. continuously empty as it is filling. Secure the elbow and hose with a cable tie to keep the hose from coming out of the drainpipe during use.

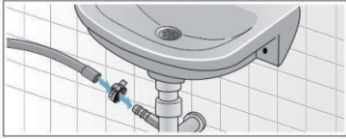

Secure the drain hose to the sink siphon using a 0.9-1.6 in (20-44mm) hose clip (available from a hardware store).



WARNING

When washing at high temperatures, there is a risk of scalding if you touch hot suds, e.g. when pumping out hot suds into a wash basin. Do not reach into the hot suds.



WARNING

If the end of the drain hose touches the discharged water (water drained from washer), it (the discharged water) can be sucked back into the washer and may damage the appliance or textiles.

6. Make sure that;
- There is no stopper in the sink drain.
 - The end of the drain hose does touch the discharge water.
 - The sink drain is free flowing and not partially clogged.
 - Attach the drain hose securely to the wash basin.

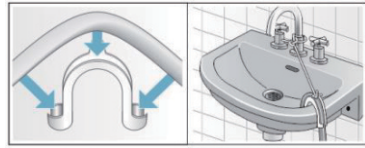

7. Do not twist, pull out or bend the drain hose. Secure the drain hose with the cable tie to the drainpipe, wash basin, etc. So, the hose does not pull out from the force of the water. It is advised against the use of drain hose extensions; in case of absolute need, the extension must have the same diameter as the original hose and must not exceed 250cm in length.

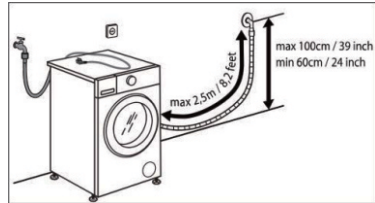

4.5 Adjusting the Stands



WARNING

In order to ensure that the product operates more silently and vibration-free, it must stand level and balanced on its feet. Ensure that the product is balanced by adjusting the feet. Otherwise, the product may move from its place and cause crushing, noise and vibration problems.

1. Loosen the nuts on the feet in the direction of the arrow with the tool in the user manual bag.
2. Adjust the feet until the product stands level and balanced. You can move the feet up by turning them counterclockwise and down by turning them clockwise.
3. Re-tighten all lock nuts with the tool in the direction of the arrow. You can move the nuts down by turning them clockwise.

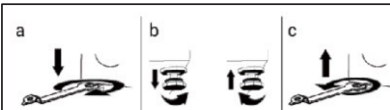

4.6 Electrical Connection

Connect the product to a grounded outlet protected by a 10 A fuse. Our company shall not be responsible for the damages that shall be incurred due to using the product without grounding according to local regulations.

- Connection must comply with national regulations.
- The electrical connection cable infrastructure of the product must be adequate and suitable for product requirements. It is recommended to use a Ground Fault Circuit Breaker (GFCI).
- Power cable plug must be within easy reach after installation.
- If the current supply to the fuse or breaker in the house is less than 10 Amps, have a qualified electrician install

a 10-amp supply.

- The voltage specified in the "Technical specifications" section must be equal to your mains voltage.
- Do not make connections via extension cables or multi-plugs. Overheating and burning may occur due to the connecting cable.



Damaged power cables should be replaced by the authorized service in order to prevent possible danger.

Important

Fitting a different plug:

As the colours of the wires in the mains lead of this appliance may not correspond with the coloured markings identifying the terminals on your plug, proceed as follows:

1. Connect the green - yellow or green (earth) wire to the terminal in the plug marked 'E' or with the symbol \perp or coloured green and yellow or green.
2. Connect the blue (neutral) wire to the terminal in the plug marked 'N' or coloured black.
3. Connect the brown (live) wire to the terminal in the plug marked 'L' or coloured red.

With the alternative plugs a 10 A fuse must be fitted either in the plug or adaptor or in the main fuse box. If in doubt, contact a qualified electrician.

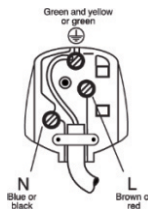

4.7 Handling the Product

1. Unplug the product before handling it.
2. Disconnect the water outlet and water main connections.
3. Drain all the water that remains in the product. See Draining Remaining Water and Cleaning the Pump Filter.

4. Install the shipping bolts in reverse order of the disassembly procedure. See Removing the Shipping Bolts



Never carry the product without the shipping bolts properly attached! Your product is so heavy that it shall not be carried by one person. Your product shall be carried by two people and more care shall be taken on the stairs as it is a heavy product. If the product falls on you, it may cause injury. The packaging materials are dangerous for children. Keep packaging materials at a safe place away from the reach of

5 Preliminary Preparation



Please read the "Safety Instructions" section first

5.1 Sorting the Laundry

- Sort laundry according to type of fabric, colour, and degree of soiling and allowable water temperature.
- Always observe the instructions given on the garment care labels.

5.2 Preparing Laundry for Washing

- Laundry items with metal attachments such as, underwiring, belt buckles or metal buttons will damage the product. Remove the metal pieces or wash such clothes by putting them in a laundry bag or pillowcase.
- Take out all substances in the pockets such as coins, pens and paper clips, and turn pockets inside out and brush. Such objects may damage the product or cause noise problem.
- Put small size clothes such as infant's socks and nylon stockings in a laundry bag or pillowcase.
- Place curtains in without compressing them. Remove curtain attachment items. Curtain attachment items may cause pulling and tearing on the curtain.
- Fasten zippers, sew loose buttons and mend rips and tears.
- Wash "Machine washable" or "Hand washable" labelled products only with an appropriate programme. Dry these types of clothes by hanging them or laying them flat. Do not dry them in the machine.
- Do not wash colours and whites together. New, dark coloured cottons release a lot of dye. Wash them separately.
- Only use paints / colour changing agents and descalers suitable for use in machines. Always observe the instructions on the packaging
- Tough stains must be treated properly before washing. If you are not sure, check with a dry cleaner.

- Wash trousers and delicate laundry turned inside out.
- Laundry that are subjected to materials such as flour, lime dust, milk powder, etc. intensely must be shaken off before placing into the product. Such dusts and powders on the laundry may build up on the inner parts of the product in time and can cause damage.
- Before washing laundry made of angora wool, keep them in the freezer section of the refrigerator for few hours. This will reduce pilling.

5.3 Tips for Energy and Water Saving

Following information will help you use the product in an ecological and energy/water-efficient manner.

- Observe the temperature instructions on the detergent packaging.
- Wash slightly soiled laundry at low temperatures.
- Use faster programmes for small quantities of lightly soiled laundry.
- Do not use prewash and high temperatures for laundry that is not heavily soiled or stained.
- If you plan to dry your laundry in a dryer, select the highest spin speed recommended during washing process.
- Do not use more detergent than the recommended on the detergent packaging.

5.4 Start Up

Before starting to use the product make sure that the preparations described in section "Environmental Instructions" and "Installation". To prepare the product for washing laundry, perform first operation in Drum Cleaning programme. If this programme is not available in your product, apply the method which is described in section "Cleaning the loading door and the drum".



Use an anti-limescale product suitable for the washing machines. Some water has remained in the product due to the quality control processes in the production. It is not harmful for the product.

5.5 Loading the Laundry

1. Open the loading door.
2. Put the laundry items into the product in a loose manner.
3. Push the loading door to close until you hear a locking sound. Ensure that no items are caught in the door. The loading door is locked while a programme is running. The door lock will open a few minutes after the washing programme has ended. Then you can open the loading door. If the door does not open, apply the solutions provided for "Loading door cannot be opened" error in the Troubleshooting section.

5.6 Correct Load Capacity

The maximum load capacity depends on the type of laundry, the degree of soiling and the desired washing programme.

The product automatically adjusts the water amount according to the weight of the laundry put inside it.



When the appliance is overloaded product's washing performance will drop. Moreover, noise and vibration problems may occur. For a successful drying performance, do not put more laundry in the machine than specified.

Bathrobe: 4000g
Bedding: 3000g
Sheet: 3000g
Pillowcase: 3000g
Tablecloth: 3000g
Blouse: 7000g
Towel: 4000g



The loading door is locked while a programme is running. The door lock will open once the programme is completed. If the inner part of the machine is very hot at the end of the program, the loading door will not open until the temperature drops. If the door does not open, apply the solutions provided for "Loading Door Cannot Be Opened" error in the Troubleshooting section.



WARNING

If the laundry is placed incorrectly, noise and vibration problems may occur in the machine.

5.7 Using Detergent and Softener



WARNING

Read the manufacturer instructions on the package while using detergents, softeners, starch and bleach, anti-limescale and follow the dosage information provided. Use a measuring cup, if any.

The detergent drawer comprises of three compartments:

- (1) Liquid washing detergent

The liquid detergent must not exceed the "MAX" level.

- (2) Additives (Softener. etc.)

The fabric softener must not exceed the "MAX" level.

- (3) Powder washing detergent

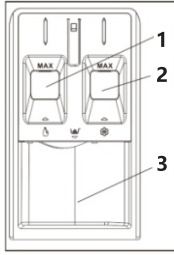

Detergent, Softener and Other Cleaning Agents

- Add detergent and softener before starting the washing programme.
- Do not leave the detergent drawer open when the washing programme is on.
- If you are using a liquid detergent, follow the directions under "Liquid detergent use" and do not forget to bring the liquid detergent apparatus to the correct position.
- Do not add washing chemicals (Liquid detergent, Softener, etc.) while the machine is during Drying step.

Choosing the Detergent type

Detergent type to be used depends on the washing programme, fabric type and colour.

- Use different detergents for coloured and white laundry.
- Wash your delicate clothes only with special detergents (liquid detergent, wool shampoo, etc.) intended solely for delicate clothes and at suggested programmes.
- When washing dark coloured clothes and quilts, it is recommended to use liquid detergent.
- Wash woollens at suggested programme with special detergent made specifically for woollens.
- Please review the "programme descriptions" part for suggested programme for different textiles.
- All recommendations about detergents are valid for selectable temperature range of programmes.



Only detergents, softeners and additives suitable for washing machines should be used.
Do not use soap powder.

Adjusting the Detergent Amount

The amount of detergent depends on the amount of laundry, how soiled they are and the water hardness.

- Do not exceed the recommended dosage values on the detergent packaging in order to eliminate excessive foam and poor rinsing problems, to save money and protect the environment.
- Use less amounts of detergent for fewer or less soiled laundry.

Using Softeners

Put the softener in the softener compartment of the detergent drawer.

- Do not exceed the (>max<) level sign in the softener compartment.
- If the softener is not fluid, dilute with water before placing in the softener compartment.



WARNING

Do not use liquid detergents or other materials with cleaning properties unless they are intended for use in washing machines for softening the laundry.

Use of Gel and Tablet Detergents

- If the detergent is fluid and there is no liquid detergent compartment in your product, place the gel detergent in the main washing detergent compartment in first water intake. If your product has a liquid detergent compartment, fill the compartment with detergent before starting the programme.
- If the gel detergent is not fluid or is in a capsule liquid tablet, place directly inside the drum before washing.
- Put the tablet detergent in the main washing compartment (compartment no. "2") or directly inside the drum before washing.
- Tablet detergents may leave residue in the detergent compartment. If you face such residues, place the tablet detergent among the laundry in the next washes in a way that it will be at the bottom side of the drum.
- Use tablet or gel detergent without selecting the pre-wash function.
- Do not forget to remove elements such as plastic detergent compartment from the drum before drying.

Using Starch

- Put in the liquid starch, powder starch or fabric dye in the softener compartment.
- Do not use softener and starch in the same washing programme simultaneously.

- Wipe the inside of the product with a damp and clean cloth after using starch.

Using Anti-Limescale

- When necessary, only use anti-limescale produced for washing machines.

Using Bleach and Decolourants

- Select a programme with pre-washing and add bleach at the start of pre-washing. Do not put detergent in the pre-wash compartment. As an alternative application, select a programme with additional rinsing and add the bleach while the product is receiving water to the detergent compartment in the first rinsing step.
- Do not mix and use bleach and detergent together.
- As bleach may cause skin irritation use only small amounts (1/2 teacups - approximately 50 ml and rinse the laundry well).
- Do not pour bleach directly onto the laundry.
- Do not use bleach for coloured clothes.
- Select a programme with low temperature washing while using oxygen-based decolourants.
- Oxygen-based decolourants can be used together with detergents. However, if it does not have the same viscosity as the detergent, first place the detergent in compartment no. "2" in the detergent drawer and wait for the product to rinse away the detergent during water intake. Add the decolourant to the same compartment while the machine continues taking in water.

5.8 Tips for Efficient Washing

		Clothes			
		Light Colours and Whites	Colours	Black/Dark Colours	Delicates/Woolens/Silks
		(Recommended temperature range based on soil level: 40-90 °C)	(Recommended temperature range based on soil level: cool -40 °C)	(Recommended temperature range based on soil level: cool -40 °C)	(Recommended temperature range based on soil level: cool -30°C)
Soiling Level	Heavily Soiled (difficult stains such as grass, coffee, fruits and blood.)	It may be necessary to pre-treat the stains or perform prewash. Powder and liquid detergents recommended for whites can be used at dosages recommended for heavily soiled clothes. It is recommended to use powder detergents to clean clay and soil stains and the stains that are sensitive to bleaches.	Powder and liquid detergents recommended for colours can be used at dosages recommended for heavily soiled clothes. It is recommended to use powder detergents to clean clay and soil stains and the stains that are sensitive to bleaches. Detergents which do not contain de-colourant should be used.	Liquid detergents suitable for colours and black/dark colours can be used at doses recommended for heavily soiled clothes.	Prefer liquid detergents produced for delicate clothes. Woolen and silk clothes must be washed with special woolen detergents.
	Normally Soiled (For example, stains caused by body on collars and cuffs)	Powder and liquid detergents recommended for whites can be used at dosages recommended for normally soiled clothes.	Powder and liquid detergents recommended for colours can be used at dosages recommended for normally soiled clothes. Detergents which do not contain de-colourant should be used.	Liquid detergents suitable for colours and black/dark colours can be used at doses recommended for moderately soiled clothes.	Prefer liquid detergents produced for delicate clothes. Woolen and silk clothes must be washed with special woolen detergents.
	Lightly Soiled (No visible stains exist.)	Powder and liquid detergents recommended for whites can be used at dosages recommended for lightly soiled clothes.	Powder and liquid detergents recommended for colours can be used at dosages recommended for lightly soiled clothes. Detergents which do not contain de-colourant should be used.	Liquid detergents suitable for colours and black/dark colours can be used at doses recommended for lightly soiled clothes.	Prefer liquid detergents produced for delicate clothes. Woolen and silk clothes must be washed with special woolen detergents.

5.9 Tips for Efficient Drying

		Programmes				
		Cotton Dry	Synthetic Dry	Babyprotect+	Washing and Drying	Wash & Wear
Types of Clothing	Durable Clothes Containing Cotton	Sheets, beddings, baby clothes, t-shirts, sweat-shirts, durable knitted clothes, jeans, canvas pants, shirts, cotton socks etc.	Not Recommended!	It washes and dries consecutively! Sheets, beddings, baby clothes, t-shirts, sweat-shirts, durable knitted clothes, jeans, canvas pants, shirts, cotton socks etc.	It washes and dries consecutively! Sheets, beddings, baby clothes, t-shirts, sweat-shirts, durable knitted clothes, jeans, canvas pants, shirts, cotton socks etc.	Clothes such as shirts, t-shirts, sweat-shirts etc. that have been worn for a short time and are unstained. A very small amount of laundry should be loaded.
	Synthetic Clothes (Polyester, nylon etc.)	Not Recommended!	It is recommended for clothes containing polyester, nylon, polyacetate, acrylic. Drying is not recommended for clothes containing viscose. Attention should be paid to the drying instructions on the maintenance label.	It is recommended for clothes containing polyester, nylon, polyacetate and acrylic at low temperatures, taking into account the washing and drying warnings indicated on the maintenance label.	It is recommended for clothes containing polyester, nylon, polyacetate and acrylic at low temperatures, taking into account the washing and drying warnings indicated on the maintenance label.	Lightly soiled and unstained shirts, t-shirts and synthetic laundry. A very small amount of laundry should be loaded.
	Delicate (Containing Silk, Woolen, Cashmere, Angora wool etc.) Laundry	Not Recommended!	Not Recommended!	Not Recommended!	Not Recommended!	Not Recommended!
	Bulky laundry such as blankets, coats, curtains etc.	Not Recommended! It is not suitable to dry bulky laundry in the washing machine. Dry this laundry by hanging them or laying them flat.	Not Recommended! It is not suitable to dry bulky laundry in the washing machine. Dry this laundry by hanging them or laying them flat.	Not Recommended! It is not suitable to dry bulky laundry in the washing machine. Dry this laundry by hanging them or laying them flat.	Not Recommended! It is not suitable to dry bulky laundry in the washing machine. Dry this laundry by hanging them or laying them flat.	Not Recommended! It is not suitable to dry bulky laundry in the washing machine. Dry this laundry by hanging them or laying them flat.

5.10 Displayed Programme Duration

You can view the programme duration on the display of your machine while selecting a programme. Depending on the amount of laundry you have loaded into your machine, foaming, unbalanced load conditions, fluctuations in power supply, water pressure and programme settings, the programme duration is automatically adjusted while the programme is running.

SPECIAL CASE: At programme start of Cottons and Cotton Eco programmes, display shows the duration of half load. It is the most common use case. After programme starts, in 20-25 minutes actual load is detected by the machine. And if the detected load is higher than half load; washing programme will be adjusted accordingly and programme duration increased automatically. You can follow this change on the display.

6 Operating the Product



Please read the "Safety Instructions" section first!

6.1 Control Panel

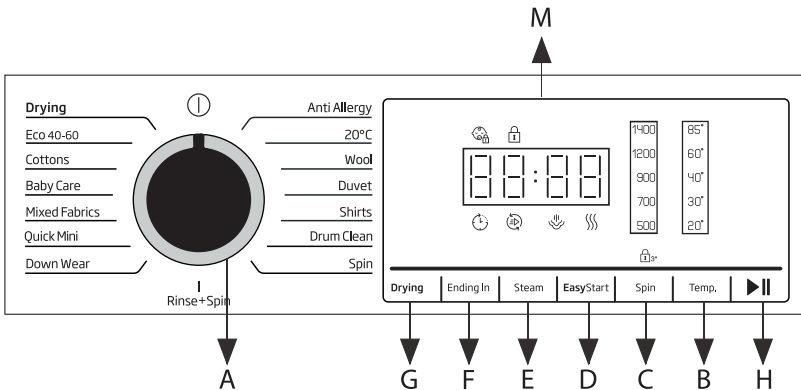

- A- Wash Cycle Selector Knob:** Used to set the desired wash cycle.
OFF Position: Turn the Linear mark on the wash cycle selector knob under the symbol "⓪" to turn off the machine. If the machine is turned off during a wash cycle, this wash cycle will be cancelled.
- B- Temp Button:** Press to change the water temperature for the current cycle.

There are five temperature values on the display when a temperature value is selected, the corresponding temperature value indicator light will be lit on the display.

- C- Spin Button:** This cycle uses a spin to shorten drying times for heavy fabrics or special-care items washed by hand.
- D- EasyStart Button:** Press to set the EasyStart wash cycle. For a detailed description, see various cycles and functions.

- E- Steam Button:** Press to set the steam wash cycle. For a detailed description, see "various cycles and functions".
- F- Ending In Button:** Press to set the program end (Delay end) time. For a detailed description, see "various cycles and functions".
- G- Drying Button:** Press to set the drying type or drying as needed. Drying type or drying time appears on digital display. Some programs do not have a drying function.

For a detailed description, see "various cycles and functions".

6.2 Symbols on the Display

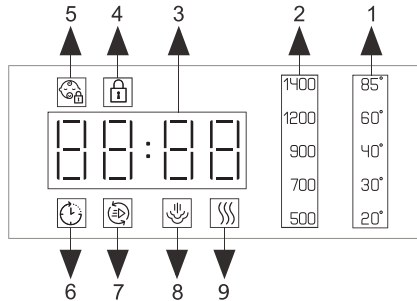

1- Temperature Indicator

When a program is selected, the default temperature value indicator light of this program will be lit on the display. You can change the temperature value by pressing the TEMP. button. There are five temperature value indicator lights on the display. When a temperature value is selected, the corresponding temperature value indicator light will be lit on the display. If all temperature value indicator lights are off, it indicates the appliance is using only cold water without utilizing the heater in this program.

2- Spin Speed Indicator

When a program is selected, the default spinning speed value indicator light for this program will be lit on the display. You can change the spinning speed value by pressing the SPEED button. There are five spinning speed value indicator lights on the display. When a spinning speed value is selected, the corresponding indicator light will be lit on the display. If all spinning speed indicator lights are off, it indicates that the appliance does not spin after the final drain process in this program.

3- Duration Indicator

When a program is selected, the remaining time of the wash cycle will be displayed on the panel.

Remaining time of the wash cycle:

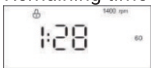

Delay end time:

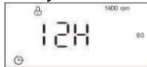

Drying time:

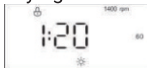

Rinse count:



Fault code



4- Door Lock Indicator

The lit indicator light indicates that the door is locked. To prevent any damage, wait until the indicator light turns off before opening the door. To open the door while a cycle is in progress, press the START/PAUSE button. If the DOOR LOCK indicator light is off, the door may be opened.

5- Child Lock Indicator

The lit indicator light indicates that the CHILD LOCK function is activated, and the control panel is locked.

6- Delayed End Indicator

The lit indicator light indicates that the DELAY END function is activated. The countdown to the end of the selected wash cycle will appear on the digital display.

7- EasyStart Function Indicator

The lit indicator light indicates that the EASYSTART wash program is selected.

8- Steam Indicator

When the indicator light is lit, it means that the steam function has been set.



9- Drying Function Indicator

When the indicator light is lit, it means that the drying function has been set or is carrying out the drying cycle.

6.3 Preparing the Laundry

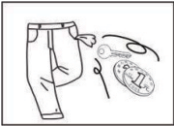
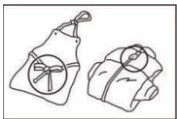
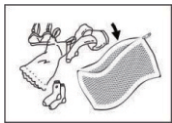

Damage to the appliance/fabric: Foreign objects (e.g. coins, paper clips, needles, nails) may damage the laundry or components in the appliance. Therefore, follow these tips when preparing your laundry:

- Remove any loose items or metal objects, such as safety pins, paper clips, etc. from the laundry. 
- Brush sand, coins, etc. out of pocket and cuffs.
- Close zips and button up cushion covers, duvet covers, etc. 
- Remove curtain runners or secure them in a net bag.
- Particularly delicate items: such as tights or lace curtains, or smaller items, such as tiny socks or handkerchiefs, should only be washed in a net bag or pillowcase. 
- Some items are best turned inside out. These included knitwear, trousers, T-shirts and sweatshirts. 

- Make sure that the wire-cup bras are machine washable.



Make sure that wire-cup bras are placed in a pillowcase that can be securely closed with a zipper or button. If the wire comes out of the cup, it may fall through the holes in the drum and cause extensive damage.

6.4 Preparing the Laundry for Drying

- Only tumble-dry textiles that have been washed, rinsed, and spun.
- Remove as much water as possible from the laundry. Do not press the SPEED button to reduce the spin speed.
- To ensure uniform drying, sort the items according to fabric type and the degree of drying required.
- Items that require ironing do not need to be ironed immediately after being tumble-dried. It is a good idea to fold or roll them together for a while, so that any remaining moisture is evenly distributed.
- When washing laundry to be tumble-dried, use the correct amount of detergent and textile care products as specified in the manufacturer's instructions.



The following textiles should not be tumble-dried: laundry marked with the care symbol:

"Do not tumble-dry." 

- Woolens or items containing wool: Risk of shrinking!
- Delicate fabrics (silk, synthetic net curtains): Risk of creasing!
- Items containing foam rubber or similar materials.
- Items treated with flammable solvents, such as stain removers, petrol, or paint thinners: Explosion hazard!
- Items still containing hair lacquer or similar substances: Dangerous vapours!
- Dripping-wet laundry: Waste of energy!

Use the following main programmes depending on the type of fabric. After selecting the appropriate washing program, by pressing the Drying button before starting the program, you can set your machine to switch to the drying step (automatically or scheduled) at the end of the washing program, without any pauses/interruptions. Each time you press the button, the step in which the drying process will take place is shown in the row of information and the related symbol lights up. You can see when the programme will finish on the display of the machine, according to the drying selections you will add to the washing programmes. If you want, by keeping pressing the button you can dry for the maximum time allowed. You can take a glance at the programmes for which you can select the drying function in the Programme and Consumption tables.

6.5 Sort the Laundry According to Colour and Degree of Soiling

Sort laundry items according to colour, degree of soiling, and recommended wash temperature range.

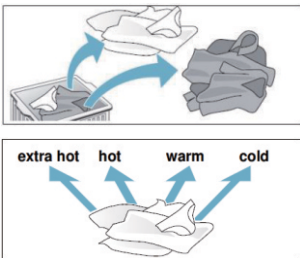

- Items of clothing can become discoloured.
- Never wash new multi-coloured items together with other items.
- Wash white items separately from coloured items; otherwise, white items may tend to become grey.

6.6 Degree of Soiling

- Light soiling:
No visible soiling or stains but may have

absorbed some odour. This could include lightweight summer clothes such as T-shirts, shirts, or blouses worn only once. Also suitable for freshening bed linen or guest towels.

- Normal soiling:
Visible soiling and/or a few light stains. This could include clothing such as T-shirts, shirts, or blouses that have been sweated in or worn several times. Also includes tea towels, hand towels, or bed linen used for up to one week or more, and curtains without stains that have not been washed for up to half a year.
- Heavy soiling:
Visible soiling and stains. This could include kitchen towels, fabric napkins, baby bibs, children's outer clothing, or football jerseys and shirts stained with grass or dirt. It may also include work clothes such as overalls, jeans, and other clothing worn for outdoor work and activities.

6.7 Sorting the Laundry According to Care Label Specifications

The symbols on the labels of your garments will help you choose the suitable wash program, the right temperature, wash cycles, and ironing methods. Don't forget to take a glance at these useful indications!

 Wash type	 Machine wash, normal/cotton	 Machine wash, permanent press	 Machine wash, delicate/gentle	 Hand wash only	 Do not wash	 Do not wring
 Water Temp.	 Water temperature 30 °C	 Water temperature 40 °C	 Water temperature 50 °C	 Water temperature 60 °C	 Water temperature 70 °C	 Water temperature 95 °C
 Bleach	 Any bleach	 Non chlorine bleach	 Chlorine bleach	 Do not bleach		
 Tumble Dry type	 Normal/Cotton Heavy duty	 Permanent Press/Wrinkle resistant	 Delicate/Gentle	 Do not tumble dry		
 Tumble dry temp.	 High heat	 Medium heat	 Low heat	 No heat		
 Dry type	 Hang to dry	 Drip dry	 Dry flat	 Dry in the shade		
 Iron	 High heat	 Medium heat	 Low heat	 Do not Iron		
 Dryclean	 Any solvent	 Perchloroethylene solvent	 Petroleum solvent	 Do not dryclean		

6.8 Table of Wash Cycle

- L= Gel/Liquid Detergent P=Powder Detergent O=Optional --- =No
- If using liquid detergent, it is not recommended to activate the time delay.
- We recommend using:
 - Laundry powder: 20°C to 80°C
 - Wool detergent: 20°C to 40°C
- Please follow the dosage recommendation on the powder or liquid detergent package.

Wash Cycle	Temp. °C (Max)	Max Load (kg) Washing	Max Load (kg) Drying	Specification	Kind of Detergent		
					Detergents		Softener
					Universal	Special	
EasyStart	40	5	---	Suitable for daily wear of clothing washing	L/P	---	O
Drying	---	---	5	For drying wet cotton fabric	---	---	---
Eco 40-60	40	8	5	Energy efficiency test program	L/P	---	O
Cottons	60	8	5	Suitable for cotton and linen clothing	L/P	---	O
Baby Care	85	5	5	Suitable for washing children's clothes	L/P	---	O
Mixed Fabrics	60	8	5	Suitable for mixed washing of cotton, linen and chemical fibre fabrics	L/P	---	O
Quick Mini	40	1	1	Suitable for quick washing of a small amount of clothes with slight stains or new clothes.	L/P	---	O
Down Wear	40	2	2	Suitable for washing machine washable down clothing.	L/P	---	O

Wash Cycle	Temp. °C (Max)	Max Load (kg) Washing	Max Load (kg) Drying	Specification	Kind of Detergent		
					Detergents		Softener
					Universal	Special	
Anti-allergy	85	3	3	Suitable for clothes that need to be de-mite and de-allergenised.	L/P	---	0
20°C	30	2	---	Suitable for small amounts of clothes that fade easily	L/P	---	0
Wool	40	1	---	Suitable for machine washable wool clothing	---	L	0
Duvet	60	6	3	Suitable for washing multi-piece bedding items or single size duvet	---	L	0
Shirts	60	3	---	Suitable for machine washable shirts	L/P	L	0
Drum Clean	85	---	---	Use only for cleaning inside the cylinder, do not place washing material	---	---	---
Spin	---	8	5	For clothing that only needs to be dehydrated	---	---	---
Rinse + Spin	---	8	5	For rinsing only dehydrated clothing	---	---	0

6.9 Various Cycles

EasyStart

The EasyStart wash cycle can intelligently detect the weight of the laundry and adjust the washing time and temperature accordingly for optimal washing. "RUE" is displayed during the detection stage after the cycle is started. The EasyStart wash cycle can be entered by the following three methods.

- When the appliance is OFF, press and hold the EasyStart button for at least 3 seconds. The appliance will run the EasyStart wash cycle directly, with the EasyStart indicator light lit.
- When the appliance is ON, press and hold the EasyStart button for at least 3 seconds. The appliance will run the EasyStart wash cycle directly, with the EasyStart indicator light lit.
- When the appliance is ON, short press the EasyStart button. The EasyStart indicator light will be lit, and then press the button. The appliance will run the EasyStart wash cycle.

Drying Program

1- To set the program of "Washing + Drying":

Only part of the washing program can add drying function.

First, load the laundry into the drum, close the door,

turn the wash cycle selector knob to select the desired wash program (except for the Drying program), and press the Dry button to select the two drying modes as follows:

- Automatic drying: press the Drying button continuously to adjust the drying time that is displayed on the panel, and when "RUE" is displayed, the automatic drying mode is activated. The drying time can be automatically adjusted according to the amount and humidity of clothes.
- Timed drying: press the Dry button to set the drying time. Press the Drying button, and the digital display screen will display the timed drying time (30 - 60 - 90 - 120 - 150 - 180 - 210 - 240). Select the

appropriate timed drying time and enter the timed drying mode. Then, press the start/pause button. The machine starts running the Washing + Drying program, with the drying program activated.

2- To set the Drying only program:

The Drying only program is suitable for drying cotton clothes. Do not dry clothes that are prone to deformation or shrinkage. When the Drying only program is set, it is recommended to run a single spin cycle for the clothes to be dried before starting the drying process.

- First, load the laundry into the drum, close the door, turn the wash cycle selector knob to select the Drying program only, and then press the Drying button continuously to select either the Auto drying or Timed drying mode (as described above).
- Then, press the START/PAUSE button to start the Drying only program.

3- To set the down jacket drying program:

The "Washing + Drying" program should be used to dry down jackets. Please select the "Down Jacket" program + "Automatic Drying (RUE)" mode.

Please do not choose the "Drying only" mode for down jacket drying.

For better drying results, it is recommended to dry one down jacket at a time.

Precautions for Drying Programme

- 1- If there is too much moisture in the clothes, the machine will automatically extend the drying time, and it is normal for "0:20" to be displayed for an extended period.
- 2- When the drying program is running, the faucet must be turned on, as water is required for cooling and dehumidification during the drying program.
- 3- The longest drying time is set according to different models.
- 4- To prevent wrinkles caused by excessive drying, set the drying time a little shorter at first, and then add more time based on the drying result.
- 5- Before running the Drying only program,

it is recommended to run a spinning cycle first.

- 6- If necessary, untie any knots in the clothes after spinning and then place them in the drum for drying.
- 7- For larger or thicker clothes, drying may be uneven in certain areas. Add drying time as needed after the initial drying cycle based on the drying effect.
- 8- Wool fabrics are not suitable for drying.
- 9- Do not dry clothes that are prone to deformation or shrinkage.
- 10- Some programs do not have a drying function.

Drying Channel Cleaning

After setting the wash cycle and options, before starting, long press this button for 3 seconds, and the machine will enter the "Drying Channel Cleaning" program. The digital display will show the running time of the "Drying Channel Cleaning" program (), and then the program will run after pressing the "Start/Pause" button. The Drying Channel Cleaning program can automatically remove the lint gathered in the drying channel and improve drying efficiency. This program is only used to remove lint from the drying channel. Do not add any clothes to the drum during this process.

Steam

A cycle designed for cotton clothes that are not prone to fading.

- Steam treatment can reduce wrinkles in clothes, bring them to an ideal humidity level, and achieve a more relaxed state, making ironing easier.
- Additionally, steam treatment can help eliminate unpleasant odors from clothes.

Special Wash Cycles

Baby Care: A cycle designed for dirt typical of children's garments, effectively removing any traces of residual detergent.

Down Jacket: A cycle for washing single down items (with a weight not exceeding 2.0 kg), such as cushions or clothes padded with goose down, like puff jackets. Use this

special wash cycle. We recommend placing the down items in the drum with their edges folded inward (see figure) and ensuring no more than 3/4 of the drum's total volume is used. For the best results, we recommend using a liquid detergent and placing it inside the detergent dispenser drawer.

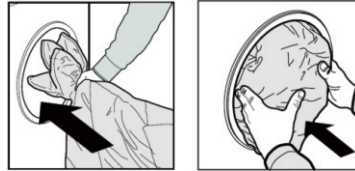

6.10 Various Functions

Ending In

Press the ENDING IN button to set the program end (ENDING IN) time in one-hour increments, up to a maximum of 24 hours. After selecting the desired washing program but before pressing the START/PAUSE button , press the ENDING IN button until the desired time is displayed, e.g., 8h, with the ENDING IN indicator light lit.

	NOTICE: The cycle duration is included in the set "Ending In" time.
---	---

Here is an example of a 1 hr 30 min cycle time and an 8 hr Ending In time: 8 hr is displayed, and the countdown (approximately 6 hr 30 min) begins until the washing cycle starts (at 1 hr 30 min). Then, the cycle duration of 1 hr 30 min is displayed and begins. The total time is approximately 8 hours.

The way to cancel the Delay End function: Turn the wash cycle selector knob to reset the wash cycle. The ENDING IN indicator light will go out.

Note: The ENDING IN function cannot be set for some wash cycles.

The actual end time of the wash cycle may differ from the set ENDING IN time depending on water supply pressure, drainage, clothing type, water temperature, and other conditions.

Child Lock

- Setting the child lock function can prevent children's mis-operation and external interference with the washing procedure.
- Press and hold the SPIN key for 3 seconds before or after starting the wash to set or cancel the child lock function.
- After the child lock function is set, the child lock indicator light is lit, the door cannot be opened, and the control panel is locked. All buttons on the control panel do not respond, and the wash cycle selector knob (except for the Linear mark under the symbol "Ⓢ") does not respond either. You can only turn off the machine by turning the wash cycle selector knob to the "Ⓢ" position, which will turn off the machine and stop the running cycle. If the machine is turned off, the child lock function will be cancelled.
- After the child lock function is set, you can turn off the machine by turning the wash cycle selector knob. When the machine is turned on again, it will automatically resume the program that was running before it was turned off.

Add clothes during the program running

When the program is running, long press the START/PAUSE button ▷|| to pause the machine. If the DOOR LOCK indicator light goes out, the door may be opened, allowing you to add or remove laundry. After completing the operation, close the door and long press the START/PAUSE button ▷|| again. The machine will then continue running from the point at which it was interrupted.



NOTICE:

If the water level or water temperature in the drum is too high, the DOOR LOCK indicator light  will remain lit, and the door cannot be opened. As a result, you cannot add or remove clothes while the program is running.

Cancelling the buzzer

Press and hold the SPIN button and EASYSTART button together for at least 3 seconds to turn off the buzzer that sounds during the washing cycle.

To activate the buzzer setting:

Perform the same operation as you did to cancel. The buzzer setting is activated after one beep.

Load Balancing System

The appliance has an automatic detection system for unbalanced loads. During the spinning process, if the clothes are unevenly distributed, the appliance will adjust the load until the clothes are evenly distributed before spinning. If the clothes cannot be evenly distributed within a specified time, the appliance will not spin to prevent severe vibration. In such cases, check if the clothes are knotted or entangled, and then select the "Spin" program after reorganizing the clothes. When washing fewer items, such as a pair of jeans, a sweater, or a bath towel, the machine may not complete the spinning process due to balance protection. To help the machine spin effectively, try washing larger and smaller items together to distribute the load more evenly and allow the spinning process to complete smoothly.



NOTICE:

Due to the different types and materials of the laundry, the automatic adjustment and balance system of the appliance may level and adjust the clothes multiple times, which can prolong the spinning time. This is a normal phenomenon and not a machine failure.

Downlight

- The downlight is always on during program or function setting.
- When the program is suspended, the downlight will illuminate by opening the machine door.
- When the program is running, the downlight will automatically light up according to the current washing stage.
- Touching any button other than the power button will also illuminate the downlight.

You can also change the temperature after the washing starts. You can also change the desired temperature after the washing programme starts. However, you need to do this before the heating phase starts.

6.11 How to Use the Appliance

Before loading your first load of laundry

Your new appliance was tested before leaving the factory. This process involved running various wash cycles, which may leave a small amount of water in the tub and drainage system. Before washing your first load of laundry, run a Drum Clean cycle with no laundry and no detergent to clean the system.

Preparing the laundry

Empty pockets

- Coins, paper clips, etc., can damage both the laundry and the washing machine components.
- Tissues will break down during the wash cycle, and the fragments will need to be removed by hand afterward.

Close all zippers, buttons, and hooks. Tie all ribbons or belts.

- Insert smaller garments (e.g., nylon hosiery, belts, etc.) and garments with hooks (e.g., bras) into a fabric bag or a pillowcase with a zipper. Remove any rings from curtains or place the curtains inside a fabric bag along with the rings.

Fabric type/symbol on the wash label

Cottons, Mixed Fibres, Easy Care/Synthetics, Wool, Hand Wash Items:

Select the appropriate cycle for these fabric types to ensure proper care.

Colour:

Separate coloured and white items. Wash new coloured articles separately to prevent colour bleeding.

Size:

Wash items of different sizes in the same load to improve washing efficiency and ensure better distribution of the clothes in the drum.

Delicates:

Wash delicate items separately, as they require gentle treatment to avoid damage.

How to use the appliance

1- Load laundry

Open the door and load the laundry. Place the items loosely, one at a time, without overfilling the drum. Refer to the "Table of Wash Cycles" for recommended load sizes. Overloading the machine may result in unsatisfactory washing results and creased laundry.

2- Close the door

Ensure no laundry is stuck between the door glass and the rubber seal. Close the door firmly until you hear it click shut.

3- Open the tap

Verify that the appliance is connected to the water supply, then open the tap.

4- Set the desired program

Use the WASH CYCLE SELECTOR knob to choose the desired program. The cycle duration will appear on the display. The washing machine automatically shows the default temperature and spin speed settings for the selected program.

- Change temperature (if needed): Press the TEMP. button to progressively lower the temperature until the cold wash is set (all temperature value indicator lights go out on the display). Pressing the button again sets the highest possible temperature.

- **Change spin speed (if needed):**

Press the SPEED button to progressively decrease the spinning speed until the spin cycle is turned off (all spinning speed value indicator lights go out on the display).

Pressing the button again sets the highest possible speed.

- **Select options (if needed):**

Press the option button(s) to enable specific options. The corresponding option indicator light will turn on. Press the button(s) again to cancel the option, and the corresponding indicator light will go out.



If the selected option is incompatible with the program set, the incompatibility will be signaled by a buzzer, and the corresponding option indicator light will flash.



If the selected option is incompatible with another previously set option, only the most recent selection will remain active.

5- Add detergent

Pull out the detergent dispenser (and additives/softener) compartments as described below.

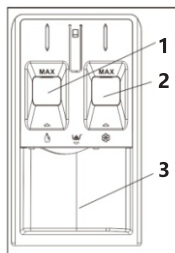

Compartment 1:

Liquid washing detergent

The liquid detergent must not exceed the "MAX" level.

Compartment 2:

Additives (softener etc.)

The fabric softener must not exceed the "MAX" level.

Compartment 3: Powder washing detergent

Follow the dosing recommendations on the detergent pack. Correct dosing of detergent/additives is important because:

- It optimizes the cleaning result.
- It avoids irritating residues of surplus detergent in your laundry.
- It saves money by preventing waste of surplus detergent.
- It protects the washer by preventing calcification of components.
- It respects the environment by avoiding unnecessary environmental burden.



Do not use hand washing detergents, as they create too much foam.



Use powder detergent for white cotton garments, for pre-washing, and for washing at temperatures over 60°C.



Follow the instructions provided on the detergent packaging.

6- Delaying the end of a program

To set a program to end at a later time, refer to the section "Control Panel / ENDING IN."

7- Start a program

Press the START/PAUSE button ▷||. The corresponding indicator light will turn on, the door will lock, and the DOOR LOCK indicator light 🔒 will be lit.

To avoid overflow, do not open the detergent dispenser once a program is running.

The remaining program duration may vary due to factors such as unbalanced loads or foam formation, which can affect the program duration.

8- Change the settings of a running program if needed

You can still change the settings while a program is running. The changes will be applied, provided the respective program phase has not yet finished.



To change the settings of a running program:

- Press the START/PAUSE button ▷|| to put the running program on pause.
- Change your settings.
- Press the START/PAUSE button ▷|| again to continue the program.

If you have changed the program, do not add detergent for the new program.

To prevent a running program from being changed accidentally (for instance, by children), use the CHILD LOCK function (see section "Control Panel / SPIN").

To pause a running program and open the door if needed:

Press the START/PAUSE button  to pause the program. If the water level and/or temperature in the drum are not too high, the DOOR LOCK indicator light  will turn off, allowing you to open the door. You can then add or remove laundry, such as items mistakenly loaded.

Press the START/PAUSE button  again to resume the program.

9- Cancelling a running program if needed

- Turn the Linear mark on the wash cycle selector knob to the symbol "Ⓛ" to turn off the appliance.
- If the water level and/or temperature are low enough, the door will unlock and can be opened.
- If the door remains locked due to a higher water level in the drum, follow these steps to unlock it: Turn the wash cycle selector knob to select the spin program. Press the SPIN button to turn off the spin program (all spinning speed value indicator lights will go out on the display).
- Press the START/PAUSE button  to run the spin program. The water will be pumped out from the drum during the cycle, and the door will unlock at the end of the program.

10- Switch off the appliance after program end

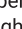
- At the end of the cycle, the message "End" is displayed on the digital display.
- The door can only be opened when the DOOR LOCK indicator light  goes out.
- Check that the DOOR LOCK indicator light is off, then open the door and remove the laundry.

- Turn the Linear mark on the wash cycle selector knob to the symbol "Ⓛ" to turn off the appliance.
- Finally, turn off the tap.

Leave the door ajar to allow the interior of the appliance to dry.

6.12 Cancelling the Programme

The programme is cancelled when programme selection knob is turned to a different programme or machine is turned off and on again using the programme selection knob.



If you turn the programme selection knob when the Child Lock is enabled, the programme will not be cancelled. You should cancel the Child Lock first.

If you want to open the loading door after you have cancelled the programme but it is not possible to open the loading door since the water level in the machine is above the loading door baseline, then turn the Programme Selection knob to Pump+ Spin programme and drain the water in the machine.

6.13 End of Programme

End symbol appears on the display when the programme is completed.

If you do not press any button for 10 minutes, the machine will switch to OFF mode. Display and all indicators are turned off.

Completed programme steps will be displayed if you press any button.

6.14 Standby Mode

Your machine has the "Standby Mode" feature.

After turning the machine on with the On/Off button, if no programme is started or no other action is taken during the selection phase, or if nothing is performed within approximately 2 minutes after the selected programme is over, the machine automatically switches to energy saving

mode. Furthermore, if your product has a display that shows the programme time, this display is completely turned off. If you turn the programme selection button or touch any button, the lights are illuminated, and the screen will turn on again. The choices you make when exiting

the energy saving state may change. Check your selections' accuracy before starting the programme. Adjust your settings again if necessary. This is not an error.

7 Maintenance and Cleaning



Please read the "Safety Instructions" section first!

Service life of your product extends, and frequently experienced problems will be reduced if it is cleaned at regular intervals.

7.1 Cleaning the Detergent Drawer

Clean the detergent drawer at regular intervals (once every 4 to 5 wash) as mentioned below to prevent accumulation of powder detergent.

If there is a buildup of residual detergent or additives, or if the softener compartment is not rinsed out properly, it may be helpful to clean the dispenser.

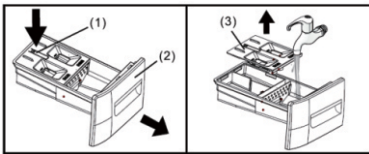

- 1- Open the detergent dispenser tray fully. Press down on the drawer catch (1) and pull the tray (2) out from the appliance housing.
- 2- Remove the liquid detergent cover (3) by grasping it and pulling it upwards from the detergent dispenser tray.
- 3- Clean the liquid detergent cover and the detergent dispenser tray under running water. Lightly wipe away any remaining detergent residue.
- 4- Attach the liquid detergent cover and slide the detergent dispenser tray back into place, ensuring it is securely closed.

- 5- Tip: Do not operate the appliance without the detergent dispenser tray in place. Always keep the tray completely closed.

7.2 Cleaning the Loading Door and the Drum

For products with drum cleaning programme, please see the Operating the product section.



Repeat Drum Cleaning process in every 2 months.

NOTICE: Use an anti-limescale suitable for the washing machines.

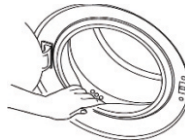

After every washing make sure that no foreign substance is left in the product. If the holes on the door gasket shown in the figure is blocked, open the holes using a toothpick.

Foreign metal substances will cause rust stains in the drum. Clean the stains on the drum surface by using cleaning agents for stainless steel.

Never use steel wool or wire wool. These will damage the painted, chrome coated and plastic surfaces.

We recommend you to wipe the door gasket with a dry and clean cloth at the end of the program. This will remove residues on the door gasket in your machine and prevent formation of malodorous.

7.3 Cleaning the Loading Door and the Drum

Wipe the body of the product with soapy water or non-corrosive mild gel detergents as necessary, and dry with a soft cloth. Use only a soft and damp cloth to clean the control panel. Do not use cleaning products that contain bleach.

7.4 Cleaning the Mesh Filter in the Water Inlet Hose and the Water Inlet Valve

- 1- Close the water tap and unscrew the water inlet hose.

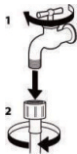

- 2- Clean the mesh filter at the hose's end carefully with a fine brush.



- 3- Now unscrew the water inlet hose on the back of the appliance by hand. Pull out the mesh filter from the water inlet valve on the back of the appliance using pliers and carefully clean it.

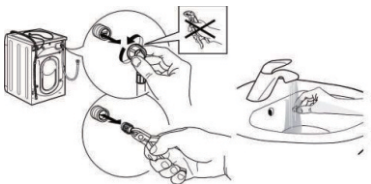

- 4- Insert the mesh filter back into place. Connect the water inlet hose to the water tap and the appliance again. Do not use a tool to tighten the inlet hose. Open the water tap and check that all connections are secure.

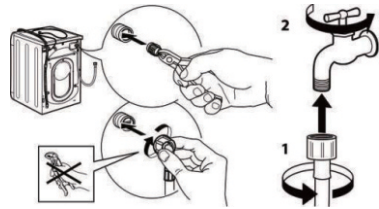

7.5 Cleaning the Mesh Filter in the Water Inlet Hose and the Water Inlet Valve



WARNING

Risk of Scalding

Risk of hot water injury to skin!

You are responsible for ensuring that all safety precautions are followed when draining water from the appliance and/or manually opening the appliance door.

It may be necessary to clean the appliance drain pump if the appliance fails to drain (for example, if you do not hear the sound of water being pumped out when it should be draining, and nearby drains, such as a sink, are functioning properly).

The appliance pump can become blocked by loose debris (which is a good reason to check the drum and remove any visible debris after each load). Fabrics that shed large amounts of fluff may also cause blockages.

To access the appliance's drain pump, the service cover must first be opened (see steps below). With the service cover opened, proceed as follows:

- 1- If the appliance has not been drained, try to drain it now. First, turn the wash cycle selector knob to select the Spin program. Press the SPEED button to turn off the spin program (all spinning speed value indicator lights will go out on the display), then press the START/PAUSE button.

Wait a few moments to allow the pump to drain the water from the drum. If the pump is completely blocked, the water will be unable to drain, and the cycle will end.

- 2- Shut off the tap to prevent any more water from flowing in and needing to be drained. Switch the appliance off and unplug the power plug.
- 3- Open the drain filter cover.



- 4- Use the pull-out drain hose located in the pump access opening to drain the remaining water into a suitable container (up to 5.3 U.S. gallons/20 liters of water may be drained). Pull the sealing cap from the hose and lay the hose over the side of the container to allow the water to finish draining from the drum. When finished, replace the sealing cap back onto the end of the hose and return the hose to its storage location.

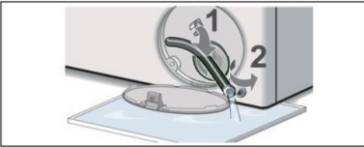

- 5- Turn the pump cover counterclockwise to remove it. A small amount of residual water may flow out when the cover is removed. Clean the interior of the pump housing, removing any debris or foreign objects.

Check to ensure the impeller at the back of the pump housing can turn freely. Remove any lint, debris, or detergent residue from the threads of the pump cover and the pump cover housing. Reinstall the pump cover by screwing it tightly into position, ensuring that the handle is vertical.

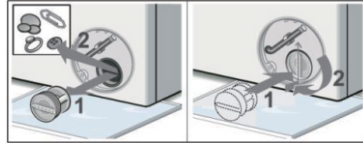

- 6- Close the drain filter cover. Wipe up any spilled water.



8 Troubleshooting

Your appliance may occasionally fail to work. Before contacting the service center, ensure that the problem cannot be resolved easily using the following list:

Problem	Possible Cause / Solutions
There are colour spots and oil stains in drum	<ul style="list-style-type: none"> • The appliance requires a service wash. Run a "Drum clean" wash cycle with no detergent and no laundry.
The machine smells	<ul style="list-style-type: none"> • Due to the use of rubber parts, the machine will have a rubber smell at the beginning of use, but the rubber smell will gradually disappear during use.
The door cannot be opened	<ul style="list-style-type: none"> • The safety protection function is in operation, and the water temperature and/or water level is too high. • Whether the program has ended normally and whether there is power failure. • Is the child lock function activated? Turn off the child lock function. • Whether to select the delay end function? Turn off the delay end function.
The machine leaks from the dispenser	<ul style="list-style-type: none"> • The dispenser drawer is blocked with detergent and requires cleaning. • The water pressure is too high and requires turning down - turn down the tap on the water supply pipe slightly and try again. • The appliance is tilting forward - it must be level when in its final position.
The machine leaks (other than dispenser)	<ul style="list-style-type: none"> • The water inlet hose is loose, check both the cabinet and tap ends. • The inlet hose is tight but still leaks, so replace the rubber washers, or the water inlet hose is missing the rubber washer. • The drain hose is not fixed in properly. • In case of water leakage inside the machine, please turn off the power supply and contact the after-sales department for maintenance.
The machine does not switch on	<ul style="list-style-type: none"> • The appliance is not plugged into the socket fully, or not enough to make contact. • There is no power to the socket, or the fuse has blown in the mains plug.
The wash cycle does not start	<ul style="list-style-type: none"> • The door is not closed properly. • The POWER button has not been pressed. • The START/PAUSE button has not been pressed. • The water tap has not been turned on to allow water to flow into the appliance. • A Delay end function has been set.

Problem	Possible Cause / Solutions
<p>The machine does not fill with water, the detergent cannot flow into the drum or "ddE02" appears in the display</p>	<ul style="list-style-type: none"> • The water inlet hose is kinked, twisted and bent. • The water inlet hose is not connected to the water supply. • The water pressure is too low. • The water tap has not been turned on to allow water to flow into the machine. • There is no water supply to the house. • The mesh filter in the water inlet hose and/or water inlet valve are blocked. • The faucet and/or water supply pipe are frozen. • The delay end function is selected, so the machine does not enter water. • The START/PAUSE button has not been pressed. • There is enough water in the drum already.
<p>Discharge the water when the program is started</p>	<ul style="list-style-type: none"> • This is not a fault. Please do not open the door to pour the water directly into the drum before the program runs, otherwise the machine may discharge the water already poured into the drum.
<p>The water level is too low when the machine is washing</p>	<ul style="list-style-type: none"> • This is not a fault. The water consumption in wash cycle of this appliance is relatively low, as it is designed for lower water usage compared to other washing machines.
<p>Make up water during wash cycle operation</p>	<ul style="list-style-type: none"> • If the water level drops, the machine will make up water automatically. • When the amount of washing clothes is too large, the appliance may make up water automatically several times during the wash cycle.
<p>There is too much foam in drum or foam overflows from detergent dispenser</p>	<ul style="list-style-type: none"> • The detergent is not suitable for machine washing (it should display "for washing machines" or "hand and machine wash" or similar). • Too much detergent was used—less detergent is required in soft water.
<p>The high-speed spinning needs to be repeated many times</p>	<ul style="list-style-type: none"> • Due to the different types and materials of laundry, the load-balancing system of the appliance may wobble and disperse the clothes multiple times to prolong spinning time. This is a normal phenomenon, not a machine failure.
<p>The machine does not spin</p>	<ul style="list-style-type: none"> • The spin speed is turned off by pressing the SPEED button to set all spinning speed values. The indicator light will go out on the display.

Problem	Possible Cause / Solutions
The machine vibrates a lot during the spin cycle	• The feet have not been adjusted, enabling the machine to rock.
	• New installation - either the Transit Bolts, plastic spacer, or the polystyrene packaging have not been removed when installing the machine.
	• The appliance is trapped between cabinets and/or walls.
	• The load is in a slight out-of-balance condition and the appliance is spinning but at a lower speed.
The spin effect is not ideal	• When washing fewer clothes, like a pair of jeans or a sweater, the machine may not complete the spinning process due to balance protection.
	• If the load is in a slight out-of-balance condition, the appliance is spinning, but at a lower speed, not at the default spin speed of the cycle or the spin speed setting.
The machine does not drain, drains slowly, or "E03" appears in the display	• The top of the drain hose is too high - it must be fitted at a height between 65 and 100 cm from the floor.
	• The pump filter is blocked.
	• The drain hose is kinked, twisted, or bent.
	• The drain hose is blocked or frozen.
The program time stops counting down before entering high-speed spinning	• This is not a fault. The load-balancing system wobbles and disperses clothes in the drum for a long time to achieve balance and complete high-speed spinning. During this wobbling process, the program time may stop counting down before entering the high-speed spinning process.
The program takes too long	• Program times will vary due to water pressure, incoming water temperature, and if the wash load goes out of balance. This will increase program times accordingly.
The machine is noisy	• There will always be some motor, pump, and drum noise during spin.
	• The washing machine is touching other objects.
	• Foreign matters, such as hairpins or metal objects, may be in the drum or tub.
The machine continuously fills with water and continually drains away	• The top of the drain hose is too low - it must be fitted at a height between 65 and 100 cm from the floor.
	• The end of the drain hose has been pushed too far down the standpipe; the hose elbow should be fitted 4 inches (100 mm) from the end of the drain hose.
	• The end of the drain hose is submerged in the discharged water.

Problem	Possible Cause / Solutions
The discharged water flows back into the appliance	<ul style="list-style-type: none"> • If the end of the drain hose touches the discharged water (water drained from washer), it can be sucked back into the appliance and may damage the appliance or textiles.
The local part of the control panel is heated	<ul style="list-style-type: none"> • This is the slight heating effect of the electronic components on the computer board on the back of the control panel.
After drying, there are water drops on the door and drum	<ul style="list-style-type: none"> • During drying, the door may be stained with water drops, please wipe off the water drops.
	<ul style="list-style-type: none"> • Do you put in too much or too thick clothes?
The drying effect is poor and uneven	<ul style="list-style-type: none"> • Are clothes that are not easy to dry (such as thick cotton fabrics) and fabric that are easy to dry (such as synthetic fabrics) dried together?
	<ul style="list-style-type: none"> • Do you put too many clothes for drying?
	<ul style="list-style-type: none"> • When only running the "Drying" program, do you separate the dehydrated and entangled clothes by putting them in the drum?
	<ul style="list-style-type: none"> • Due to different types and quantities of clothes, uneven drying may occur. For uneven drying please add regular drying.
	<ul style="list-style-type: none"> • Is the faucet turned off during drying?
	<ul style="list-style-type: none"> • Is the filter of the drain pump blocked during drying?
General	<ul style="list-style-type: none"> • Is the drain hose bent, twisted or blocked during drying?
	<ul style="list-style-type: none"> • Your appliance contains sensors that monitor progress during the wash cycle (e.g.: water level, temperature, out of balance loads, wash time/progress). Normally, if your appliance successfully completes the cycle, there is unlikely to be anything wrong!

In case of the following faults, the microcomputer system will detect the issue, and a buzzer will sound, displaying the corresponding fault codes on the control panel:

Fault codes	Fault type	Possible Cause / Solutions
E02	No inlet water	• Check whether the faucet is turned on? Whether the water supply is cut off?
		• Whether the mesh filter in the water inlet hose and the water inlet valve are blocked?
		• Whether the water inlet hose of the appliance is frozen? Eliminate the above fault causes. If the fault code still exists, please contact the service center for repair.
E03	Abnormal water drainage	• Clean the pump filter.
		• Check whether the drain hose is bent, twisted, or blocked? Eliminate the above fault causes. If the fault code still exists, please contact the service center for repair.
U4	Door lock malfunction	• The door is not closed in place, and the door lock does not work normally. Close the door again, turn the wash cycle selector knob to the "OFF" position to turn off the power supply, and then turn the wash cycle selector knob to select any wash program and press the START/PAUSE button to restart the program. Eliminate this fault cause. If the fault code still exists, please contact the service center for repair.
		• If the fault code displays and cannot open the door, the door lock may be faulty, please contact the service center for repair.
H	The temperature in the drum is high	• Press the START/PAUSE button to suspend the appliance operation and wait for several minutes. When the temperature in the drum drops to a safe range and the fault code on the display is removed, press the START/PAUSE button to continue the rest of the program. If the fault code still exists, please contact the service center for repair.
EXX	Other faults	• Turn the wash cycle selector knob to the "OFF" position to turn off the power supply, unplug the power cord, and contact the service center for repair as soon as possible.



WARNING

Foreign substances left in the pump filter may damage your product or cause noise problems. If you live in areas prone to frost, remember to turn off the water tap, disconnect the main hose, and drain the water from the appliance when it's not in use. After each use, turn off the tap to which the mains hose is connected.!

Not emptying contents from pockets may cause pump or drain hose blockages or may damage the machine. Do not wash items that do not have a wash label, or wash items that are not intended to be machine washable.

9 DISCLAIMER / WARNING

Some (simple) failures can be adequately handled by the end-user without any safety issue or unsafe use arising, provided that they are carried out within the limits and in accordance with the following instructions (see the "Self-Repair" section).

Therefore, unless otherwise authorized in the "Self-Repair" section below, repairs shall be addressed to registered professional repairers in order to avoid safety issues. A registered professional repairer is a professional repairer that has been granted access to the instructions and spare parts list of this product by the manufacturer according to the methods described in legislative acts pursuant to Directive 2009/125/ EC.

However, only the service agent (i.e. authorized professional repairers) that you can reach through the phone number given in the user manual/warranty card or through your authorized dealer may provide service under the guarantee terms. Therefore, please be advised that repairs by professional repairers (who are not authorized by Beko) shall void the guarantee.

Self-Repair

Self-repair can be done by the end-user with regard to the following spare parts: door, door hinge and seals, other seals,

door locking assembly and plastic peripherals such as detergent dispensers (an updated list is also available in support.beko.com as of 1st of March 2021) Moreover, to ensure product safety and to prevent risk of serious injury, the mentioned self-repair shall be done following the instructions in the user manual for self-repair or which are available in support.beko.com For your safety, unplug the product before attempting any self-repair.

Repair and repair attempts by end-users for parts not included in such list and/or not following the instructions in the user manuals for self-repair or which are available in support.beko.com , might give rise to safety issues not attributable to support.beko.com , and will void the warranty of the product.

Therefore, it is highly recommended that end-users refrain from the attempt to carry out repairs falling outside the mentioned list of spare parts, contacting in such cases authorized professional repairers or registered professional repairers. On the contrary, such attempts by end-users may cause safety issues and damage the product and subsequently cause fire, flood, electrocution and serious personal injury to occur.

By way of example, but not limited to, the following repairs must be addressed to authorized professional repairers or registered professional repairers: motor, pump assembly, main board, motor board, display board, heaters etc.

The manufacturer/seller cannot be held liable in any case where end-users do not comply with the above

The spare part availability of the washing machine or washer-dryer that you purchased is 10 years. During this period, original spare parts will be available to operate the washing machine or washer-dryer properly.