

27 INCH COUNTER DEPTH BOTTOM-FREEZER REFRIGERATOR

BFBF2715GSIM / BFBF2715SSIM



Fridge Features

NeoFrost dual cooling technology
ProSmart Inverter Compressor
ENERGY STAR® certified
Zone temperature adjustability
Inner digital display
Interior theatre lighting with LED lights
Field reversibility of doors
Counter Depth Design
Finger print free stainless steel

Freezer Features

Automatic ice maker
2 freezer drawers

Dimensions

H x W x D: 75 1/4" x 27 9/16 x 26 5/8"
Depth is with door / without handles

MODEL CODE	BFBF2715GSIM / BFBF2715SSIM
Cooling system	Duo Cycle Frost Free Cooling - NeoFrost
Control system	Electronic Control
CAPACITIES	
Total net volume, cu. ft.	16.39
Fresh food net volume, cu. ft.	11.68
Freezer net volume, cu. ft.	4.71
FRIDGE FEATURES	
Active Fresh Blue Light	No
EverFresh	No
IonGuard	No
Interior filtered water dispenser	No
Filtered ice & water dispenser through door	No
Electronic control display type	Digital inner display
Auto defrost	Yes
Inner illumination	LED - Side walls
Shelves	4
Crispers	1
Door racks	4
Wine rack	Yes
Bottle gripper	No
Compressor	Variable Speed VCC
Fan ventilation	Yes
FREEZER FEATURES	
Auto defrost	Yes
Number of freezer drawers	2
Automatic ice maker	Yes
Ice cube tray	No
TECHNICAL INFORMATION	
Supply voltage, V/Hz	120V/ 60Hz
Rated Current, A	2.4
Noise level, dBA	47
DIMENSIONS	
HxWxD, in	75 1/4" x 27 9/16 x 26 5/8"
Product weight, lbs.	182
HxWxD, cm	191 x 70 x 67.6
Product weight, kg	83
PERFORMANCE	
Energy Star qualified	Yes
Climatic class	T
Annual energy consumption, kwh/year	445
Cooling gas	R600a
COLOR OPTIONS	
Stainless Steel	BFBF2715SSIM
Black Glass	BFBF2715GSIM

27 INCH COUNTER DEPTH BOTTOM-FREEZER REFRIGERATOR

BFBF2715GSIM / BFBF2715SSIM

Outstanding Features



NeoFrost Dual Cooling Technology

Between unloading the grocery bags and getting ready to prepare a meal, you probably don't spend a lot of time thinking about the food in your refrigerator or freezer. And that's okay, because here at Beko, we do. That's why we've developed our NeoFrost dual cooling technology to ensure your food stays fresher, longer.

Unlike conventional single cooling systems, NeoFrost cools twice as fast with two separate cooling systems that maintain optimal humidity in the fridge, while keeping the freezer dry and frost-free.



ProSmart Inverter Compressor

The kitchen is a gathering place for your family. It's where plans are made and stories are shared. We've engineered the ProSmart inverter compressor to make sure our refrigerator never interrupts the conversation. As a matter of fact, the ProSmart compressor runs four times quieter than other refrigerator compressors. And the energy-efficient ProSmart compressor also meticulously maintains a consistent temperature to keep food fresher, longer.



Automatic Ice Maker

Beko Automatic Ice Maker can generate 6 pounds of ice per day avoiding the need to fill old fashioned ice trays by hand.



Zone Temperature Adjustability

High-tech temperature controls provide precise adjustability for preserving your food.

Inner Digital Display

Easy-to-read inner digital display allows you to quickly adjust your cooling and freezing settings

27 INCH COUNTER DEPTH BOTTOM-FREEZER REFRIGERATOR

BFBF2715GSIM / BFBF2715SSIM

Dimensions and Installation

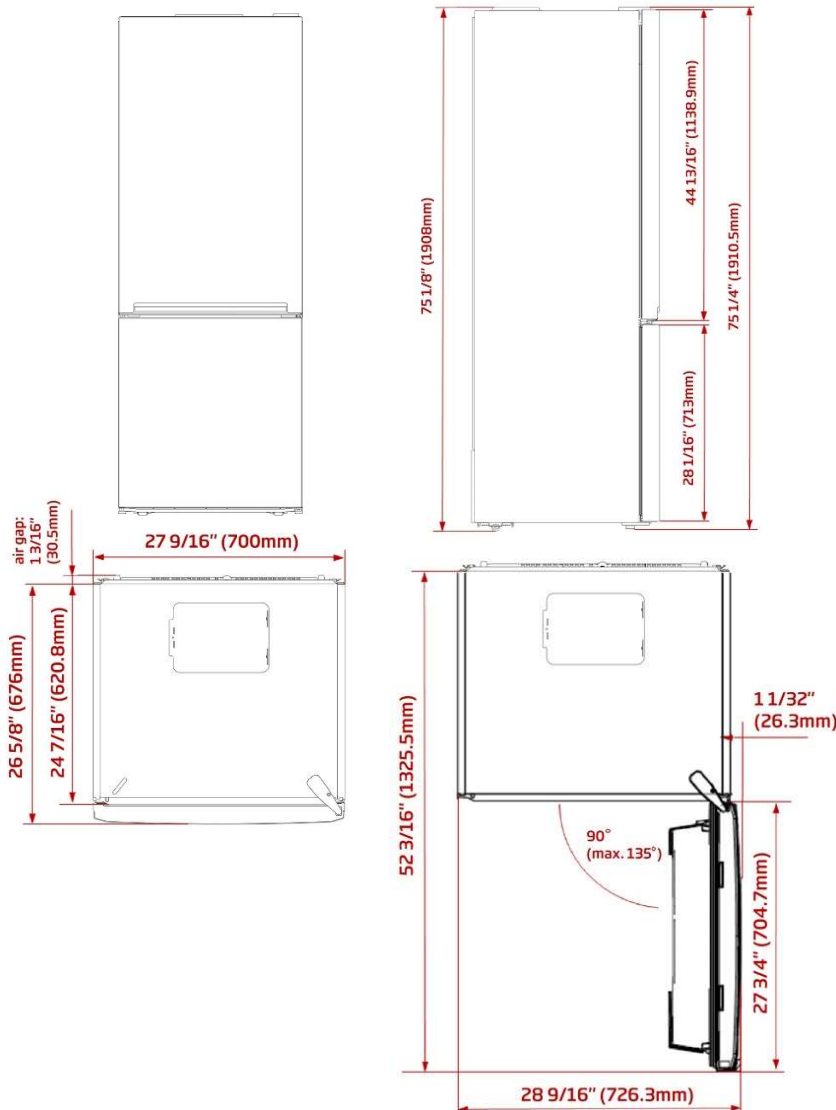

Plumbing

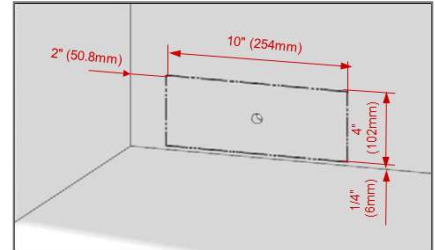

Electrical

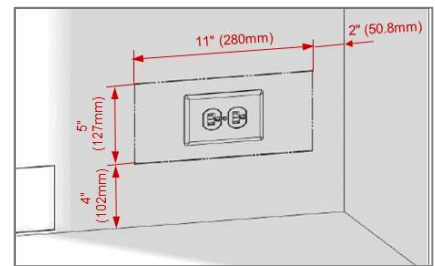

Dimensions	Height to top of door, in.	74 3/4"
	Height to top of hinge, in.	75 1/4"
	Height to top of case, in.	75 1/8"
	Case depth without door, in.	24 7/16"
	Case depth with door, in.	26 5/8"
	Depth with fresh door open 90°, in.	52 3/16"
	Width, in.	27 9/16"
	Width with door open 90° including door, in.	28 9/16"
Air Gap Clearances	Each Side, in.	1/8"
	Top, in.	1"
	Back, in.	1 3/16"

NOTE TO THE INSTALLER: All height, width and depth dimensions are shown in inches (as well as metric). Beko US Inc. reserves the absolute and unrestricted right to change product materials and specifications, at any time, without notice. Please visit our website www.blombergappliances.us or call 888 352 2356 to verify the latest specifications with final dimensional data and other details prior to installation and making a cutout. Applicable product limited warranty information may be found in accompanying product materials or you may contact your account manager for further details. Proper installation is the responsibility of the installer. Product failure due to improper installation is not covered under the Limited Warranty.